

REVISIONS

ZONE	LTR	DESCRIPTION	DATE	E.M.N.O.	DRAFT	CHKD	APPD
	X	EXPERIMENTAL RELEASE	8/28/58		C.V.		
	Ø	ORIG ORIGINAL RELEASE	9-20-58		MC		FB

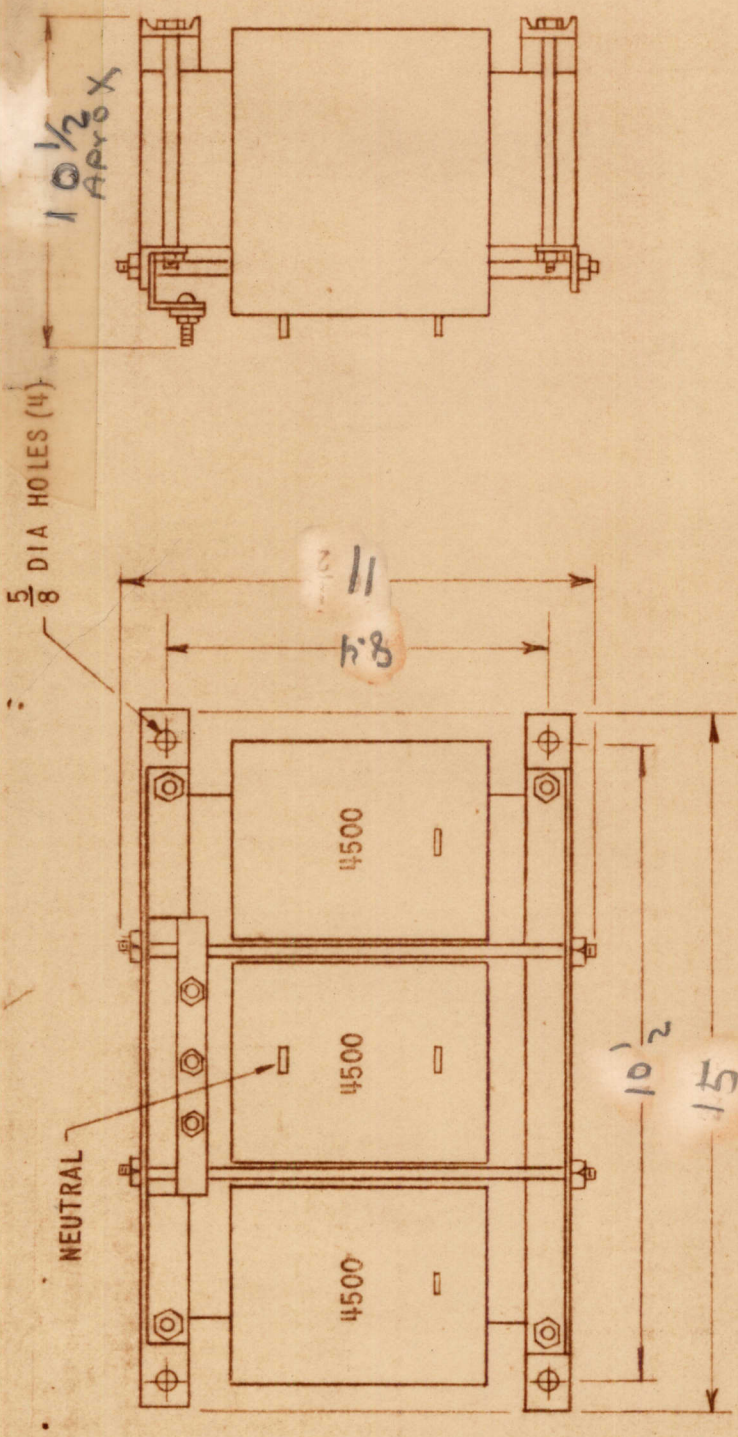

SPECIFICATIONS

ELECTRICAL:
 PRIMARY: 208 VAC 3Ø 400CPS
 INSULATION TEST VOLTAGE: 15 KV
 SECONDARY: 10 K VDC @ 1/4 FROM 3Ø FWB

MECHANICAL:

CASE: OPEN FRAME
 FINISH: TMC SPEC S115 SMOOTH GRAY ENAMEL
 DIMENSIONS: SHOWN PICTORIALY
 TERMINALS:
 PRIMARY: LUGS
 SECONDARY: SOLDER TERM

MARKING:

- A. SCHEMATIC AND TMC IDENTIFICATION TO BE MARKED ON TOP OF TRANSFORMER.
- B. MARKING TO BE AS PER TMC S727.
- C. LETTER AND NUMERALS TO BE GOTHIC ALL MARKING TO BE IN BLACK.

NOTE: MANUFACTURED IN ACCORDANCE WITH MIL-SPEC T-27-A EXCEPT THAT MIL-SPEC T-27-A SHALL NOT APPEAR ON CASE AND QUALIFICATION TESTING NOT REQUIRED.

TO BE MARKED ON TOP OF TRANSFORMER

THE TECHNICAL MATERIEL CORPORATION
 MAMARONECK
 NEW YORK

TF 440

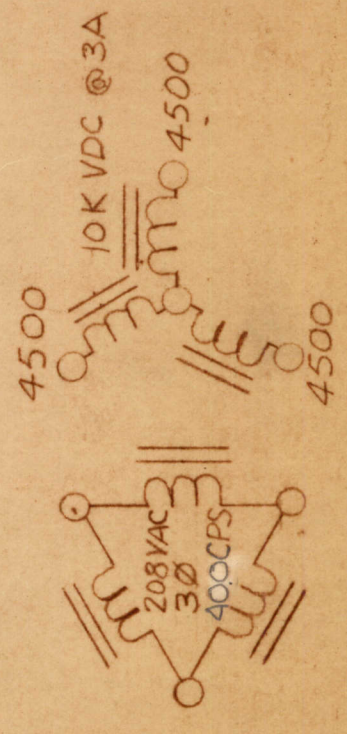

REQ'D ITEM	PART NUMBER	DESCRIPTION	SYM.
F. BUDETTI			
FINAL APPROVAL	DATE	LIST OF MATERIAL	
MECH DES	DATE	THE TECHNICAL MATERIEL CORP. MAMARONECK, NEW YORK	
ELECT. DES	DATE	TRANSFORMER, POWER STEP-UP	
CHECKED	DATE	SIZE	CODE IDENT. NO. DWG NO. ISSUE
DRAWN	DATE	B	82679 TF 440 Ø
MATERIAL		SCALE	SHEET OF
FINISH		2	1

UNLESS OTHERWISE SPECIFIED DIMENSIONS ARE IN INCHES AND INCLUDE CHEMICALLY APPLIED OR PLATED FINISHES

DECIMALS
 X ± .05
 .XX ± .01
 XXX ± .005

FRACTIONS
 1/64
 ANGLES
 0°-30°

QTY / UNIT	MODEL USED ON	ASSY NO.
1	BCT-10KA	
APPLICATION		
CODE S401-307900		

NOTICE TO PERSONS RECEIVING THIS DRAWING
 THE TECHNICAL MATERIEL CORPORATION claims proprietary right in the material disclosed hereon. This drawing is issued in confidence for engineering information only and may not be reproduced or used to manufacture anything shown hereon without permission from THE TECHNICAL MATERIEL CORPORATION to the user. This drawing is loaned for mutual assistance and is subject to recall at any time.