

IF IT IS FOUND DESIRABLE TO CHANGE ANY TOLERANCE OR OTHER DETAIL SPECIFIED ON THIS DRAWING NOTIFY THE PURCHASER PROMPTLY.

TE-143 A

MAXIMUM ALLOWABLE TOLERANCES HAVE BEEN DETERMINED AND DEVIATIONS WILL BE CAUSE FOR REJECTION. REMOVE ALL BURRS AND SHARP EDGES

STANDARD DRAWING

REQ. PER UNIT	USED ON			
	MODEL	PROJECT NO.	ASS'Y. NO.	DATE
3	RAC	112		10/13/54
4	RAC-12		A-990	4/15/55
4	RAC-7A			10/30/56

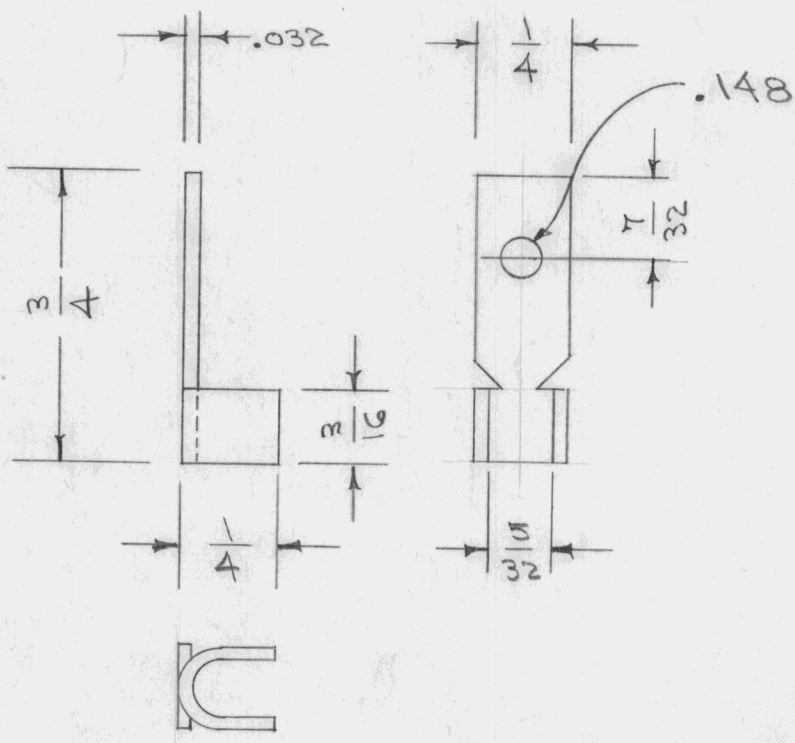

REF. ZIERICK MFG. CO. No. 407

REQ.	ITEM	PART NO.	DESCRIPTION	SYMBOL
			THE TECHNICAL MATERIEL CORP. MAMARONECK, NEW YORK	
STOCK SIZE			TERMINAL, KNIFE	
COPPER				
MATERIAL		WEIGHT PER PC.		
			COR. 6-21-55	
TYPE & TEMPER			DRAWN <i>WJL</i>	
			ELEC. DES. APP. MECH. DES. APP.	
HEAT TREAT. SPEC.			CHECKED <i>WJL</i> FINAL APPROVAL <i>WJL</i>	
HOT TINNED				
FINISH & SPEC. NO.			TE-143 A	

A	1	COMPLETE REVISION	6/21/55	1	CSO	JAL	WJL
ISSUE	ITEM	CHANGED FROM	DATE	CN. NO.	DRAFTS	CHECKER	ENG. APP.
TOLERANCES			SCALE				
ALL OTHERS			DRILL, PUNCH, COMMERCIAL STOCK SIZES AND MANUFACTURERS TOLERANCES ARE NOT INCLUDED.				