

NOTE:

TRANSMITTING ANTENNAS ARE 3-WIRE  
 TYPE FDA-290 FOLDED DIPOLES AS  
 SHOWN ON DRAWING NO. 775, LESS  
 TRYLON TOWERS.  
 INPUT IMPEDANCE IS 600 OHMS  
 RATED POWER CAPABILITY 50 KW  
 SUPPORTS- CREOSOTED WOODEN  
 POLES SUCH THAT THE ANTENNA  
 HEIGHT ABOVE AVERAGE GROUND  
 LEVEL IS 60 FT.

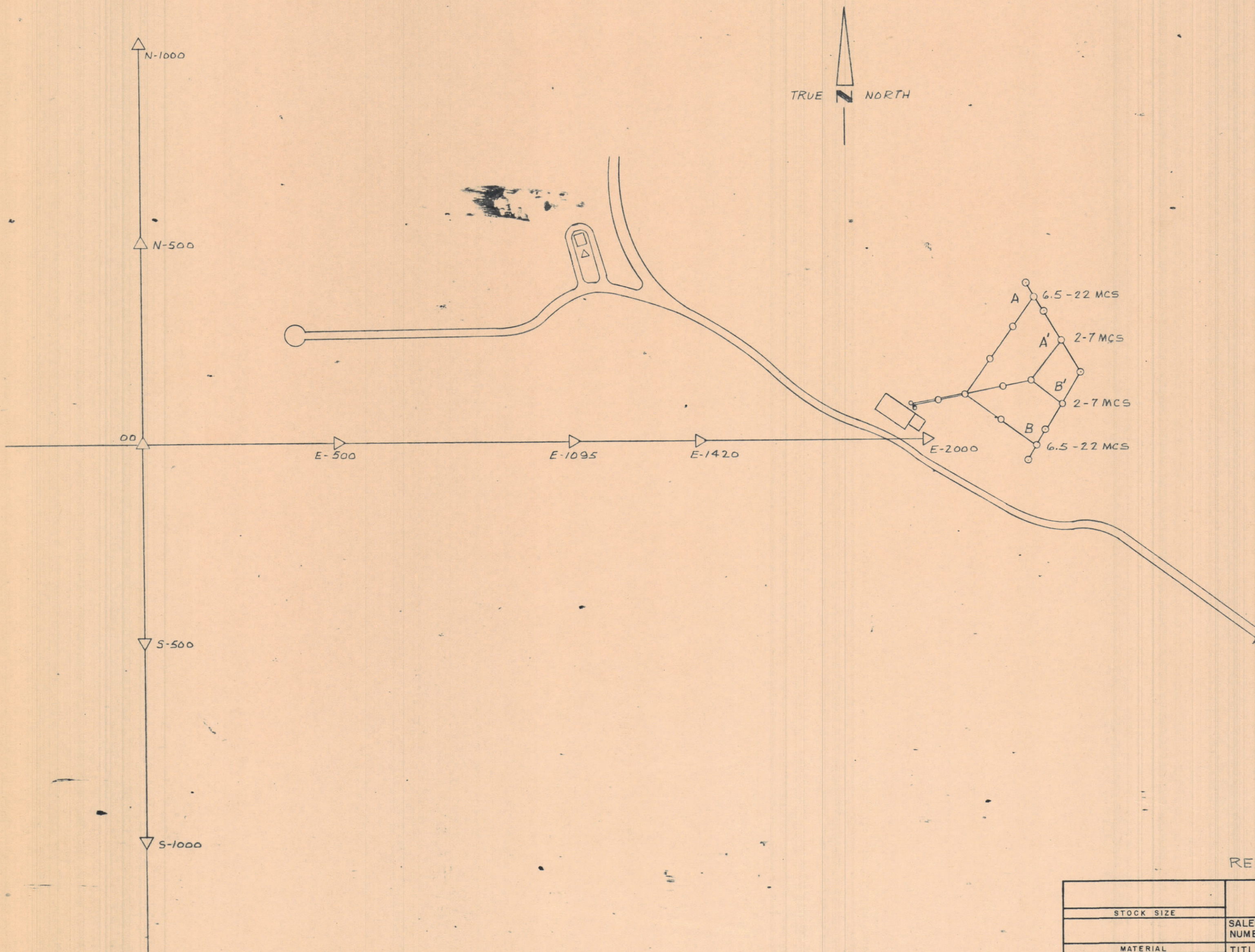

SY-1091	
SYSTEM DWG. NO.	NO. OF SH.

FOR SALES USE ONLY NOT FOR MANUFACTURING

*OUT TO VIRGINIA*

AUG 7 1962

REFERENCE DWG 60-02-01 SHEET 3A

STOCK SIZE		THE TECHNICAL MATERIEL CORP. MAMARONECK, NEW YORK SYSTEMS DEPARTMENT			
MATERIAL		SALES ORDER NUMBER C-10347	PROPOSAL NUMBER	QR NUMBER	
TYPE & TEMPER HEAT TREAT. SPEC.		TITLE: PROPOSED LOCATION OF TRANSMITTING ANTENNAS			
FINISH & SPEC NO.		MJT	6-7-60	F.O.S.	SY-1091-2
		DRAWN BY	DATE	FINAL APPROVAL	SYSTEM DWG. NO. NO. OF SH.