

REQ. PER. UNIT	USED ON		DATE
	MODEL	ASSY. NO.	10-14-1960
1	PS-4	CB 303	SW 262

— 6-32 THD. — 5/32 DEEP
INSERTS

— 10-32 STUD

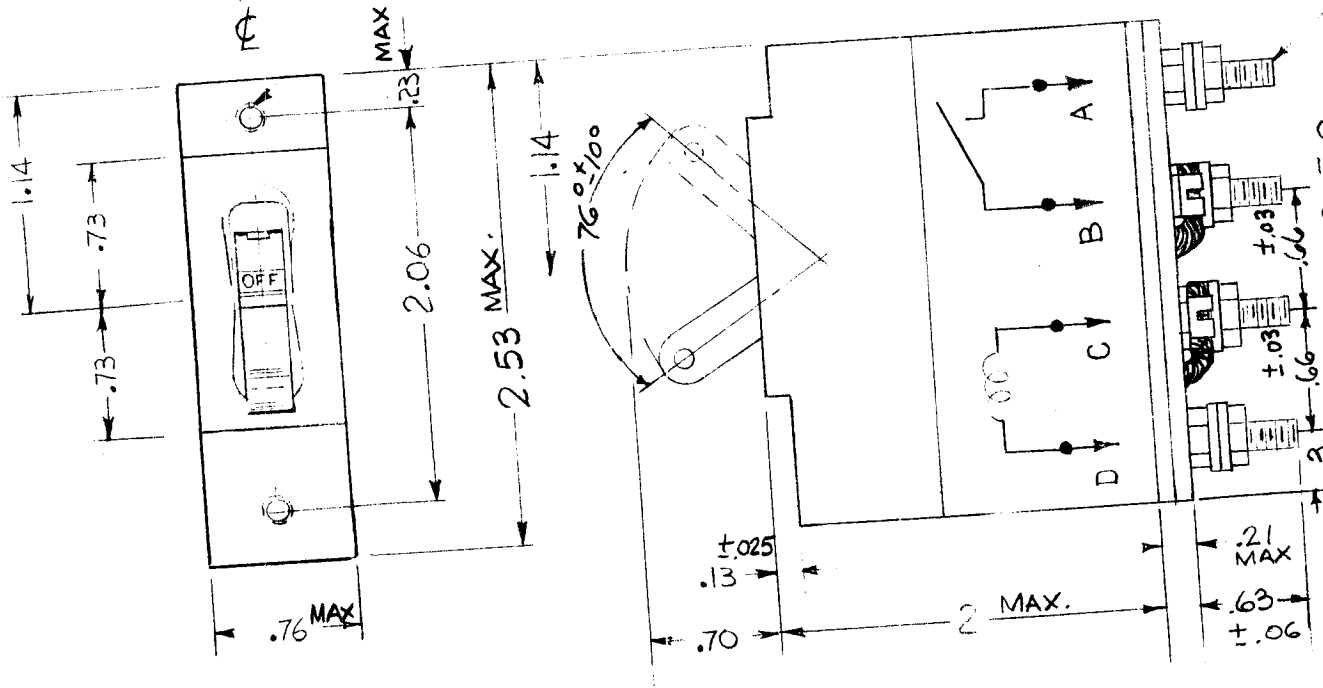

CONTACT AMPERE RATING:
15 AMPS. AC, 50/60 CPS, 250V
COIL (SEPARATE TERMINALS)
.06 AMPS. DC
INSULATION 1500V
RIPPLE: 1%
DELAY CURVE - 5

S401-450 (APL 5-DC-0.06A-DB1)
S401-53 (PAM 12 RSKMG6)

						DESCRIPTION		SYMBOL
						THE TECHNICAL MATERIEL CORP. MAMARONECK, NEW YORK		
						CIRCUIT BREAKER		
REQ.	ITEM	PART NO.		STOCK SIZE		MATERIAL		
E3	TOL. ADDED, 2.53 WAS 2 1/2	9.11.67	18399	H.G.	<i>EFM</i>	DRAWN		FINAL APPROVAL SW 262 B
A	DELE. "ON", "OFF" & ARROWS • REV. DIMS. ADD. TOL ± 0.1 ± 1/64	8-9-66	16737	RME	<i>CK</i>	CHECKED		
ISSUE ITEM	CHANGED FROM	DATE	CH. NO.	DRAFTS	CHECKER	ENG. APP.		
TOLERANCES		SCALE:		TYPE & TEMPER		HEATTREAT. SPEC.	ELEC. DES. APP MECH. DES. APP	
DEC. DIM. ± 0.1 FRAC. DIM. ± 1/64 ANGULAR DIM. ±		MAXIMUM ALLOWABLE TOLERANCES HAVE BEEN DETERMINED AND ANY DEVIATIONS WILL BE CAUSE FOR REJECTION. REMOVE ALL BURRS AND SHARP EDGES		FINISH & SPEC. NO.				