

RW-116

OHMS	CURRENT (MA)	OHMS	CURRENT (MA)
1	14140	3000	260
2	10000	3500	240
3	8162	4000	225
4	7070	4500	210
5	6325	5000	200
10	4470	7500	163
25	2825	10000	141
50	2000	15000	115
75	1630	20000	100
100	1414	25000	90
150	1150	30000	82
250	900	35000	76
500	632	40000	71
750	515	50000	63
1000	447	60000	58
1500	365	75000	52
2000	315	100000	45
2500	282		

STANDARD DRAWING

MOUNTING BRACKETS FURNISHED BY
WARD LEONARD AT NO ADDITIONAL
COST ONLY WHEN SO SPECIFIED ON ORDER.
W.L. No. 815
WIDTH - 1/2 INCH.
HOLE DIA - 0.187
CORE TYPE - D

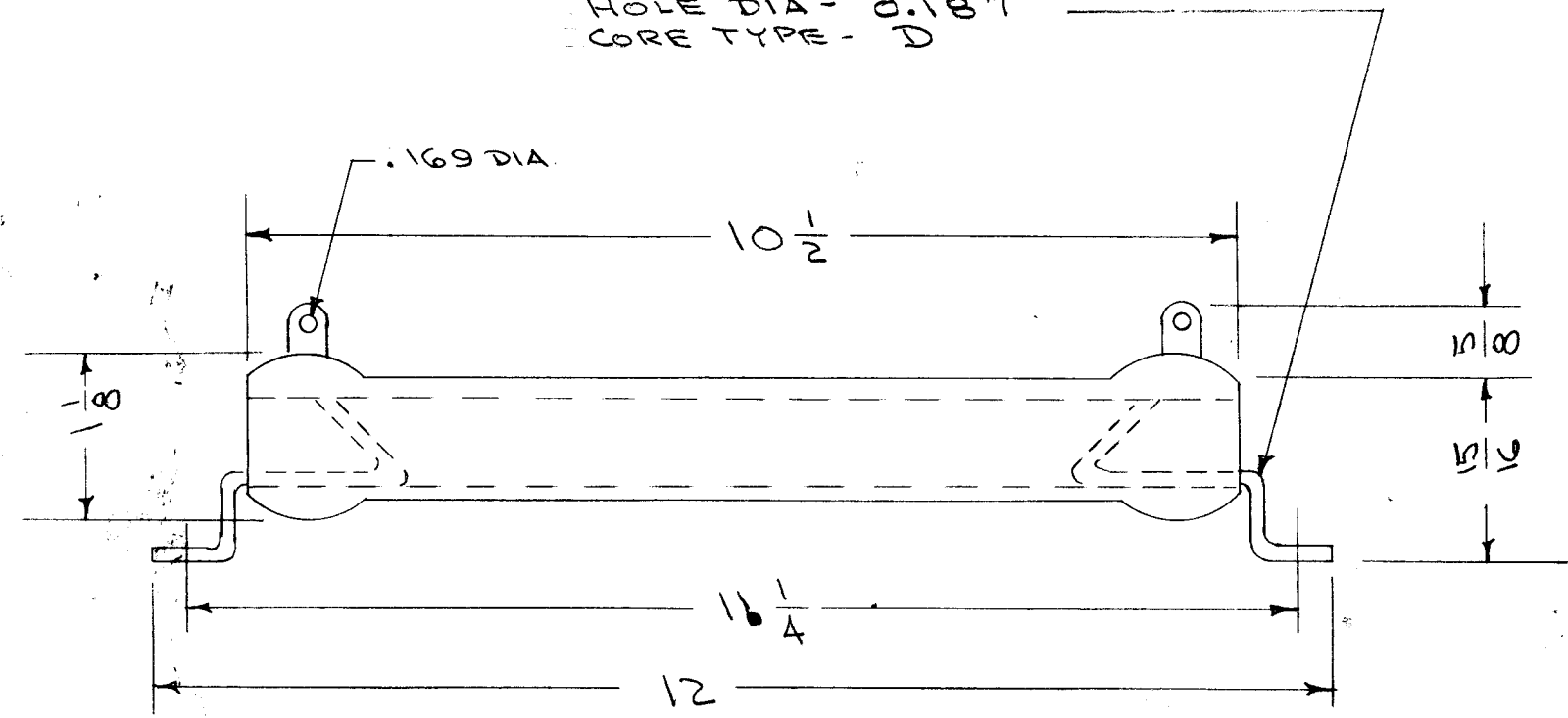

TYPE DESIGNATION TO BE IN FOLLOWING FORM

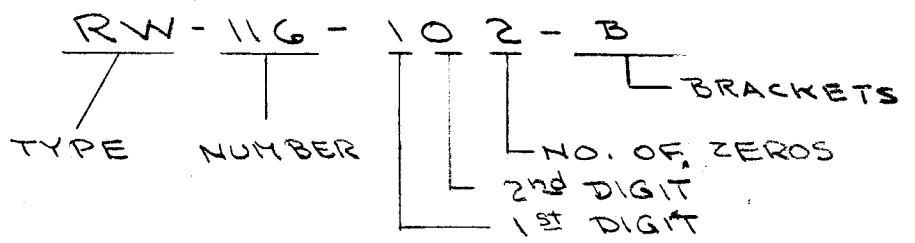

B = BRACKETS
NB = NO BRACKETS

LETTER "R" IF USED SHALL INDICATE
DECIMAL POINT

1R00 = 1 OHM
102 = 1000 OHMS

(NOTE - For Bolt Mtg. - See Dwg. P0-138)

REF: WARD LEONARD ELEC. CO. No. 200 F

ISSUE	ITEM	CHANGED FROM	DATE	CH. NO.	DRAFTS	CHECKER	ENG. APP.

TOLERANCES: SCALE:

DEC. DIM. ± MAXIMUM ALLOWABLE TOLERANCES HAVE
FRAC. DIM. ± BEEN DETERMINED AND ANY DEVIATIONS
ANGULAR DIM. ± WILL BE CAUSE FOR REJECTION.
REMOVE ALL BURRS AND SHARP EDGES

REQ. PER UNIT	MODEL	PROJECT NO.	ASS'Y. NO.	DATE	USED ON

REQ. ITEM	PART NO.	DESCRIPTION	SYMBOL
THE TECHNICAL MATERIEL CORP. MAMARONECK, NEW YORK			
RESISTOR, FIXED W.W. 206 WATT			
		CDD.8/29/55	A.J.J.