

PX866

REVISIONS

SYM	DESCRIPTION	DATE	E.M.N. NO.	DRAFT	CHKD	APPD
X	EXPERIMENTAL RELEASE	11-12-64	X	SRG		
Ø	ORIGINAL RELEASE FOR PRODUCTION	12-15-64	Ø	RL		

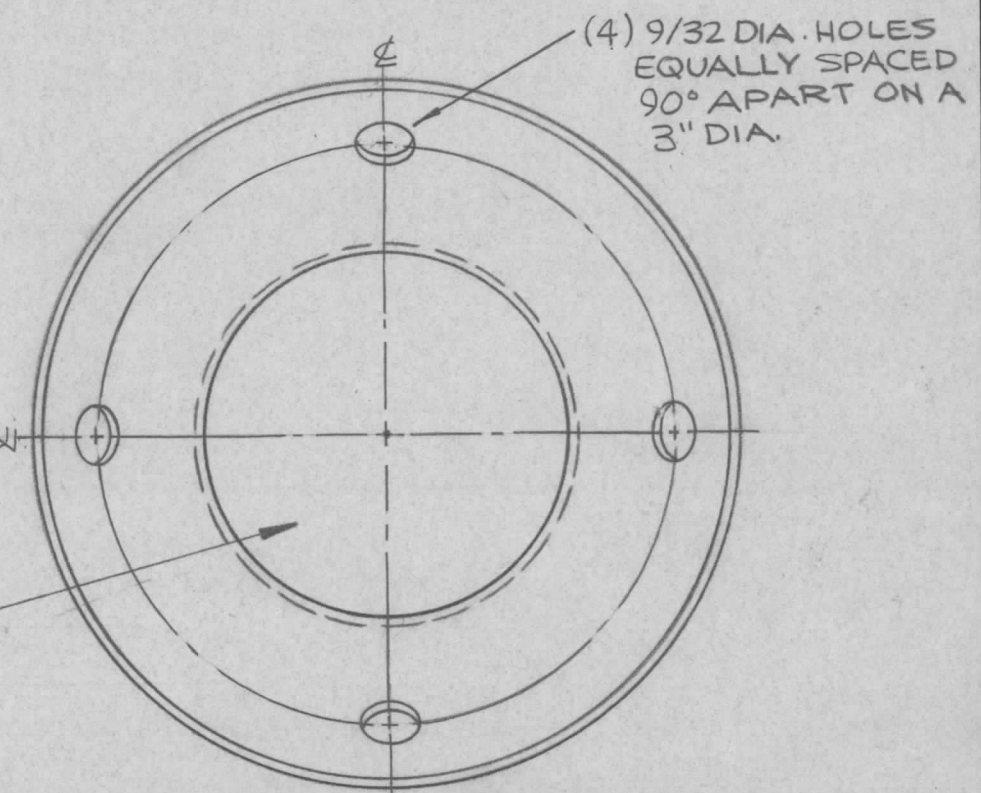
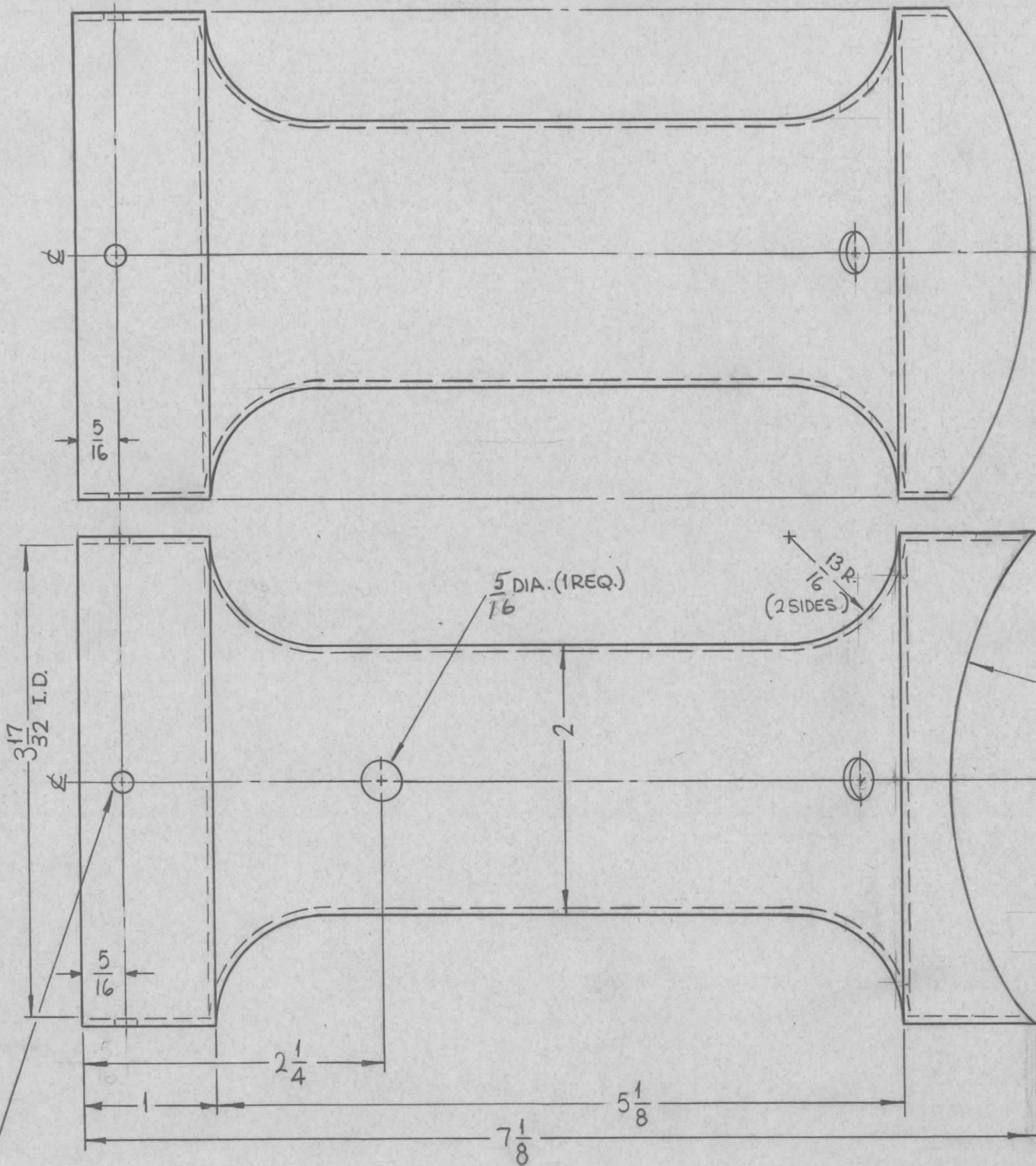

STAMP TMC P/N  
 $\frac{1}{8}$  HIGH GOTHIC

(4)  $5/32$  DIA. HOLES EQUALLY SPACED  $90^\circ$  APART.

REQ'D.	ITEM	PART NUMBER	DESCRIPTION	SYMBOL
	Ø POSE			
MATERIAL			LIST OF MATERIAL	
4 LAYERS 83 V.P. 2 PLY FIBERGLASS ( $3/32$ THK, REF. ONLY)			THE TECHNICAL MATERIEL CORP. MAMARONECK, NEW YORK	
FINISH			TITLE	
S756 GREY SYNTHETIC ENAMEL			SUPPORT, ANTENNA	
UNLESS OTHERWISE SPECIFIED DIMENSIONS ARE IN INCHES AND INCLUDE CHEMICALLY APPLIED OR PLATED FINISHES			DRAWN	DATE
			SRG	11-12-64
			CHECKED	DATE
				12-15-64
			ELECT. DES.	DATE
				12-15-64
			MECH. DES.	DATE
			M. Haffner	11-24-64
DECIMALS			FRACTIONS	
.X ± .05			± 1/64	
.XX ± .01			ANGLES	
.XXX ± .005			± 0° 30'	
TOLERANCES			SHEET	
			Ø	
			REV. LTR.	

1	LFRA-1	A3988
Q'TY./UNIT	MODEL USED ON	ASS'Y. NO.
SCALE	CODE	
1:1	A	

THE CONTENTS OF THIS DRAWING ARE THE EXCLUSIVE PROPERTY OF THE TECHNICAL MATERIEL CORP. ITS UNAUTHORIZED USE OR REPRODUCTION IN WHOLE OR IN PART IS STRICTLY FORBIDDEN.

NOTES