

PX-364 C

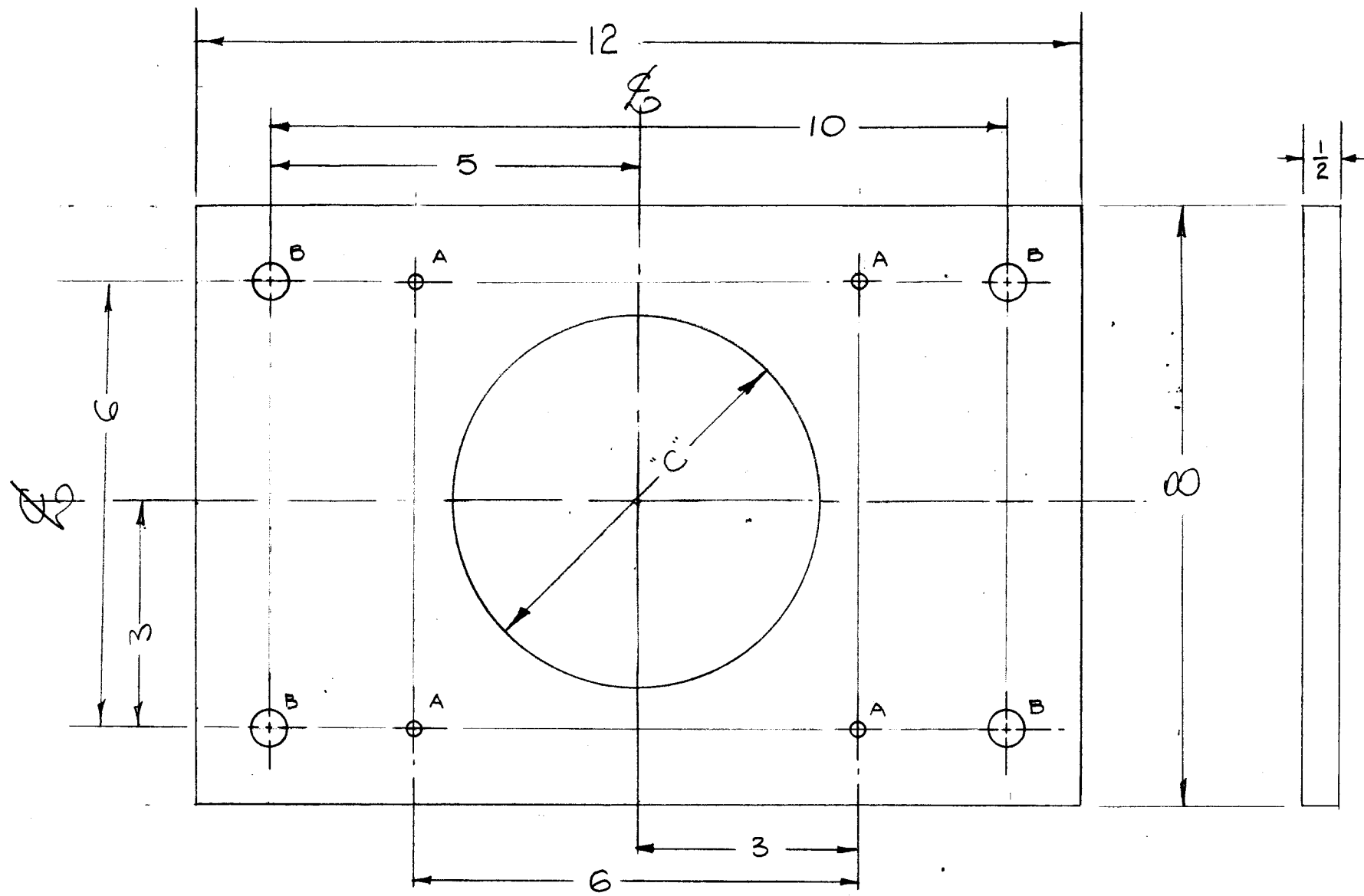

A - $\frac{13}{64}$ " ϕ 4 Holes Req.
 B - $\frac{3}{8}$ " ϕ 4 Holes Req.

TMC NO.	"C" HOLE DIA.	USED ON	QUAN.
PX-364-1	5 $\frac{5}{32}$	TER-5000-600	4
PX-364-2	5 $\frac{3}{16}$	TER-5000-70	2

NOTE - Lacquer all edges exposed by machining & cutting.
 S-113 Fungus Resistant Varnish

ISSUE	ITEM	CHANGED FROM	DATE	CH. NO.	DRAFTS	CHECKER	ENG. APP.
C	1	B WAS $\frac{1}{2}$ DIA.	1-15-62	6126	EH	PH	QPS
B	1	-2 Added to chart. model & quan Added.	2/1/59	-	16	file	T.G.
A	1	"C" Hole Dia. Was 5"	7-26-57	1	sc.	file	AWP

TOLERANCES: DEC. DIM. \pm , FRAC. DIM. \pm $\frac{1}{64}$, ANGULAR DIM. \pm

SCALE: MAXIMUM ALLOWABLE TOLERANCES HAVE BEEN DETERMINED AND ANY DEVIATIONS WILL BE CAUSE FOR REJECTION. REMOVE ALL BURRS AND SHARP EDGES

CHART	TER-5000-70	2A-1634	1-26-59
CHART	TER-5000-600	A-1431 (8)	4-23-57
REQ. PER UNIT	MODEL	PROJECT NO.	ASS'Y. NO.
			DATE

USED ON

REQ. ITEM	PART NO.	DESCRIPTION	SYMBOL
$\frac{1}{2}$	THICK	THE TECHNICAL MATERIEL CORP.	
	STOCK SIZE	MAMARONECK, NEW YORK	
	PHENOLIC	PRESSURE PLATE	
		(INSIDE)	
LE		4-23-57	16
TYPE & TEMPER	HEAT TREAT. SPEC.	DRAWN	CHECKED
NATURAL			T.G.
SEE NOTE			PX-364 C
FINISH & SPEC. NO.		ELEC. DES. APP.	MECH. DES. APP.