

REQ. PER UNIT	USED ON		PX-324	C
	MODEL	ASS'Y. NO.		
1	RTF		8-23-56	
1	RTF-2	P/A	10-29-58	

A - 1/8 (.125) DIA 4 HOLES
 B - 3/16 (.187) " 1 "
 C - 25/64 (.390) " 1 "

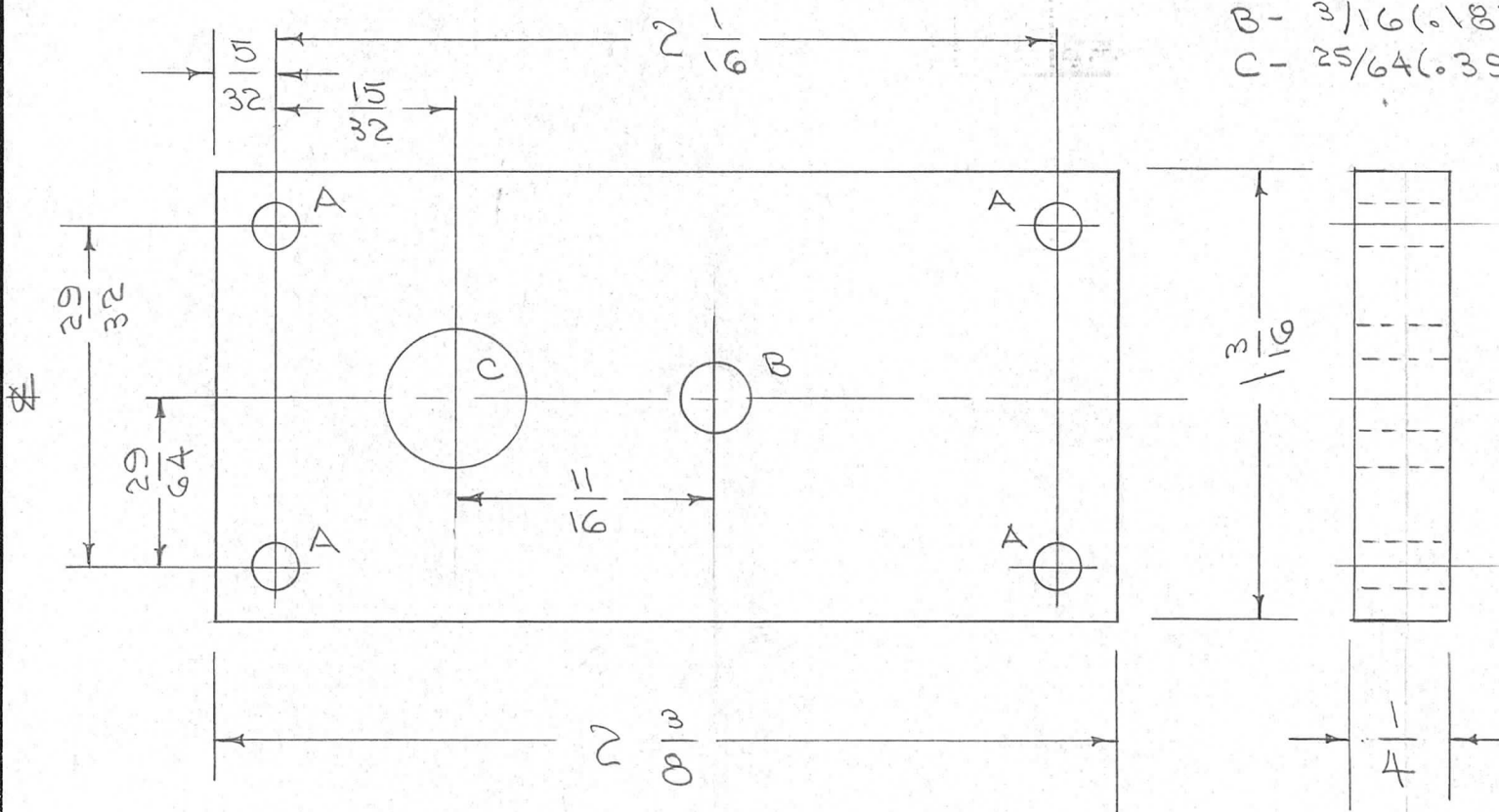

* FUNGUS PROOFING PER
 TMC SPECIFICATION S-113

REQ.	ITEM	PART NO.	DESCRIPTION				SYMBOL					
C		S113 ADDED	4-13-64	11186	AM.	<i>file</i>	<i>923</i>	1/4 THICK	THE TECHNICAL MATERIEL CORP. MAMARONECK, NEW YORK			
B	1	MATL WAS TEFLON	10/29/58	*	<i>use</i>	<i>file</i>	<i>116</i>	STOCK SIZE	MTG. PLATE, NEUTRALIZER			
A	1	REDRAWN COMPLETE REVISION	8/23/56	1	<i>OOD</i>	<i>file</i>	<i>116</i>	MATERIAL	P/A RTF			
ISSUE	ITEM	CHANGED FROM	DATE	CH. NO.	DRAFTS	CHECKER	ENG. APP.					
TOLERANCES			SCALE:									
DEC. DIM. ±			MAXIMUM ALLOWABLE TOLERANCES HAVE BEEN DETERMINED AND ANY DEVIATIONS WILL BE CAUSE FOR REJECTION.									
FRAC. DIM. ±			REMOVE ALL BURRS AND SHARP EDGES									
ANGULAR DIM. ±												
								LE		<i>OOD 8/23/56</i>	<i>file</i>	<i>116</i>
								TYPE & TEMPER	HEAT TREAT. SPEC.	DRAWN	CHECKED	FINAL APPROVAL
								NATURAL *				PX-324
								FINISH & SPEC. NO.	ELEC. DES. APP.	MECH. DES. APP.		C