

APPLICATION			REVISIONS						
QTY	MODEL USED ON	ASS'Y NO.	LTR	DESCRIPTION	DATE	E.M.N.NO	DRAFT	CHKD	APPD

2 TRC-20W AS880

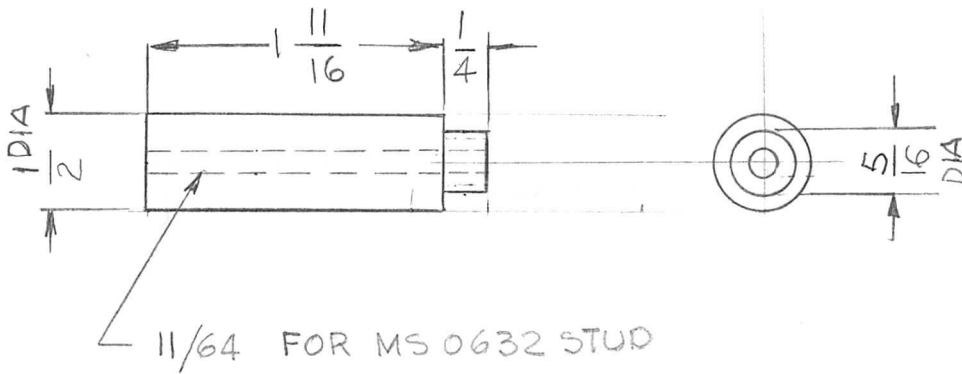

<small>UNLESS OTHERWISE SPECIFIED DIMENSIONS ARE IN INCHES AND INCLUDE CHEMICALLY APPLIED OR PLATED FINISHES</small> <small>DECIMALS .X ± .05 .XX ± .01 .XXX ± .005</small> <small>FRACTIONS 1/64 ANGLES 0°-30'</small> <small>TOLS.</small>	REQ'D	ITEM	PART NUMBER	DESCRIPTION	SYM.
	LIST OF MATERIAL				
MATERIAL 1/2 ROD EPOXY	FINAL APPROVAL <i>GB</i>		DATE 7/7/92	<b>THE TECHNICAL MATERIEL CORP.</b> MAMARONECK, NEW YORK  HOLDER CONTACT	
FINISH	MECH. DES.	DATE			
	ELECT. DES.	DATE			
	CHECKED	DATE			
	DRAWN G.D.L.	DATE 3-4-92			

<small>NOTICE TO PERSONS RECEIVING THIS DRAWING</small> <small>THE TECHNICAL MATERIEL CORPORATION claims proprietary right in the material disclosed hereon. This drawing is issued in confidence for engineering information only and may not be reproduced or used to manufacture anything shown hereon without permission from THE TECHNICAL MATERIEL CORPORATION to the user. This drawing is loaned for mutual assistance and is subject to recall at any time.</small>	SIZE A	CODE IDENT. NO. 82679	DWG NO. PX 1310	ISSUE
	SCALE 1:1	SHEET OF		