

IF IT IS FOUND DESIRABLE TO CHANGE ANY TOLERANCE OR OTHER DETAIL SPECIFIED ON THIS DRAWING NOTIFY THE PURCHASER PROMPTLY.

PO-124

MAXIMUM ALLOWABLE TOLERANCES HAVE BEEN DETERMINED AND DEVIATIONS WILL BE CAUSE FOR REJECTION. REMOVE ALL BURRS AND SHARP EDGES

PREP. UNIT

USED ON

MODEL	PROJECT NO.	ASS'Y. NO.	DATE
15 KS-85-X	J-227		8-20-53

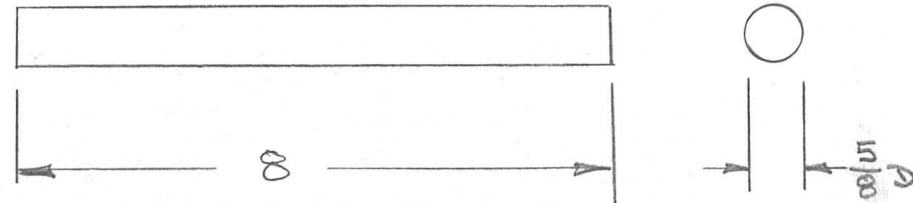

REQ.	ITEM	PART NO.	DESCRIPTION	SYMBOL
			<b>THE TECHNICAL MATERIEL CORP.</b> MAMARONECK. NEW YORK	
STOCK SIZE			POLYETHYLENE, STICK	
MATERIAL		WEIGHT PER PC.		
TYPE & TEMPER			<i>WJC</i>	
			DRAWN	ELEC. DES. APP.
			<i>WJC</i>	
HEAT TREAT. SPEC.			CHECKED	
			FINAL APPROVAL	
FINISH & SPEC. NO.			PO-124	

ISSUE	ITEM	CHANGED FROM	DATE	CN. NO.	DRAFTS	CHECKER	ENG. APP.

TOLERANCES

SCALE

ALL OTHERS  
DEC. DIM.  $\pm$   
FRAC. DIM.  $\pm$   
ANGULAR DIM.  $\pm$

DRILL, PUNCH, COMMERCIAL STOCK SIZES AND MANUFACTURERS TOLERANCES ARE NOT INCLUDED.