

IF IT IS FOUND DESIRABLE TO CHANGE ANY TOLERANCE OR OTHER DETAIL SPECIFIED ON THIS DRAWING NOTIFY THE PURCHASER PROMPTLY.

RELEASED

PN-100

MAXIMUM ALLOWABLE TOLERANCES HAVE BEEN DETERMINED AND DEVIATIONS WILL BE CAUSE FOR REJECTION. REMOVE ALL BURRS AND SHARP EDGES

USED ON

MODEL	PROJECT NO.	ASS'Y. NO.	DATE
TWR-115	151	A-217	9-25-52

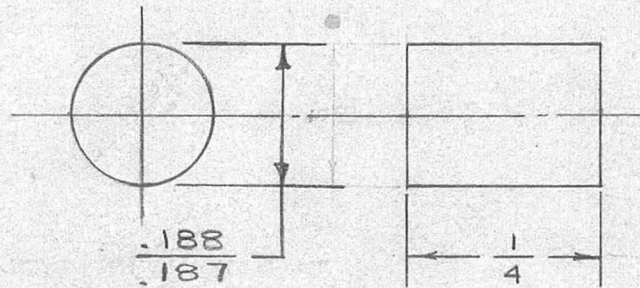

REQ.	ITEM	PART NO.	DESCRIPTION	SYMBOL
		$.188$ $.187$ DIA.	THE TECHNICAL MATERIEL CORP. MAMARONECK. NEW YORK	
		STOCK SIZE		GUIDE PIN
		STEEL DRILL ROD		
		MATERIAL		
		WEIGHT PER PC.		
		TYPE & TEMPER		
		HEAT TREAT. SPEC.		
		FINISH & SPEC. NO.		

ISSUE	ITEM	CHANGED FROM	DATE	CN. NO.	DRAFTS	CHECKER	ENG. APP.
TOLERANCES			SCALE 4" TO 1"				
ALL OTHERS	DEC. DIM. $\pm .005$ FRAC. DIM. $\pm \frac{.04}{64}$ ANGULAR DIM. $\pm$		DRILL, PUNCH, COMMERCIAL STOCK SIZES AND MANUFACTURERS TOLERANCES ARE NOT INCLUDED.				

DRAWN	ELEC. DES. APP.	MECH. DES. APP.
<i>J. Gabel</i>		<i>0076</i>
<i>J. A. DeWalt</i>		<i>FF</i>
CHECKED	FINAL APPROVAL	
	PN-100	

