

PM-927-0

REVISIONS

SYM	DESCRIPTION	DATE	E.M.N. NO.	DRAFT	CHKD	APPD
0	ORIGINAL RELEASE FOR PRODUCTION	3-16-64				

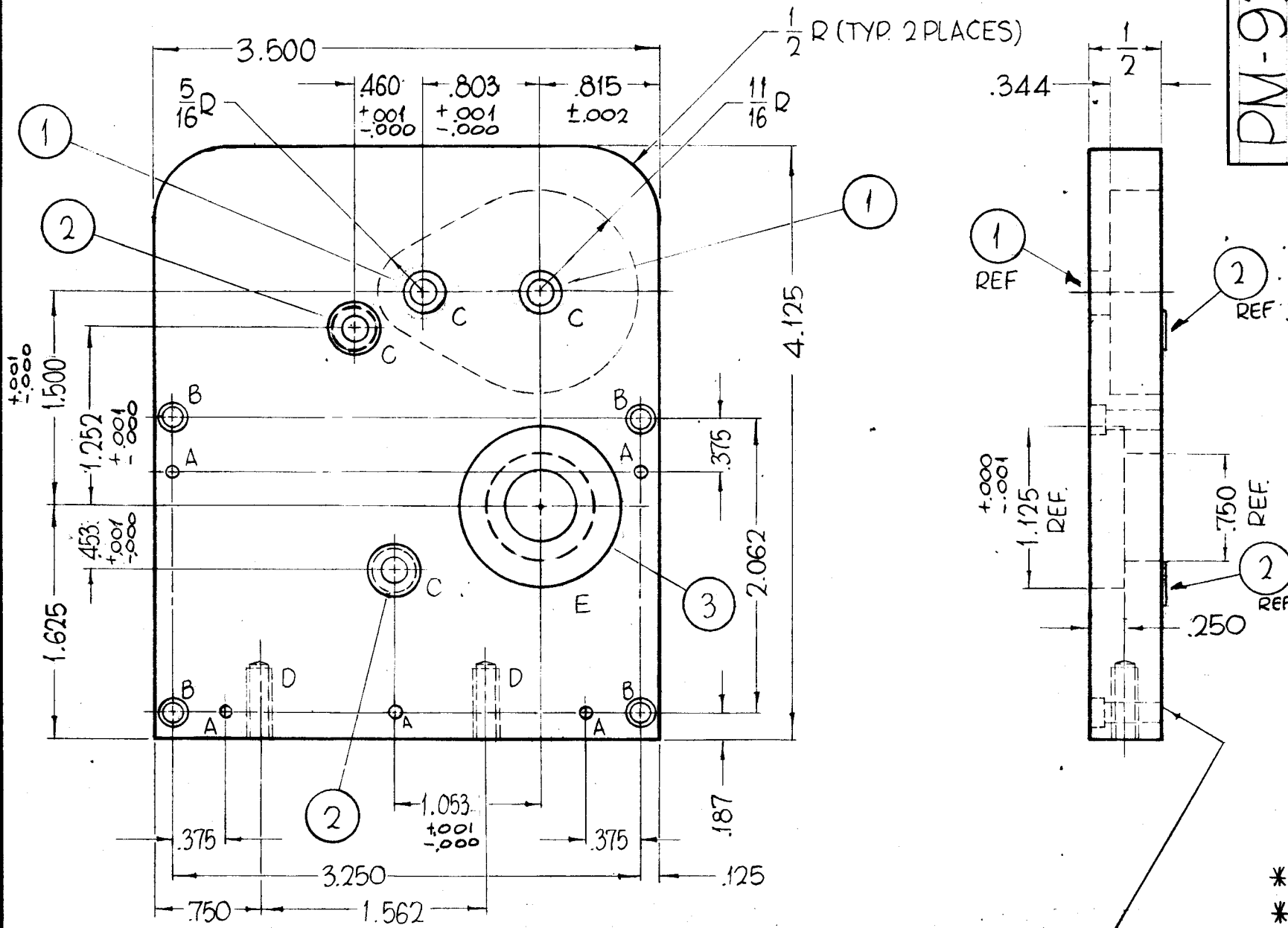

METAL STAMP TMC PART NO. 1/8 HIGH GOTHIC.
(PM-927-0)

HOLES	REQ.
A - .093 DIA. THRU (SEE NOTE +)	5
B - DRILL & C'BORE FOR 4-40 SOCKET HD CAP SCREW.	4
C - .314 $\pm .0002$ DIA.	4
D - DRILL & TAP 10-32 X 1/2 DEEP	2
E - DRILL .750 THRU, C'BORE 1.125 $\pm .0001$ X .250 DEEP	1

REQ'D.	ITEM	PART NUMBER	DESCRIPTION	SYMBOL
*	1	3	BB-120-3	BEARING, RACE
*	2	2	BB-118-2	BEARING, FLANGE
*	2	1	BB-123-27	BEARING, CYLINDRICAL

F. BUDETTI LIST OF MATERIAL

MATERIAL: 1/2 THICK, ALUMINUM, 2024 - T4

FINISH: S404-IDIDITE, 14-2, AL-COAT

TITLE: THE TECHNICAL MATERIEL CORP. MAMARONECK, NEW YORK

PLATE, RETAINING, COUNTER REDUCTION BOX (TF-2)

UNLESS OTHERWISE SPECIFIED

* ALL BEARINGS TO BE WRINGING FIT (CLASS-5), INSERTED AFTER MACHINING AND IRIDITING.
+ SHOULD BE DRILLED AND PINNED UPON ASS'Y.

1	GPT-200K (AX-395)	A-3204
Q'TY./UNIT	MODEL USED ON	ASS'Y. NO.
SCALE #	CODE A	

NOTES

THE CONTENTS OF THIS DRAWING ARE THE EXCLUSIVE PROPERTY OF THE TECHNICAL MATERIEL CORP. ITS UNAUTHORIZED USE OR REPRODUCTION IN WHOLE OR IN PART IS STRICTLY FORBIDDEN.

UNLESS OTHERWISE SPECIFIED DIMENSIONS ARE IN INCHES AND INCLUDE CHEMICALLY APPLIED OR PLATED FINISHES

DECIMALS: .X ± .05, .XX ± .01, .XXX ± .005

FRACTIONS: ± 1/64, ANGLES: ± 0° 30'

TOLERANCES

DRAWN: John C. Biele	DATE: 6-15-63	FINAL APPROVAL: RJC	DATE: 3-16-64
CHECKED: [Signature]	DATE: [Blank]		
ELECT. [Signature]	DATE: 3/16/64	PM-927	0
MECH. [Signature]	DATE: [Blank]		