

PM-850 A

REVISIONS

SYM	DESCRIPTION	DATE	E.M.N. NO.	DRAFT	CHKD	APPD
XI	1.250 DIM WAS 1.218 (ON 'B' HOLES)	10-15-63				
O	ORIGINAL RELEASE FOR PRODUCTION	5.18.64		WFB		
A	.438/.401 R WAS .406 R	11/27/65	14987	X.V.V.	J.P.S.	W.M.M.

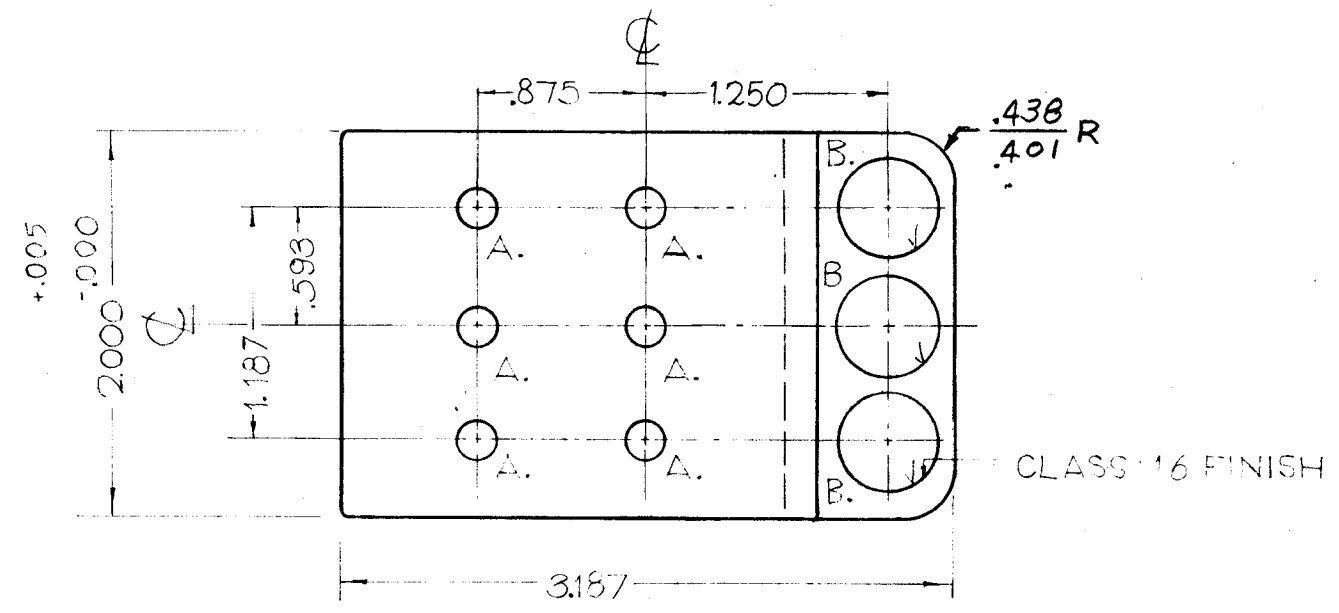
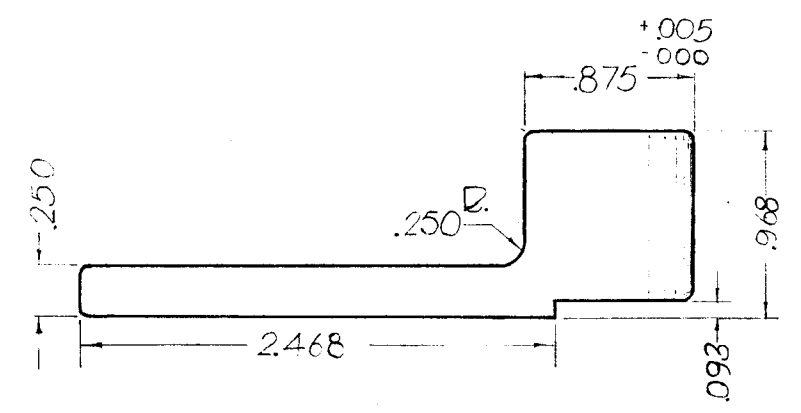

CLASS 16 FINISH

FINISH NOTE:

UNLESS OTHERWISE SPECIFIED USE 1/32 RAD. ON ALL CORNERS & EDGES  
 POLISH BEFORE PLATING  
 S-245 SILVER PLATE, BRIGHT  
 S-423 BRIDITE 18-D SILVER-KOTE

HOLES REQ.

- A- (218) DIA. (6)
- B- (515) DIA. (3)

Q'TY./UNIT	MODEL USED ON	ASS'Y. NO.
4	GPT-200K AS-123	AX-448
8	GPT-200K AS-123	AX-447
SCALE	CODE	
FULL		

THE CONTENTS OF THIS DRAWING ARE THE EXCLUSIVE PROPERTY OF THE TECHNICAL MATERIEL CORP. ITS UNAUTHORIZED USE OR REPRODUCTION IN WHOLE OR IN PART IS STRICTLY FORBIDDEN.

NOTES

REQ'D.	ITEM	PART NUMBER	DESCRIPTION	SYMBOL
F. BUDETTI LIST OF MATERIAL				
MATERIAL BRASS HALF HARD			THE TECHNICAL MATERIEL CORP. MAMARONECK, NEW YORK	
FINISH SEE NOTES			TITLE CONTACT HOLDER, BANDSWITCH	
UNLESS OTHERWISE SPECIFIED DIMENSIONS ARE IN INCHES AND INCLUDE CHEMICALLY APPLIED OR PLATED FINISHES			DRAWN J.F. VIT20	DATE 11/27/65
			CHECKED J.P.S.	DATE 11/27/65
			ELECT. DES. J.P.S.	DATE 11/27/65
			MECH. DES. W.M.M.	DATE 11/27/65
DECIMALS .X ± .05 .XX ± .01 .XXX ± .005				FRACTIONS ± 1/64 ANGLES ± 0° 30'
TOLERANCES				FINAL APPROVAL R.P.
THE CONTENTS OF THIS DRAWING ARE THE EXCLUSIVE PROPERTY OF THE TECHNICAL MATERIEL CORP. ITS UNAUTHORIZED USE OR REPRODUCTION IN WHOLE OR IN PART IS STRICTLY FORBIDDEN.				PART NUMBER PM-850
NOTES				REV. LTR. A