

A  
DM-842

REVISIONS

SYM	DESCRIPTION	DATE	E.M.N. NO.	DRAFT	CHKD	APPD
0	ORIGINAL RELEASE FOR PRODUCTION	5.18.64		WJB		
A	ADDED 9/64 RADIUS	11.29.66	17344	RME	QJS	QJS

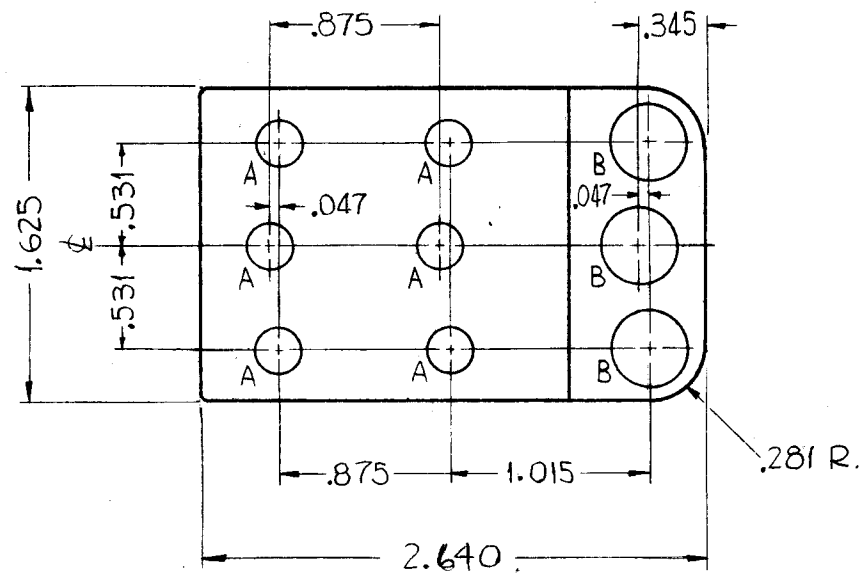
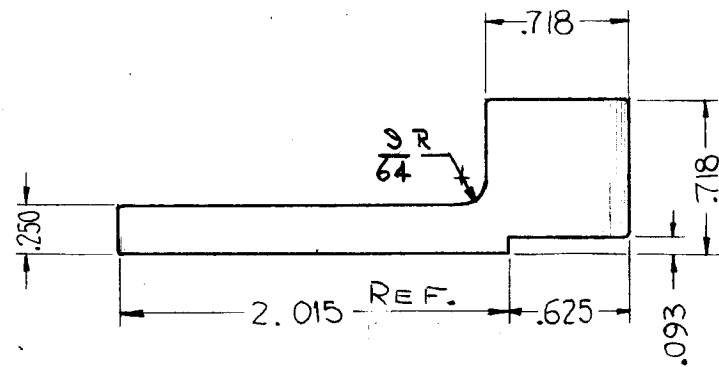

HOLES:

A ~.218 DIA. — 6 REQ.  
B ~.390 DIA. — 3 REQ.

FINISH NOTE:

POLISH BEFORE PLATING  
S.245 SILVER PLATE, BRIGHT  
S 423 IRIDITE 18-D SILVER-KOTE  
ROUND ALL EDGES & CORNERS. 1/32 R  
ALL DIMENSIONS APPLY AFTER PLATING.

NOTES

10	GPT-200K AS-124	AX-442
Q'TY./UNIT	MODEL USED ON	ASS'Y. NO.
SCALE	CODE	
DO NOT SCALE		
THE CONTENTS OF THIS DRAWING ARE THE EXCLUSIVE PROPERTY OF THE TECHNICAL MATERIEL CORP. ITS UNAUTHORIZED USE OR REPRODUCTION IN WHOLE OR IN PART IS STRICTLY FORBIDDEN.		

REQ'D.	ITEM	PART NUMBER	DESCRIPTION	SYMBOL
	F. BUDETTI		LIST OF MATERIAL	
MATERIAL		THE TECHNICAL MATERIEL CORP. MAMARONECK, NEW YORK		
FINISH		SEE NOTE		
TITLE		HOLDER CONTACT, BANDSWITCH (SM)		
DRAWN	SRG	DATE	11-19-62	FINAL APPROVAL
CHECKED	aa	DATE		
ELECT. DES.	SRG	DATE	11/27/64	PM-842
MECH. DES.	WJB	DATE		
SHEET				A
				REV. LTR.