

THE CONTENTS OF THIS DRAWING ARE THE EXCLUSIVE PROPERTY OF THE TECHNICAL MATERIEL CORP. ITS UNAUTHORIZED USE OR REPRODUCTION IN WHOLE OR IN PART IS STRICTLY FORBIDDEN.

REQ. PER UNIT

USED ON

MODEL

ASS'Y. NO.

DATE

1

TRC-20K

11-3-61

PM-727

A

TMC NO	"A"	B	C	IMPEDANCE
PM-727-1	1-7/8	1-5/16	1.231 ± .003	50 OHMS
PM-727-2	2 ± .005	.880 ± .002	.80 ± .003	70 OHMS

HOLE'S REQ.
A ~ 1/4-20 Tapped 1

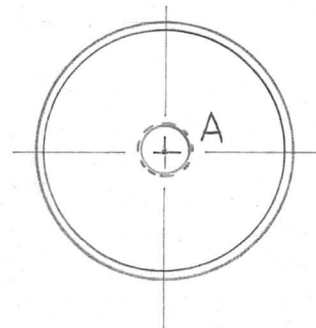
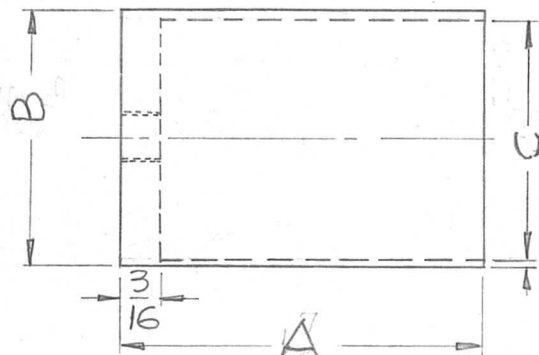

REQ.	ITEM	PART NO.	DESCRIPTION				SYMBOL	
			THE TECHNICAL MATERIEL CORP. MAMARONECK, NEW YORK					
			STOCK SIZE					
Δ	COLUMNS B, C, D ADDED, PM-727-2 ADDED	2-27-62 6450	GG	LB	LB	BRASS	CONTACT, CUP TYPE 3/8 EIA, 50 OHM	
			MATERIAL					
SYM	DESCRIPTION	DATE	CH. NO.	DRAFTS	CHECKER	ENG. APP.		
UNLESS OTHERWISE SPECIFIED: DIMENSIONS ARE IN INCHES TOLERANCES ON FRAC. ± 1/64 DEC. ± .005 ANGLES ± 1/2°		SCALE:		MAXIMUM ALLOWABLE TOLERANCES HAVE BEEN DETERMINED AND ANY DEVIATIONS WILL BE CAUSE FOR REJECTION. REMOVE ALL BURRS AND SHARP EDGES				
				TYPE & TEMPER		HEATTREAT. SPEC.		
				5-245 SILVER PLATE				
				FINISH & SPEC. NO.		ELEC. DES. APP.	MECH. DES. APP.	
				D. J. W. P. M.				
				LB				
				O. B.				
				PM-727			A	