

| | | | | |
|----------------|---------|-----------|---------|--------|
| REQ. PER. UNIT | USED ON | | | PM-677 |
| | MODEL | ASSY. NO. | DATE | |
| 9 | APP-4 | | 12-5-60 | |

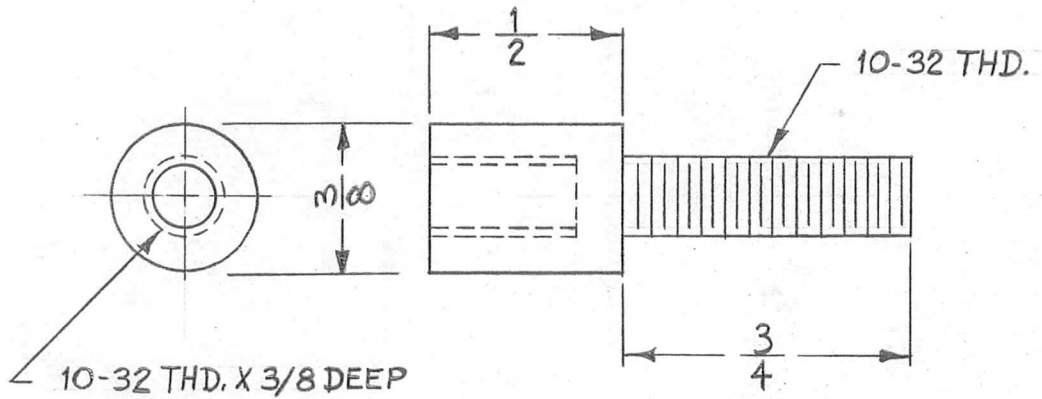

REF: 5410 (MODIFIED AS SHOWN)

| REQ. | ITEM | PART NO. | DESCRIPTION | | SYMBOL | | |
|--------------------|------|------------------|--|----------------|--------------------|----------------|-----------|
| | | 3/8 THK | THE TECHNICAL MATERIEL CORP. | | | | |
| | | STOCK SIZE | MAMARONECK, NEW YORK | | | | |
| | | BRASS | TERMINAL BUSHING TYPE | | | | |
| | | MATERIAL | | | | | |
| ISSUE | ITEM | CHANGED FROM | DATE | CH. NO. | DRAFTS | CHECKER | ENG. APP. |
| TOLERANCES | | | SCALE: 1:2 S401-89(5410) | | | | |
| DEC. DIM. ± | | | MAXIMUM ALLOWABLE TOLERANCES HAVE BEEN DETERMINED AND ANY DEVIATIONS WILL BE CAUSE FOR REJECTION. REMOVE ALL BURRS AND SHARP EDGES | | | | |
| FRAC. DIM. ± | | | | | | | |
| ANGULAR DIM. ± | | | | | | | |
| TYPE & TEMPER | | HEATTREAT. SPEC. | | DRAWN | CHECKED | FINAL APPROVAL | |
| NICKEL PL. 003 | | | | RK | <i>[Signature]</i> | PM-677 | |
| FINISH & SPEC. NO. | | ELEC. DES. APP | | MECH. DES. APP | | | |