

REQ. PER. UNIT	USED ON			PM 664 C
	MODEL	ASSY. NO.	DATE	
2	CHG-1	GEAR, ASSY	9-16-60	

HOLE S
 A ~ Dr. & Tap for 6-32 on 3/8 R. 120° Apart 3 Req.
 B ~ Dr. & Tap for 6-32 - 3 Req. 120° Apart

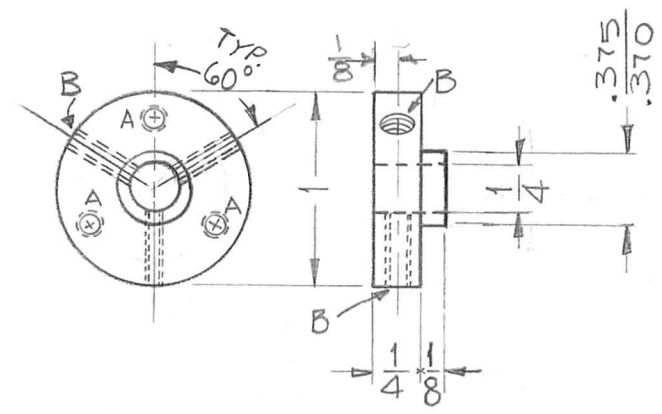

ISSUE	ITEM	CHANGED FROM	DATE	CH. NO.	DRAFTS	CHECKER	ENG. APP.	REQ.	ITEM	PART NO.	DESCRIPTION	SYMBOL	
C		ADDED 1 "B" HOLE; 60° WAS 45°	3/28/66	16023	HCA						THE TECHNICAL MATERIEL CORP. MAMARONECK, NEW YORK	C	
B	2	DIM 1/8 WAS 1/4.	11/21/60	3530	DPM	JCP							
	1	REQ. PER UNIT WAS 1.											
A	1	.375 DIA. WAS 3/8	9/29/60	3106	cu	HCA					HUB, DIAL GEAR		
TOLERANCES			SCALE:					FREE TURNING			DR M	HQ	
DEC. DIM. ±			MAXIMUM ALLOWABLE TOLERANCES HAVE BEEN DETERMINED AND ANY DEVIATIONS WILL BE CAUSE FOR REJECTION. REMOVE ALL BURRS AND SHARP EDGES					TYPE & TEMPER	HEATTREAT. SPEC.	DRAWN	CHECKED	FINAL APPROVAL	
FRAC. DIM. ± 1/64								FINISH & SPEC. NO.		ELEC. DES. APP	MECH. DES. APP		
ANGULAR DIM. ±													