

REQ. PER UNIT	USED ON			PM-615 D
	MODEL	ASS'Y. NO.	DATE	
1	GPT-40K	AX-209	3-1-60	

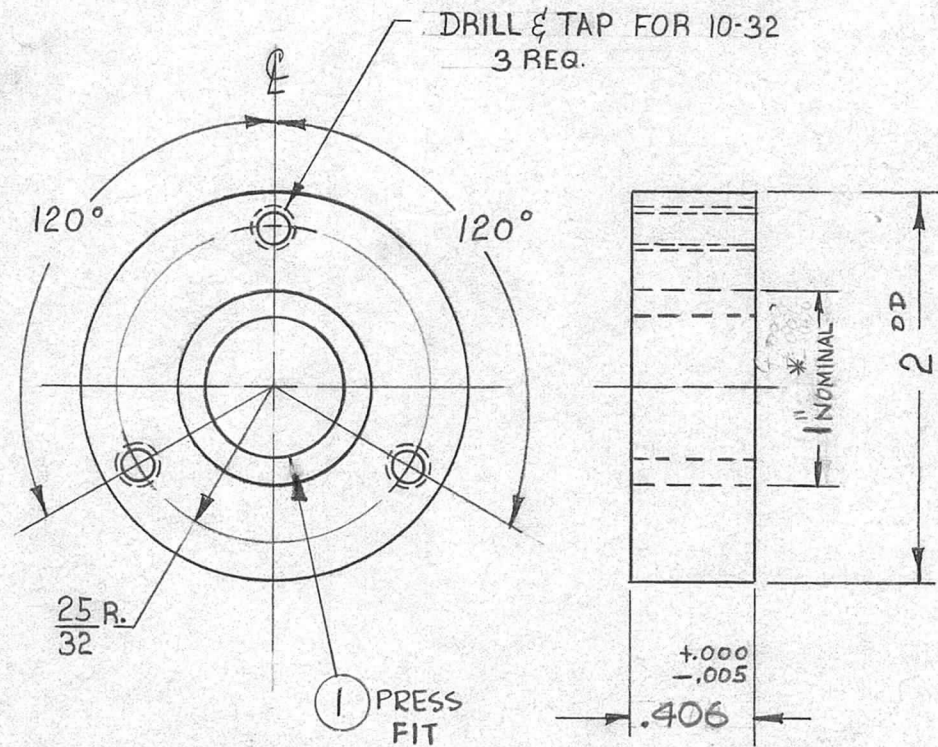

\* DIA TO BE SNUG FIT (CLASS 4) WITH BEARING OD. TMC \* BB-123-1

\* REF TO PE PRESS FIT FOR BB-123-1

D	1	ITEM(S) ADDED	2-7-63	8137	<del>DF</del>	HA	16	1	1	BB-123-1	BEARING, CYLINDRICAL						
C	2	ANGULAR DIM. TOLERANCE	11/1/60	3515	DM	OCB	16	REQ.	ITEM	PART NO.	DESCRIPTION	SYMBOL					
B	2	ADDED TOLERANCE (1.002)	3-21-60	~	MF	He	16	STAINLESS STEEL				THE TECHNICAL MATERIEL CORP. MAMARONECK, NEW YORK					
A	1	DELETED NOTE (SNUG FIT)	3/17/60	#	CY	He	16							303		HUB, BEARING, BOTTOM	
ISSUE		ITEM	CHANGED FROM	DATE	CH. NO.	DRAFTS	CHECKER	ENG. APP.	MATERIAL								
TOLERANCES (UNLESS OTHERWISE SPECIFIED)			SCALE:					TYPE & TEMPER		HEAT TREAT. SPEC.		DRAWN		CHECKED		FINAL APPROVAL	
DEC. DIM. ±			MAXIMUM ALLOWABLE TOLERANCES HAVE BEEN DETERMINED AND ANY DEVIATIONS WILL BE CAUSE FOR REJECTION. REMOVE ALL BURRS AND SHARP EDGES					PASSIVATE				16		PM-615 D			
FRAC. DIM. ± 1/64								FINISH & SPEC. NO.		ELEC. DES. APP		MECH. DES. APP					
ANGULAR DIM. ± 2°																	