

IF IT IS FOUND DESIRABLE TO CHANGE ANY TOLERANCE OR OTHER DETAIL SPECIFIED ON THIS DRAWING NOTIFY THE PURCHASER PROMPTLY.

PM-317 A

MAXIMUM ALLOWABLE TOLERANCES HAVE BEEN DETERMINED AND DEVIATIONS WILL BE CAUSE FOR REJECTION. REMOVE ALL BURRS AND SHARP EDGES

REQ. PER UNIT	USED ON			
	MODEL	PROJECT NO.	ASS'Y. NO.	DATE
1	PMo-1	285		9-1-54
1	PMo-2	285		9-1-54
1	VOX-1,2	291		1-12-55
1	RTF			2-1-56
1	RTF-2	F/P		11-20-58

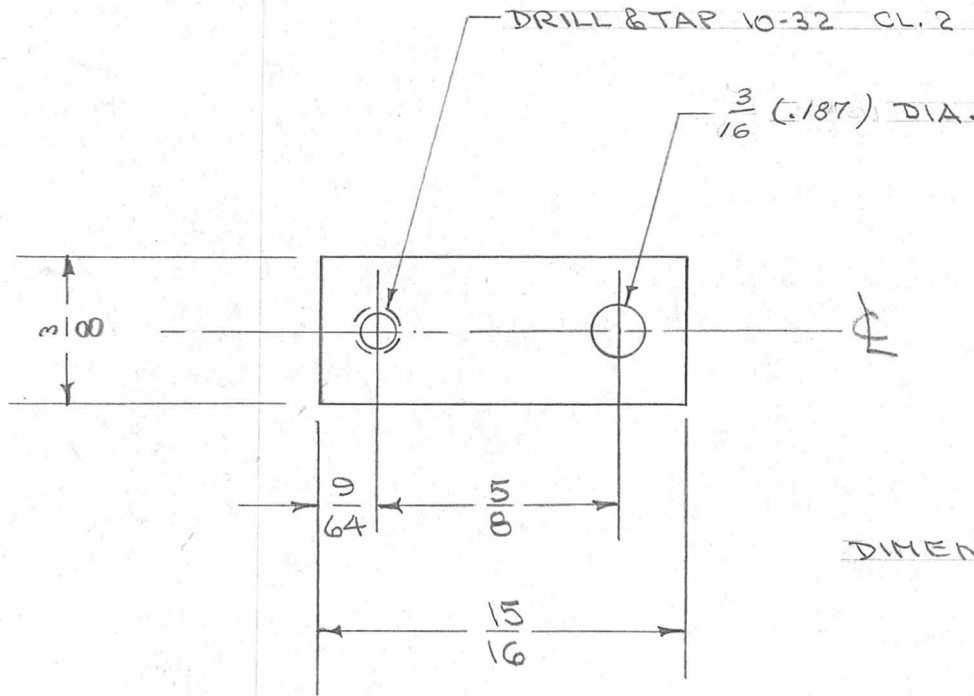

DIMENSIONS ARE AFTER PLATING.

REQ.	ITEM	PART NO.	DESCRIPTION	SYMBOL
			Y8 THICK	
			STOCK SIZE	
	STEEL	#	STOP, CALIBRATE CONTROL	
	MATERIAL	WEIGHT PER PC.	(MAIN GEAR ASSY.)	
			COLD ROLLED	
			TYPE & TEMPER	
			HEAT TREAT. SPEC.	
			S-105 CADMIUM PLATE .0003	
			FINISH & SPEC. NO.	
			THE TECHNICAL MATERIEL CORP. MAMARONECK. NEW YORK	
			DRAWN	ELEC. DES. APP. MECH. DES. APP.
			CHECKED	FINAL APPROVAL
			PM-317	A

ISSUE	ITEM	CHANGED FROM	DATE	CN. NO.	DRAFTS	CHECKER	ENG. APP.
A	1	3/16 WAS 9/64 DIA.	3/15/55	1	P.B.	WOC	WOC

TOLERANCES		SCALE
ALL OTHERS	DEC. DIM. $\pm$ FRAC. DIM. $\pm \frac{1}{64}$ ANGULAR DIM. $\pm$	DRILL, PUNCH, COMMERCIAL STOCK SIZES AND MANUFACTURERS TOLERANCES ARE NOT INCLUDED.