

QTY	MODEL USED ON	ASS'Y NO.	LTR	DESCRIPTION	DATE	E.M.N.NO	DRAFT	CHKD	APPD
1	HFRR-4		X	EXP. RELEASE	11-17-67		JL		
			Ø	ORIG. RELEASE FOR PROD.	11-6-68	Ø	R.G.		JL

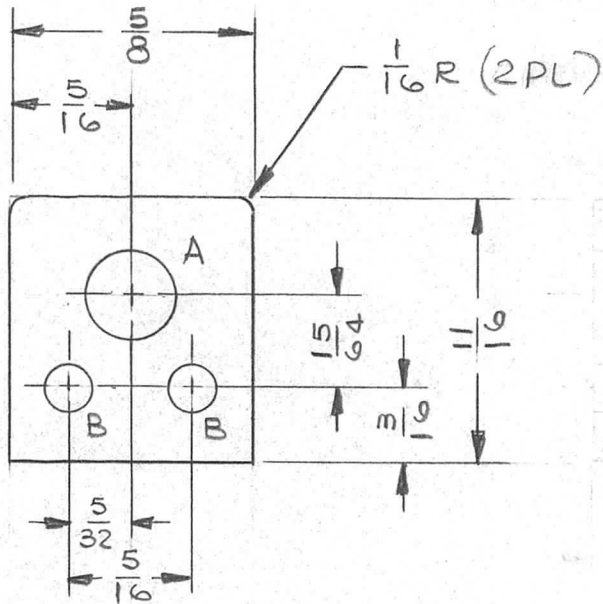

HOLE LEGEND		
HOLE	DESCRIPTION	REQ
A	LETTER "B" (.2380) DR	1
B	.125 DIA.	2

UNLESS OTHERWISE SPECIFIED DIMENSIONS ARE IN INCHES AND INCLUDE CHEMICALLY APPLIED OR PLATED FINISHES		REQ'D	ITEM	PART NUMBER	DESCRIPTION	SYM.
DECIMALS: .X ± .05, .XX ± .01, .XXX ± .005 FRACTIONS: 1/64, ANGLES: 0°-30'		HOGAN (ZETENA) LIST OF MATERIAL SK3252-003-57 THE TECHNICAL MATERIEL CORP. MAMARONECK, NEW YORK SUPPORT, SHAFT-FRONT (TUNER)				
MATERIAL: .125 THICK ALUMINUM 2024-T3	MECH. DES. M. ZETENA	DATE	11/6/68			
FINISH S404 YEL IRIDITE	ELECT. DES.	DATE	11/19/68			
S401-451	CHECKED SG	DATE	11/17/67			
	DRAWN JL	DATE	11/17/67			

NOTICE TO PERSONS RECEIVING THIS DRAWING THE TECHNICAL MATERIEL CORPORATION claims proprietary right in the material disclosed hereon. This drawing is issued in confidence for engineering information only and may not be reproduced or used to manufacture anything shown hereon without permission from THE TECHNICAL MATERIEL CORPORATION to the user. This drawing is loaned for mutual assistance and is subject to recall at any time.				SIZE	CODE IDENT. NO.	DWG NO.	ISSUE
				A	82679	PM1359	Ø
				SCALE	SHEET		OF