

APPLICATION			REVISIONS							
QTY	MODEL USED ON	ASS'Y NO.	LTR	DESCRIPTION	DATE	E.M.N.NO	DRAFT	CHKD	APPD	
2	BCT-10KA		X	EXP. RELEASE	10/18/67		Enf	MP	AK	
			Ø	ORIGINAL RELEASE FOR PRODUCTION	4/1/68	Ø	HS		JAD	

HOLES
9/32 DIA. (2 REQ.)

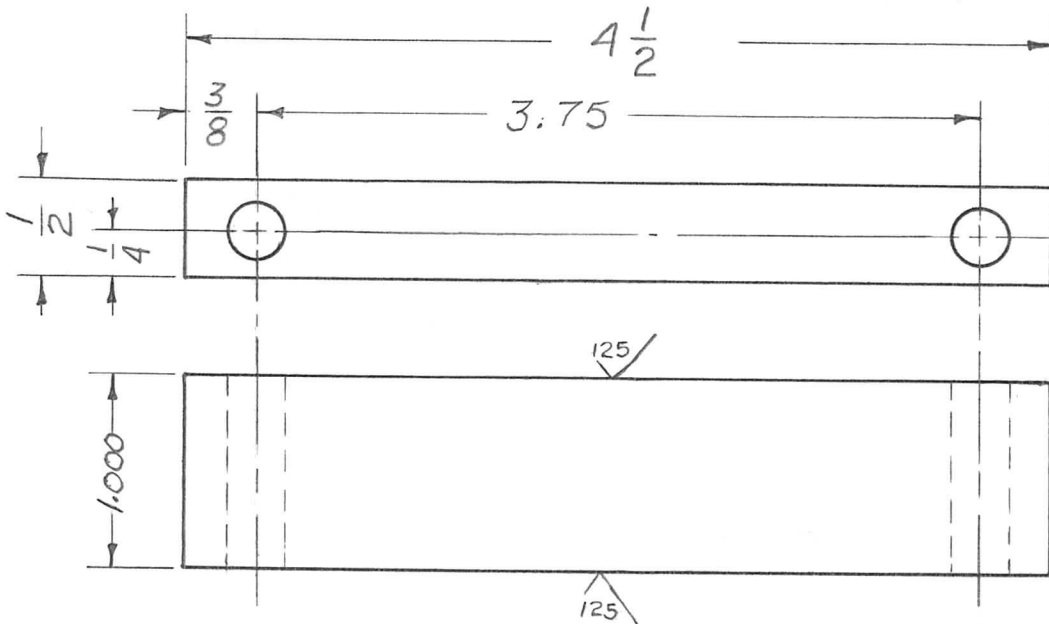

UNLESS OTHERWISE SPECIFIED DIMENSIONS ARE IN INCHES AND INCLUDE CHEMICALLY APPLIED OR PLATED FINISHES		REQ'D	ITEM	PART NUMBER	DESCRIPTION	SYM.
DECIMALS .X ± .05 .XX ± .01 .XXX ± .005		F. BUDETTI		LIST OF MATERIAL		
FRACTIONS 1/64 ANGLES 0° -30'		FINAL APPROVAL SPM		DATE 4-7-68	THE TECHNICAL MATERIEL CORP. MAMARONECK, NEW YORK	
MATERIAL 1/2 THK ALUM. 2024-T4		MECH. DES. AP		DATE 4-2-68	PLATE, GEAR SIDE	
FINISH S404 YELLOW IRIDITE		ELECT. DES.		DATE		
S 401 - 451		CHECKED MP		DATE 4-1-68		
		DRAWN Enf		DATE 10/18/67		

NOTICE TO PERSONS RECEIVING THIS DRAWING THE TECHNICAL MATERIEL CORPORATION claims proprietary right in the material disclosed hereon. This drawing is issued in confidence for engineering information only and may not be reproduced or used to manufacture anything shown hereon without permission from THE TECHNICAL MATERIEL CORPORATION to the user. This drawing is loaned for mutual assistance and is subject to recall at any time.				SIZE A	CODE IDENT. NO. 82679	DWG NO. PM 1342	ISSUE Ø
SCALE 1:1			SHEET		OF		