

REQ. PER UNIT	USED ON			PM1275	A
	MODEL	ASS'Y. NO.	DATE		
1	RFTA-1		7-26-65		

DRILL & TAP FOR.
8-32 (2REQ.)
180° APART

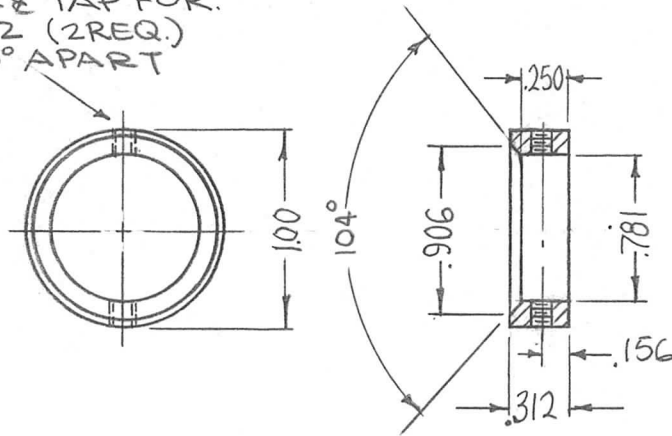

NOTE:
REMOVE SHARP EDGES.

MATES WITH PM1317

REQ.	ITEM	PART NO.	F. BUDETTI DESCRIPTION				SYMBOL
		1" ROD	THE TECHNICAL MATERIEL CORP. MAMARONECK, NEW YORK				
		STOCK SIZE					
A	ADDED 104° ANGLE	8.2466	16783	RME	QCB	QCB	
Ø	ORIGINAL RELEASE FOR PRODUCTION	3-3-66	-A-	Jc	QCB	anc	
SYM	DESCRIPTION	DATE	CH. NO.	DRAFTS	CHECKER	ENG. APP.	
UNLESS OTHERWISE SPECIFIED DIMENSIONS ARE IN INCHES AND INCLUDE CHEMICALLY APPLIED OR PLATED FINISHES		SCALE 1:1		MATERIAL			
				HALF HARD		DRAWN	
				TYPE & TEMPER		CHECKED	
				HEAT TREAT. SPEC.		FINAL APPROVAL	
DECIMALS .X ± .05 .XX ± .01 .XXX ± .005		FRACTIONS ± 1/64 ANGLES ± 0° 30'		CODE A		S245 SILVER PLATE S 423 IRIDITE 18P SILVER KOTE	
TOLERANCES				FINISH & SPEC. NO.		ELEC. DES. APP. MECH. DES. APP.	
						PM1275 A	