

REQ. PER UNIT	USED ON		
	MODEL	ASSY. NO.	DATE
1	TSTE-10K	A	4-7-64

PM1242

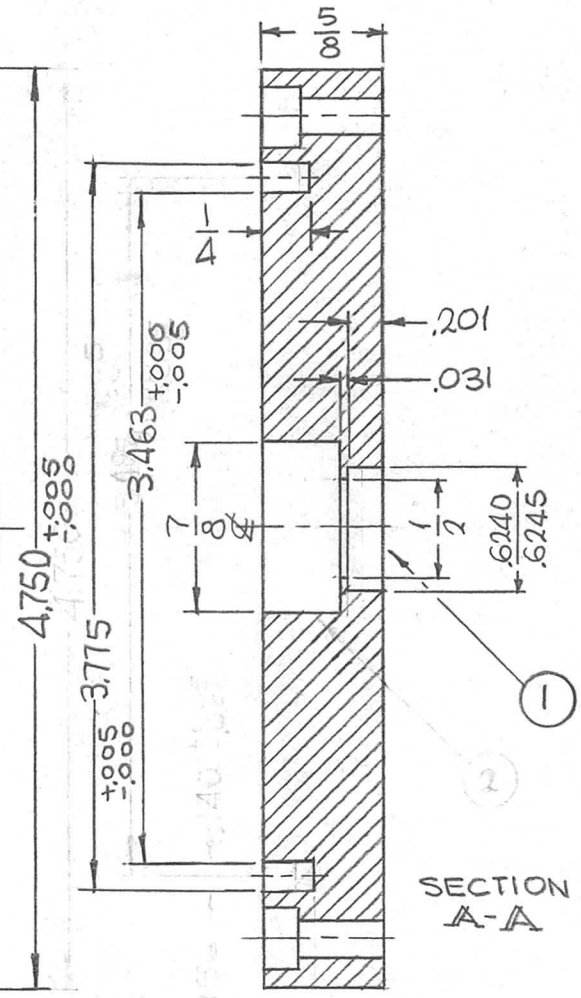
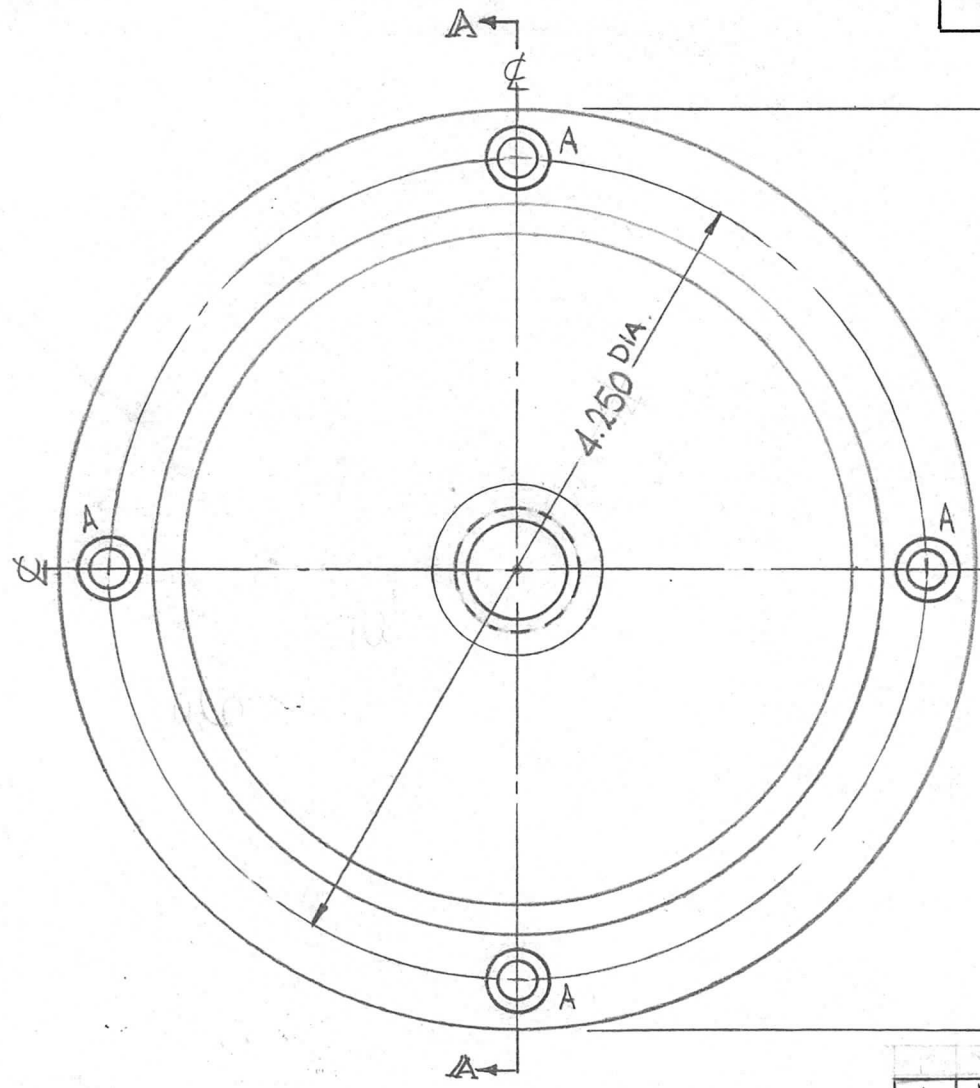

HOLES:  
 A~ DRILL 3/16 DIA.  
 C'BORE 5/16 DIA.  
 X 3/16 DEEP.  
 (4 REQ.)

SECTION A-A

							1	1	BB126-1	BEARING, RACE		
							REQ. ITEM	PART NO.		F. BUDETTI	DESCRIPTION	SYMBOL
							AS SHOWN			THE TECHNICAL MATERIEL CORP. MAMARONECK. NEW YORK		
							STOCK SIZE			PLATE, CAP. BOTTOM		
							ALUMINUM					
							MATERIAL					
							2024-T3		SRG	<i>JS</i>	<i>Q.B</i>	
							TYPE & TEMPER		HEAT TREAT. SPEC.	DRAWN	CHECKED	FINAL APPROVAL
							S404 YEL IRIDITE			<i>JS</i>		PM1242
							FINISH & SPEC. NO.		ELEC. DES. APP.	MECH. DES. APP.		

Ø	ORIGINAL RELEASE FOR PRODUCTION	8-3-66	Ø	RME		
X2	3.463 <sup>+0.008</sup> / <sub>-0.005</sub> WAS 3.495 <sup>+0.005</sup> / <sub>-0.005</sub>	4-26-65	X2	SRG	DA	<i>JS</i>
X1	GROOVE WAS .156 3.495 WAS 3.594 TO Ø	4-20-65	X1	SRG		<i>BC</i>
SYM	DESCRIPTION	DATE	CH. NO.	DRAFTS	CHECKER	ENG. APP.
UNLESS OTHERWISE SPECIFIED DIMENSIONS ARE IN INCHES AND INCLUDE CHEMICALLY APPLIED OR PLATED FINISHES		SCALE 1:1				
DECIMALS .X ± .05 .XX ± .01 .XXX ± .005	TOLERANCES	FRACTIONS ± 1/64 ANGLES ± 0° 30'	CODE A			