

REVISIONS		SYM	DESCRIPTION	DATE	E.M.N. NO.	DRAFT	CHKD	APPD
X	EXPERIMENTAL RELEASE			3-9-65	X	SPG		
X1	2, 8-32 TAP HOLES ADDED, MODEL WAS GPT-10K			5-5-65	X1	SPG	DA	
X2	RIDING SURFACE INCREASED BY 3/8			8-3-65	X2	SPG	DA	
Ø	ORIGINAL RELEASE FOR PRODUCTION			4-20-66	Ø	CV		

PM1230 Ø

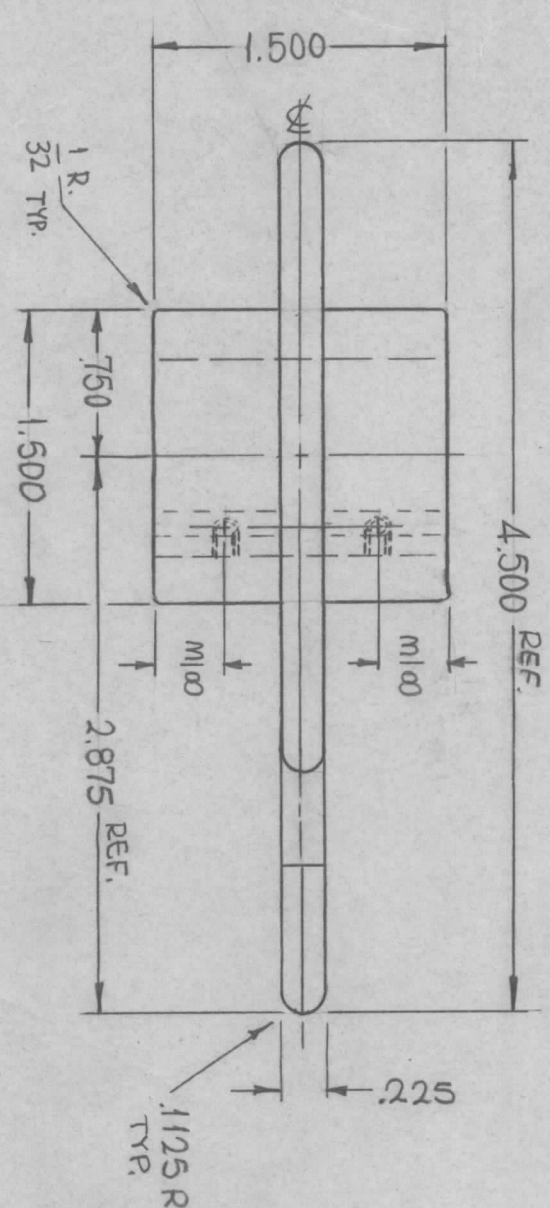
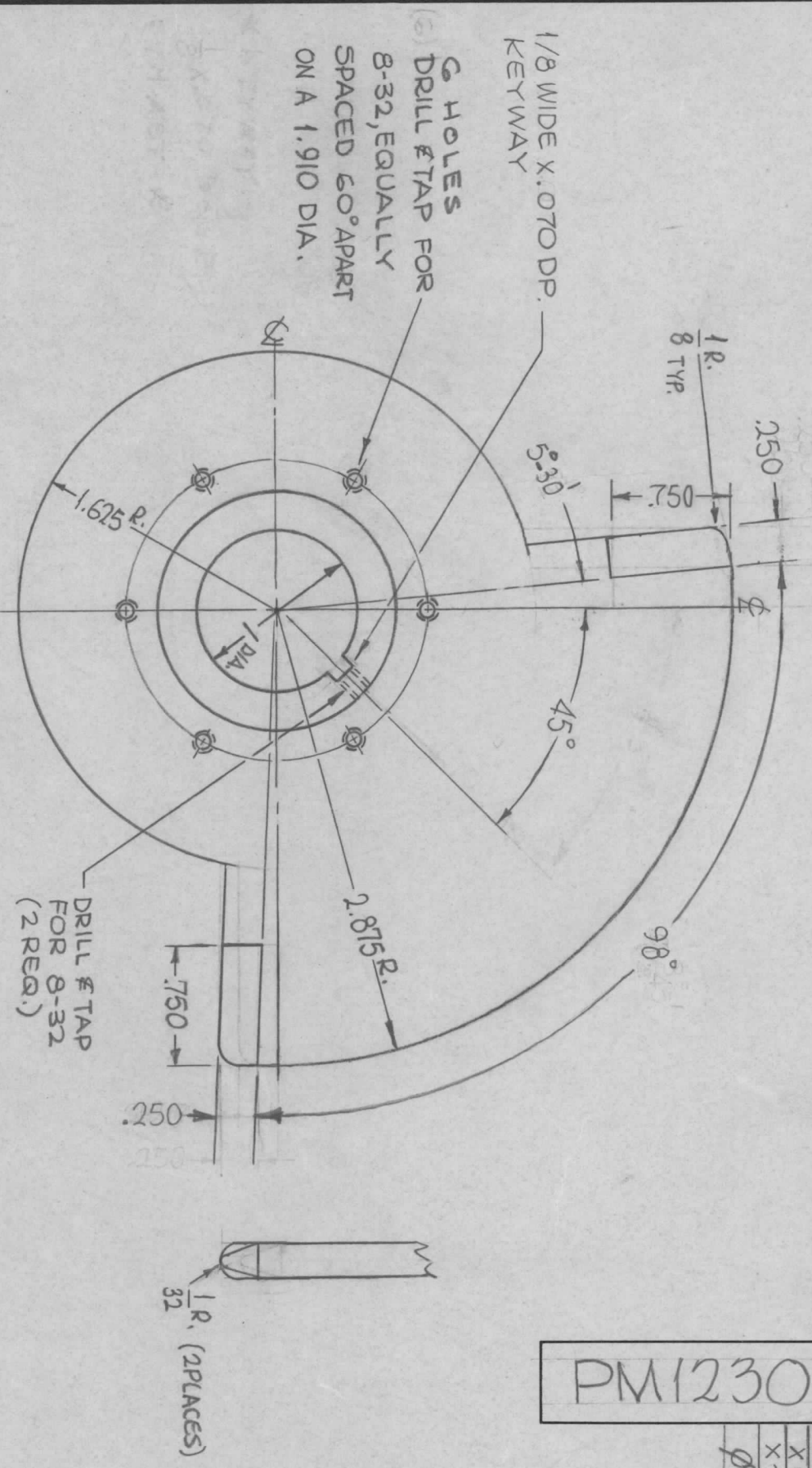

NOTE:  
POLISH SMOOTH ALL SURFACES.

NOTES

QTY./UNIT	1	MODEL USED ON	TST (110K)	ASSY. NO.	
SCALE	1:1	CODE	A		

REQ'D.	ITEM	PART NUMBER	DESCRIPTION	SYMBOL
	F. BUDETTI		LIST OF MATERIAL	
	MATERIAL		BRASS, HALF HARD	
	FINISH		S 245 SILVER PLATE	
			S 423 IRIDIUM 18-P SILVER-KOTE	
			UNLESS OTHERWISE SPECIFIED DIMENSIONS ARE IN INCHES AND INCLUDE CHEMICALLY APPLIED OR PLATED FINISHES	
	DECIMALS		TOLERANCES	FRACTIONS
	.X ± .05			± 1/64
	.XX ± .01			ANGLES
	.XXX ± .005			± 90° 30'

THE TECHNICAL MATERIEL CORP.		MAMARONECK, NEW YORK	
TITLE	ROTOR, BANDSWITCH	DATE	DATE
DRAWN	SPG	DATE	DATE
CHECKED	SPG	DATE	DATE
ELECT. DES.		DATE	DATE
MECH. DES.		DATE	DATE

FINAL APPROVAL  
 [Signature]  
 PM1230  
 SHEET