

STANDARD DRAWING

REQ. PER UNIT

USED ON

MODEL

ASS'Y. NO.

DATE

#

STANDARD

#

4-14-64

PM-1051

A

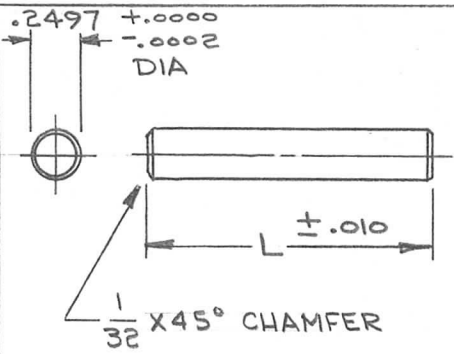

STYLE-RF (ROUND FULL)

NOTE:

ALL SHAFTS SHALL NOT DEVIATE FROM STRAIGHTNESS MORE THAN .005 PER. FOOT.

TYPE DESIGNATION TO BE IN THE FOLLOWING FORM:

PM-1051-RF-0.812

BASIC TMC PART NO.

STYLE

LENGTH DESIRED EXPRESSED IN 3 DECIMAL PLACES.

REQ.	ITEM	PART NO.	CAMARDA	DESCRIPTION	SYMBOL	
A	CLERICAL CHANGE	824.64	WB	@		
O	ORIGINAL RELEASE FOR PRODUCTION	4-15-64	Z	G. Swann		
X	EXPER. RELEASE	4-14-64	1	G. Swann	@	
SYM	DESCRIPTION	DATE	CH. NO.	DRAFTS	CHECKER	ENG. APP.
UNLESS OTHERWISE SPECIFIED DIMENSIONS ARE IN INCHES AND INCLUDE CHEMICALLY APPLIED OR PLATED FINISHES		SCALE				
DECIMALS	FRACTIONS	CODE				
.X $\pm .05$	$\pm 1/64$	A				
.XX $\pm .01$	ANGLES					
.XXX $\pm .005$	$\pm 0^\circ 30'$					
TOLERANCES						
REQ.	ITEM	PART NO.	CAMARDA	DESCRIPTION	SYMBOL	
				THE TECHNICAL MATERIEL CORP. MAMARONECK. NEW YORK		
				SHAFT, PRECISION		
				.2497 DIA.		
				303		
				STAINLESS STEEL		
				TYPE & TEMPER		
				HEAT TREAT. SPEC.		
				DRAWN		
				CHECKED		
				FINAL APPROVAL		
				6-104 PASSIVATE		
				FINISH & SPEC. NO.		
				ELEC. DES. APP.		
				MECH. DES. APP.		
				PM-1051	A	