

HOLES

A-.187 DIA. $\begin{matrix} +.000 \\ -.001 \end{matrix}$

REQ. 6

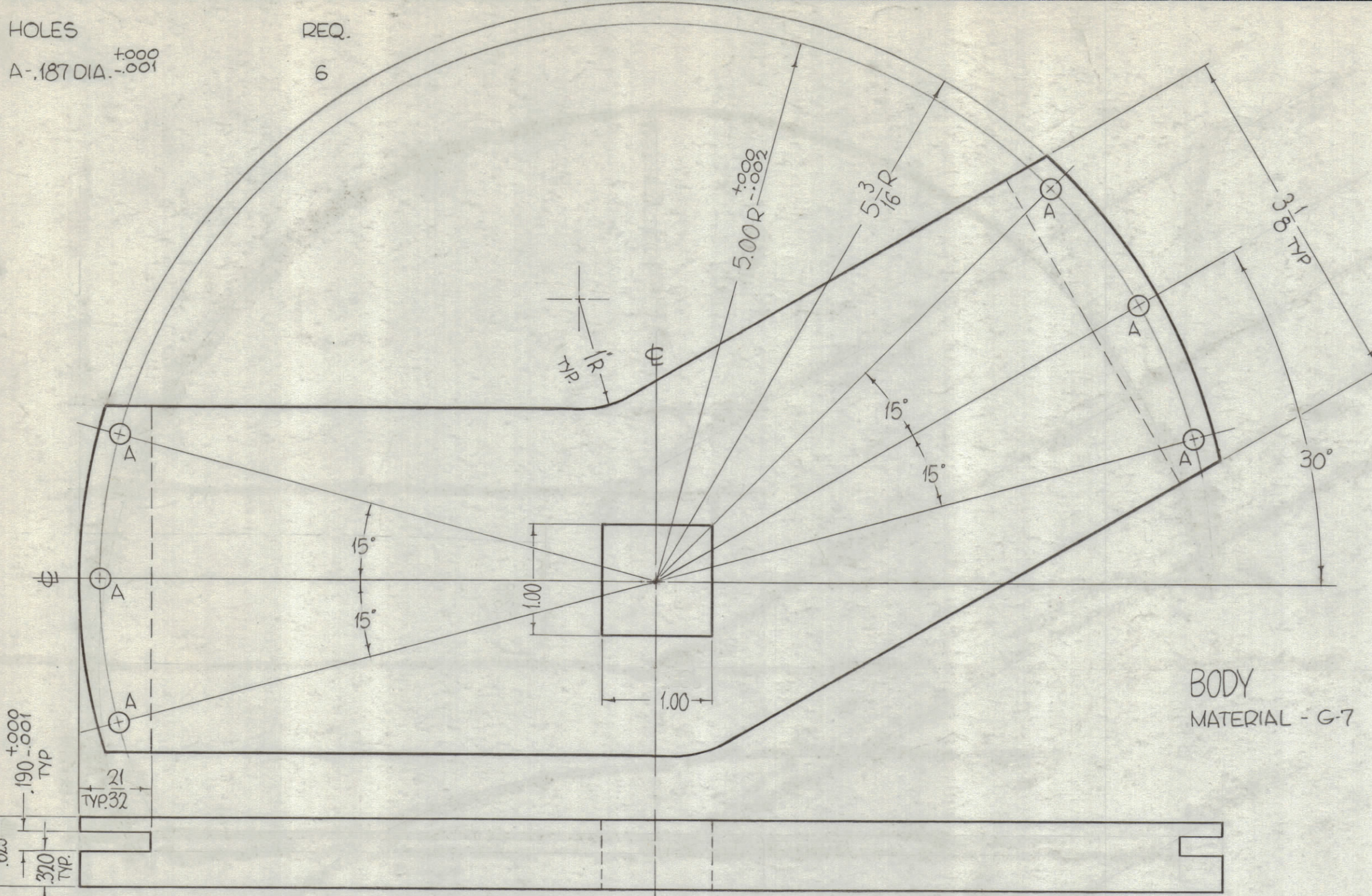

BODY MATERIAL - G-7

REVISIONS

ZONE	SYM	DESCRIPTION	DATE	E.M.N. NO.	DRAFT	CHKD	APPD
	X1	ON HUB & WAS 15° TO CORNER ALSO ON FINAL ASSY	1-7-64				
	X2	TOLERANCES FOR HUB REMOVED NOTE ADDED	1-22-64				
	0	ORIGINAL RELEASE FOR PRODUCTION	5-18-64				

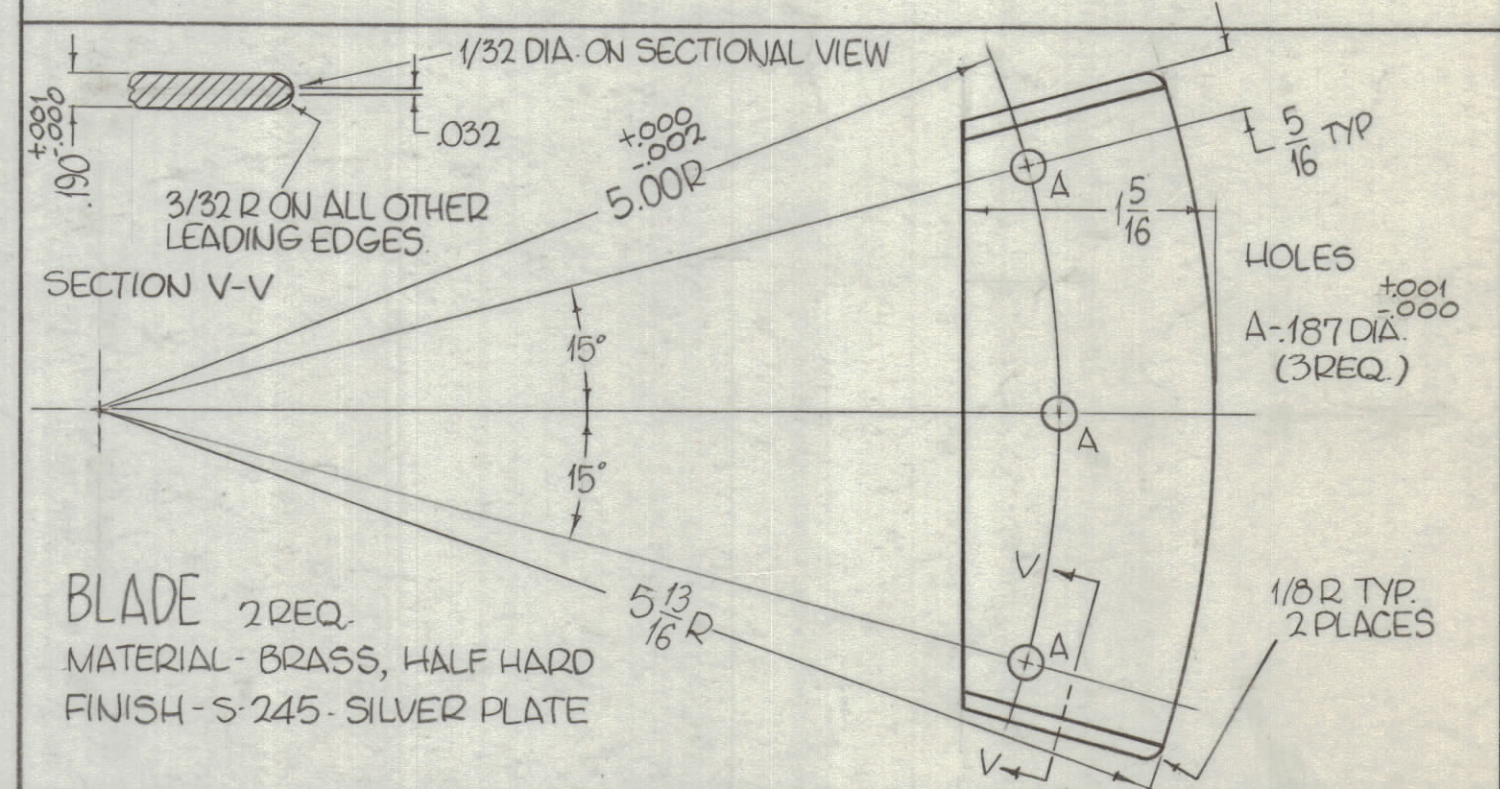

BLADE 2REQ. MATERIAL - BRASS, HALF HARD FINISH - S-245 - SILVER PLATE

PRESS FIT BLADE INTO BODY AND PIN AS SHOWN.

PRESS FIT HUB INTO BODY POSITIONING AS SHOWN.

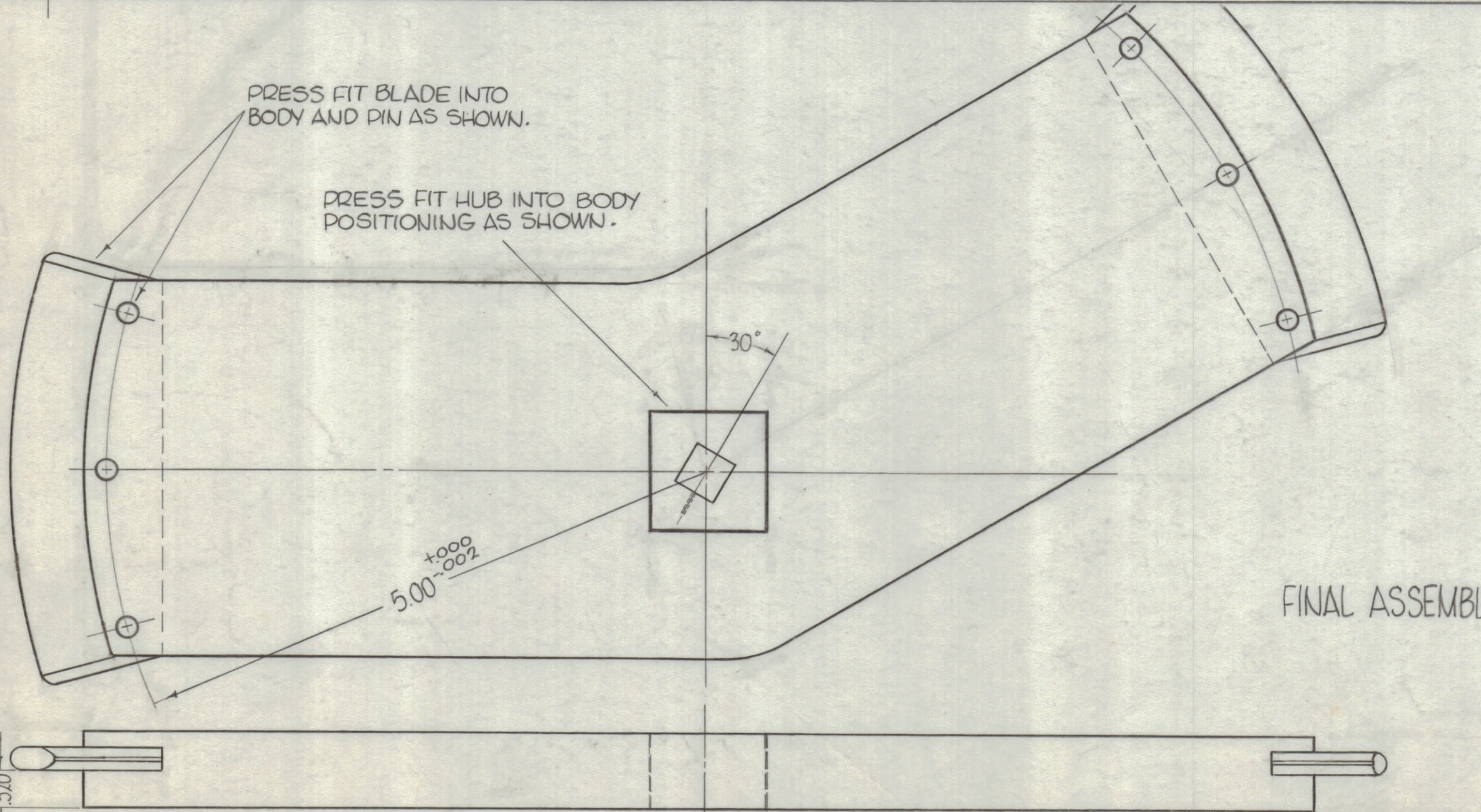

FINAL ASSEMBLY

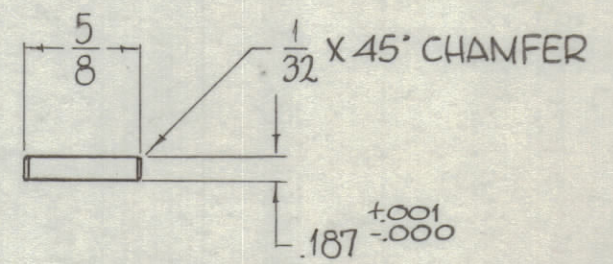

PIN 6REQ MATERIAL - STAINLESS STEEL (NON MAGNETIC)

PRESS FIT HUB INTO BODY UPON ASSY.

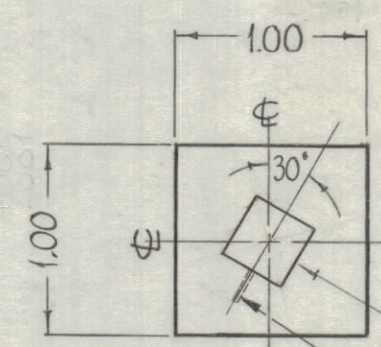

HUB MATERIAL - BRASS, HALF HARD

REQ'D.	ITEM	PART NUMBER	DESCRIPTION	SYMBOL
F. BUDETTI LIST OF MATERIAL				
MATERIAL			THE TECHNICAL MATERIEL CORP. MAMARONECK, NEW YORK	
FINISH			TITLE ROTOR, SHORTING, II-1	
UNLESS OTHERWISE SPECIFIED DIMENSIONS ARE IN INCHES AND INCLUDE CHEMICALLY APPLIED OR PLATED FINISHES		DRAWN John C. Biele	DATE 1-2-64	FINAL APPROVAL Kil
DECIMALS .X ± .05 .XX ± .01 .XXX ± .005		CHECKED J.C.B.	DATE 4/11/64	DATE PM-1007
TOLERANCES		ELECT. DES. J.C.B.	DATE 2/4/64	SHEET 0
FRACTIONS ± 1/64 ANGLES ± 0° 30'		REV. LTR.		

NOTES

THE CONTENTS OF THIS DRAWING ARE THE EXCLUSIVE PROPERTY OF THE TECHNICAL MATERIEL CORP. ITS UNAUTHORIZED USE OR REPRODUCTION IN WHOLE OR IN PART IS STRICTLY FORBIDDEN.