

| | | | | | |
|---------------|-----------------|------------|--------|---------|---|
| REQ. PER UNIT | USED ON | | | PM-1006 | Ø |
| | MODEL | ASS'Y. NO. | DATE | | |
| 2 | GPT-200K AS-123 | AX-500 | 1-2-64 | | |

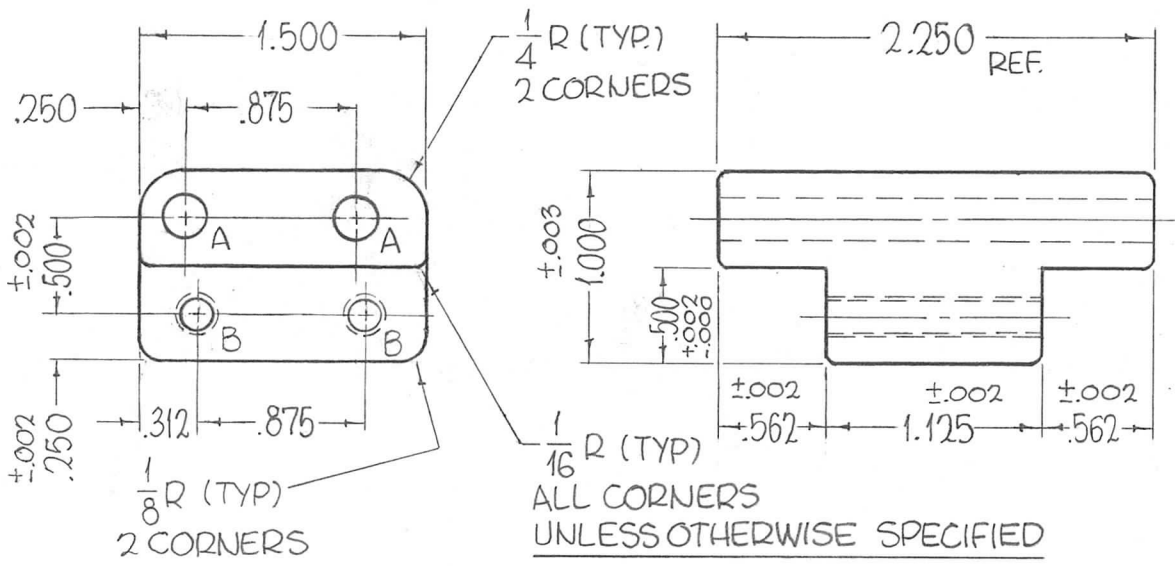

HOLES REQ.

A - 15/64 DIA. THRU 2

B - DRILL AND TAP THRU 10-32 THREADS 2

NOTE - ALL DIMENSIONS APPLY AFTER PLATING.

| | | | | | | | | | | | |
|---|-------------------|-----------|---------|--------|---------|-----------|--------------------|-------------------|------------------------------|-----------------|----------------|
| | | | | | | REQ. ITEM | PART NO. | F. BUDETTI | DESCRIPTION | SYMBOL | |
| | | | | | | | AS NOTED | | THE TECHNICAL MATERIEL CORP. | | |
| | | | | | | | STOCK SIZE | | MAMARONECK, NEW YORK | | |
| 0 | ORIGINAL RELEASE | 5.16.64 | | | WJB | | ALUMINUM | | POST, SUPPORT RETAINER | | |
| X1 | B Holes relocated | 2-5-64 | | | | | | | | | |
| SYM | DESCRIPTION | DATE | CH. NO. | DRAFTS | CHECKER | ENG. APP. | MATERIAL | | | | |
| UNLESS OTHERWISE SPECIFIED DIMENSIONS ARE IN INCHES AND INCLUDE CHEMICALLY APPLIED OR PLATED FINISHES | | SCALE | | | | | 6063-T5 | | John C Biele | aa HB | RC |
| | | 1" = 1" | | | | | TYPE & TEMPER | HEAT TREAT. SPEC. | DRAWN | CHECKED | FINAL APPROVAL |
| DECIMALS | TOLERANCES | FRACTIONS | CODE | | | | S-245-SILVER PLATE | | ØB | RC 3/16 | PM-1006 |
| .X ± .05 | | ± 1/64 | | | | | FINISH & SPEC. NO. | | ELEC. DES. APP. | MECH. DES. APP. | Ø |
| .XX ± .01 | | ANGLES | | | | | | | | | |
| .XXX ± .005 | | ± 0° 30' | | | | | | | | | |