

DL-204

**SPECIFICATIONS**

SERIES ~ MINIATURE (BAYONET LOCKING TYPE)  
 NO OF CONTACTS ~ ONE (1)  
 TYPE OF CONTACT ~ FEMALE  
 DIELECTRIC ~ TEFLON

**ELECTRICAL DATA**

MAX. PEAK VOLT. ~ 1500 V RMS (For one min.)  
 IMPEDANCE ~ 48 Ω ; OPER. VOLT ~ 500 V RMS  
 USABLE FREQ. RANGE ~ 1 To 500 MC (For a VSWR not exceeding 1.25)

**CABLE ACCOMODATIONS**

MIN. O.D. ~ .090 ; MAX. O.D. ~ .115  
 CABLE INSUL. MAX. DIA. ~ .066  
 INNER CONDUCTOR MAX. DIA. ~ .048

**MATERIAL & FINISH**

EXT. PARTS ~ BRASS ; SILVER PLATE  
 BUSHING ~ " " "  
 CLAMPS ~ " " "  
 GASKETS ~ BUNA N40 DUROMETER (BLACK)  
 CONTACT ~ BERYLLIUM COPPER ; SILVER PLATE,  
 INSULATOR ~ TEFLON

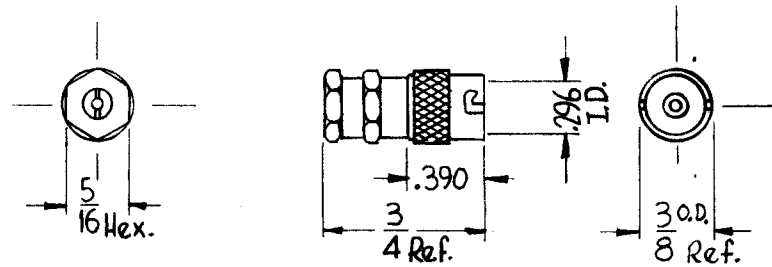
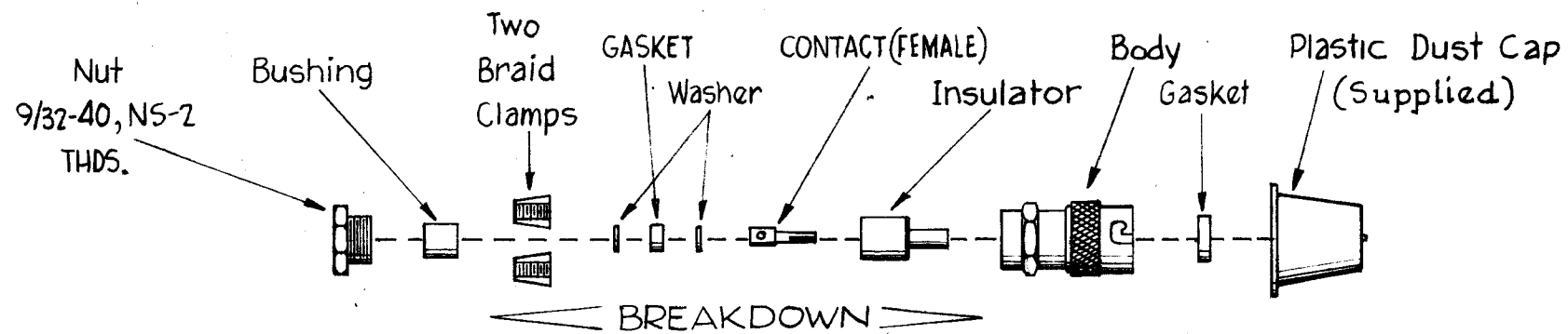

**NOTICE TO PERSONS RECEIVING THIS DRAWING**

THE TECHNICAL MATERIEL CORPORATION claims proprietary right in the material disclosed herein. This drawing is issued in confidence for engineering information only and may not be reproduced or used to manufacture anything shown hereon without permission from THE TECHNICAL MATERIEL CORPORATION to the user. This drawing is issued for mutual assistance and is subject to recall at any time.

Property of:  
 THE TECHNICAL MATERIEL CORPORATION  
 MAMARONECK, NEW YORK

SYM	DESCRIPTION	DATE	CH. NO.	DRAFTS	CHECKER	ENG. APP.
	UNLESS OTHERWISE SPECIFIED: DIMENSIONS ARE IN INCHES TOLERANCES ON FRACTIONS ± 1/64 DECIMALS ± .005 ANGLES ± 1/2°					

SCALE: S-401-133 (6410-1)  
 MAXIMUM ALLOWABLE TOLERANCES HAVE BEEN DETERMINED AND ANY DEVIATIONS WILL BE CAUSE FOR REJECTION.  
 REMOVE ALL BURRS AND SHARP EDGES

REQ. PER UNIT	MODEL	SECTION	ASS'Y. NO.	DATE
3	CHG-2/IF			6-8-61
1	CHG-2/DIV.			6-8-61

REQ. ITEM	PART NO.	DESCRIPTION	SYMBOL
		THE TECHNICAL MATERIEL CORP. MAMARONECK, NEW YORK	
		CONNECTOR, PLUG, MINIATURE (Female)	
		MATERIAL	
		TYPE & TEMPER	
		HEAT TREAT. SPEC.	
		FINISH & SPEC. NO.	

DRAWN: *D.D. Max*  
 CHECKER: *J. H. Lee*  
 FINAL APPROVAL: *[Signature]*  
 ELEC. DES. APP.: *S.D.*  
 MECH. DES. APP.: *[Signature]*  
 PL-204