

NT-136

TABLE I								REF: TABLE II SHANK CODE
TMC CODE FOR THD SIZE	THREAD SIZE	RECOMMENDED HOLE SIZES		A MAX.	B MIN.	C MAX.	D MIN.	DASH NUMBERS AVAILABLE AS STANDARD
		MAX.	MIN.					
256	2-56NC-2B	.135	.133	.190	.068	.132	.025	1 - 2 - 3 - 4
440	4-40NC-2B	.167	.165	.252	.087	.164	.030	1 - 2 - 3 - 4
632	6-32NC-2B	.220	.217	.315	.107	.216	.035	1 - 2 - 3 - 4
832	8-32NC-2B	.271	.268	.344	.126	.267	.041	1 - 2 - 3 - 4
1024	10-24NC-2B	.271	.268	.344	.146	.267	.050	2 - 3 - 4
1032	10-32NF-2B							
420	1/4-20UNC-2B	.355	.352	.439	.191	.351	.065	4 - 5 - 6
428	1/4-28UNF-2B							
518	5/16-18UNC-2B	.411	.408	.534	.237	.407	.076	4 - 5 - 6 - 7
524	5/16-24UNF-2B							
616	3/8-16UNC-2B	.475	.472	.627	.292	.471	.097	5 - 6 - 7
624	3/8-24UNF-2B							
813	1/2-13UNC-2B	.612	.609	.815	.378	.608	.128	5 - 6 - 7
820	1/2-20UNF-2B							

SHANK CODE	TABLE II PLATE THICKNESS		E MAX.
	MIN.	MAX.	
1	.020	.031	.018
2	.032	.039	.030
3	.040	.055	.038
4	.056	.090	.054
5	.091	.122	.087
6	.123	.184	.120
7	.185	UP	.180

TABLE III RECOMMENDED ASSEMBLY PRESSURE			
NOMINAL SIZE	INSTALLATION PRESSURE LBS.	AVERAGE PUSH-OUT LBS.	AVERAGE TORQUE-OUT INCH PDS.
#2	1000-2000	190	13
#4	1500-2500	210	25
#6	2000-3000	275	45
#8	4000-5000	440	70
#10	4000-5000	440	120
1/4	5000-6000	675	270
5/16	6000-7000	810	475
3/8	7000-8000	1420	800
1/2	11000-12000	1680	1750

**NOTE:**  
The mounting hole may be drilled, reamed or punched, but correct hole tolerance must be observed to assure proper anchoring of the nut. Locking feature as per MIL-N-25027.

**FINISH:**  
Cadmium Plate Per QQ-P-416, Type 1; Class 3.

TMC PART NO. TO BE IN FOLLOWING FORM.

NT-136-832-7

BASIC PART NO.      THREAD SIZE CODE. USE TABLE I.      SHANK CODE USE TABLE II

NOTICE TO PURCHASERS REGARDING THIS DRAWING:  
 THE TECHNICAL MATERIEL CORPORATION claims proprietary right in the material disclosed herein. This drawing is issued in confidence for engineering information only and may not be reproduced or used to manufacture anything shown herein without permission from THE TECHNICAL MATERIEL CORPORATION to the user. This drawing is loaned for mutual assistance and is subject to recall at any time.

Property of:  
 THE TECHNICAL MATERIEL CORPORATION  
 MAMARONECK, NEW YORK

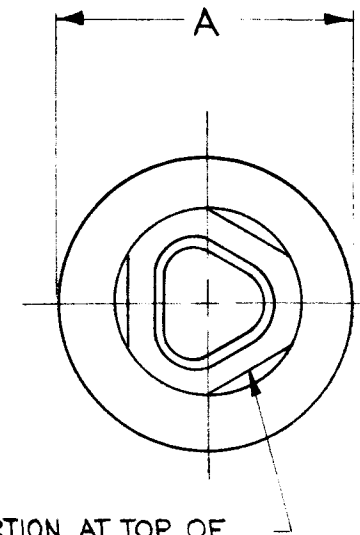

DISTORTION AT TOP OF NUT DUE TO LOCKING FEATURE PERMISSIBLE.

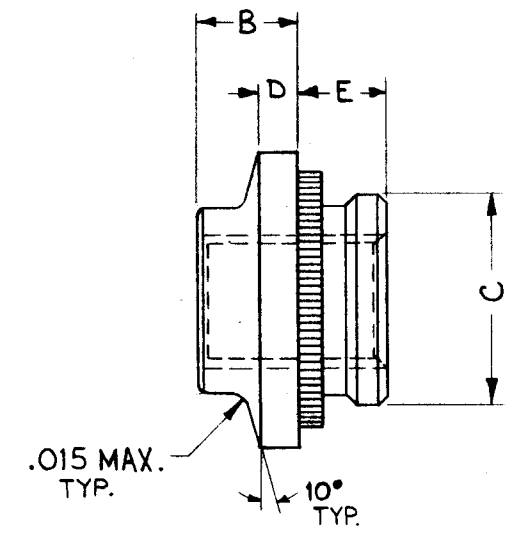

**For Purchasing Information Only:**

Part No. - The SPS Part No. consists of "SNL" plus the dash number plus the shank code.  
 Example: - SNL-420-5 (SPS - Swage Nut, Self Locking 1/4-20 size w/ .087 shank length for use in .091-.122 plate.)

REQ. ITEM	PART NO.	DESCRIPTION	SYMBOL
		THE TECHNICAL MATERIEL CORP. MAMARONECK, NEW YORK	
	STEEL	NUT, ROUND, SWAGE TYPE SELF LOCKING.	
	MATERIAL		
.30 CARBON (MIN)	Rc .32 MIN.		
TYPE & TEMPER	HEAT TREAT. SPEC.	DRAWN	CHECKER
SEE NOTE			
FINISH & SPEC. NO.	ELEC. DES. APP.	MECH. DES. APP.	

SYM	DESCRIPTION	DATE	CH. NO.	DRAFTS	CHECKER	ENG. APP.
	UNLESS OTHERWISE SPECIFIED:					
	DIMENSIONS ARE IN INCHES					
	TOLERANCES ON FRACTIONS ± 1/64    DECIMALS ± .005    ANGLES ± 1/2°					
	SCALE: (S-401-21)					
	MAXIMUM ALLOWABLE TOLERANCES HAVE BEEN DETERMINED AND ANY DEVIATIONS WILL BE CAUSE FOR REJECTION. REMOVE ALL BURRS AND SHARP EDGES					
	REQ. PER UNIT					
	MODEL					
	SECTION					
	ASS'Y. NO.					
	DATE					
	USED ON					