

FOR 3/16 MATERIAL

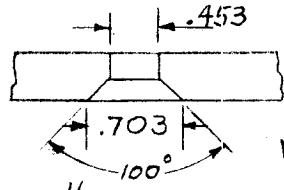

FOR 1/8 MATERIAL

REQ. PER UNIT	USED ON		
	MODEL	ASS'Y. NO.	DATE
6	GPT-750		10-10-57
7	RTX-2		9-17-58
2	GPT-10K	AX-103	1-24-59

NT-124 E

	A	B
NT124	.188	.312
NT124-2	.125	.375

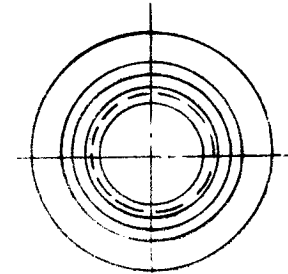
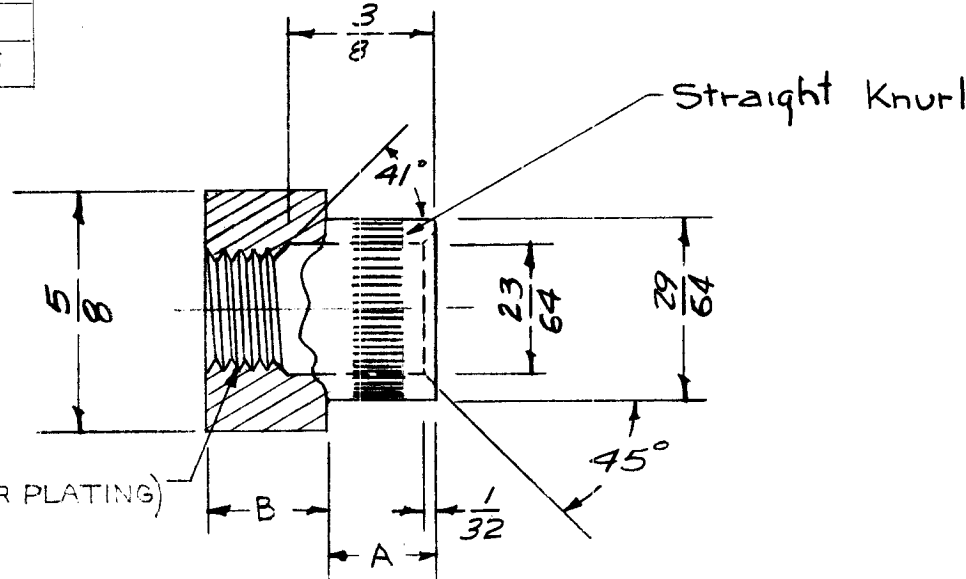

E		ADDED DIM. CHART, NT124, NT124-2, CHGD. 5/16 TO 5/8 & ADDED A TO PICT. DELE. 1/2 DIM.	7-28-66	16653	RME	<i>[Signature]</i>	<i>[Signature]</i>
D	1	HOLE DETAIL ADDED	12/9/59	1654	AB	<i>[Signature]</i>	<i>[Signature]</i>
C	1	Straight Knurl Added	6/4/69	1106	J.C.B.	<i>[Signature]</i>	<i>[Signature]</i>
B	3	23/64 WAS 21/64, 29/64 WAS 15/32, 1/2 WAS 19/32	10-21-58	497	J.C.B.	<i>[Signature]</i>	<i>[Signature]</i>
A	1	SPEC NO. CORRECTED	10/9/58	+	<i>[Signature]</i>	<i>[Signature]</i>	<i>[Signature]</i>

REQ. ITEM	PART NO.	DESCRIPTION	SYMBOL
		THE TECHNICAL MATERIEL CORP. MAMARONECK, NEW YORK	
		STOCK SIZE	
		BRASS	
		MATERIAL	
		CAPTIVE INSERT	
		16 10/10/57	<i>[Signature]</i>
		<i>[Signature]</i>	<i>[Signature]</i>
		TYPE & TEMPER	HEAT TREAT. SPEC.
		S-135 Bright Nickel Plate	
		FINISH & SPEC. NO.	
		DRAWN	CHECKED
		FINAL APPROVAL	
		NT-124 E	
		ELEC. DES. APP.	MECH. DES. APP.

ISSUE	ITEM	CHANGED FROM	DATE	CH. NO.	DRAFTS	CHECKER	ENG. APP.
TOLERANCES		SCALE: 2X					
DEC. DIM. ± .005		MAXIMUM ALLOWABLE TOLERANCES HAVE BEEN DETERMINED AND ANY DEVIATIONS WILL BE CAUSE FOR REJECTION.					
FRAC. DIM. ± 1/64		REMOVE ALL BURRS AND SHARP EDGES					
ANGULAR DIM. ±							