

THREAD SIZE	SIZE CODE	DIMENSIONS			
		A	B	C	D
A-40	0440				
G-32	0632	27/32	13/32	13/32	5/32
G-40	0640	"	"	"	"
8-32	0832	"	"	"	"
10-24	1024	"	"	"	"
10-32	1032	"	"	"	"
12-24	1224	"	"	"	"
1A-20	1420	1 1/32	1/2	1/2	7/32
1A-24	1424	"	"	"	"
YA-20	2520	"	"	"	"
YA-28	2528	"	"	"	"
E/16-18	3118	13/16	19/32	9/16	1/4
E/16-24	3124	"	"	"	"
3/8-16	3716	13/8	23/32	11/16	5/16
3/8-24	3724	"	"	"	"
7/16-14	4314	1 7/8	15/16	29/32	3/8
1/2-13	5013	"	"	"	"

LETTER	MATERIAL
A	ALUMINUM
B	BRASS
S	STEEL
SS	STAINLESS STEEL

LETTER	FINISH
B	BLACK NICKEL
C	CAD. PLATE
N	BRIGHT NICKEL
R	NO FINISH
P	PASSIVATE (STAINLESS ONLY)

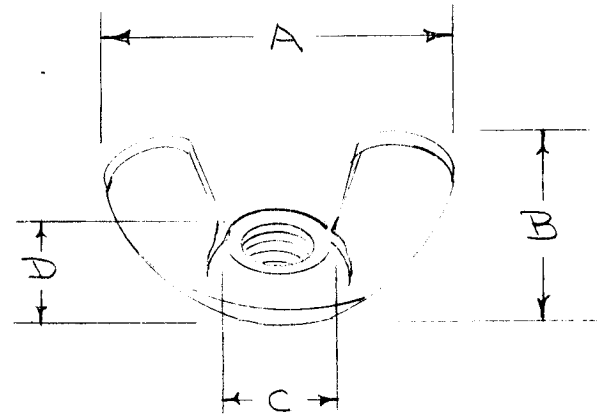

STANDARD DRAWING

TYPE DESIGNATION TO BE IN FOLLOWING FORM

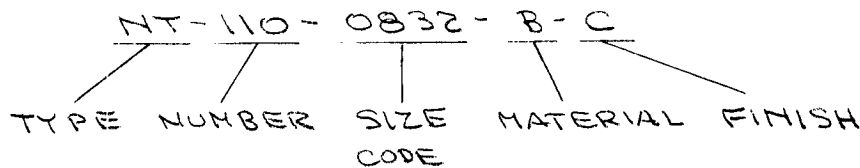

NOTE - DIMENSIONS ARE FOR REFERENCE ONLY.

ISSUE	ITEM	CHANGED FROM	DATE	CH. NO.	DRAFTS	CHECKER	ENG. APP.	REQ. ITEM	PART NO.	DESCRIPTION	SYMBOL		
A	5	NT-110-4 WAS 10-32	12-8-55	1	0000	JAL	WJC			THE TECHNICAL MATERIEL CORP. MAMARONECK. NEW YORK NUT, WING	NT-110 A		
A	4	NT-110-3 WAS 8-32	"	1	"	"	"	STOCK SIZE					
A	3	NT-110-2 WAS 6-32	"	1	"	"	"						
A	2	NT-110-1 WAS 4-40	"	1	"	"	"						
A	1	COMPLETE REVISION	"	1	"	"	"						
TOLERANCES			SCALE:					MATERIAL					
DEC. DIM. ±			MAXIMUM ALLOWABLE TOLERANCES HAVE BEEN DETERMINED AND ANY DEVIATIONS WILL BE CAUSE FOR REJECTION. REMOVE ALL BURRS AND SHARP EDGES					TYPE & TEMPER		HEAT TREAT. SPEC.			
FRAC. DIM. ±								DRAWN		CHECKED		FINAL APPROVAL	
ANGULAR DIM. ±								FINISH & SPEC. NO.		ELEC. DES. APP.		MECH. DES. APP.	