

IF IT IS FOUND DESIRABLE TO CHANGE ANY TOLERANCE OR OTHER DETAIL SPECIFIED ON THIS DRAWING NOTIFY THE PURCHASER PROMPTLY.

STANDARD DRAWING

NT10001

MAXIMUM ALLOWABLE TOLERANCES HAVE BEEN DETERMINED AND DEVIATIONS WILL BE CAUSE FOR REJECTION. REMOVE ALL BURRS AND SHARP EDGES

USED ON

MODEL

PROJECT NO.

ASS'Y. NO.

DATE

JUNE 19
1959

USE SPECIFICATION SM-111
(AMERICAN DRAWING)

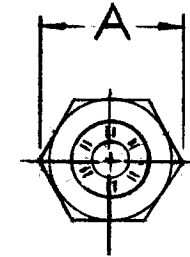
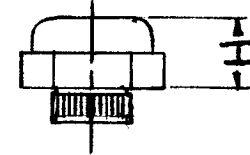

TMC PART NO	SCREW SIZE	H	A	THK. OF MATL.
NT 10001-1	No 4			
NT 10001-2	No 6	3/16	23/64	.064
NT10001-3	NO. 8	1/4	7/16	.064

REQ.	ITEM	PART NO.	DESCRIPTION		SYMBOL
			TMC (Canada) LIMITED		
			OTTAWA ONTARIO		
			RIVNUT		
			MATERIAL	WEIGHT PER PC.	
			JPC		
			DRAWN		M. Kr.
			HEAT TREAT. SPEC.		MECH. DES. APP.
			FINISH & SPEC. NO.		FINAL APPROVAL
					NT10001

ISSUE ITEM CHANGED FROM DATE CN. NO. DRAFTS CHECKER ENG. APP.

TOLERANCES

SCALE 2:1

ALL OTHERS

DEC. DIM. \pm
FRAC. DIM. \pm
ANGULAR DIM. \pm

DRILL, PUNCH, COMMERCIAL STOCK SIZES AND MANUFACTURERS TOLERANCES ARE NOT INCLUDED.