

IF IT IS FOUND DESIRABLE TO CHANGE ANY TOLERANCE OR OTHER DETAIL SPECIFIED ON THIS DRAWING NOTIFY THE PURCHASER PROMPTLY.

NS-108

MAXIMUM ALLOWABLE TOLERANCES HAVE BEEN DETERMINED AND DEVIATIONS WILL BE CAUSE FOR REJECTION. REMOVE ALL BURRS AND SHARP EDGES

REQ. PER UNIT	USED ON			
	MODEL	PROJECT NO.	ASS'Y. NO.	DATE
6	TAC-1	132	AM117 A-700 A-701	1-21-54

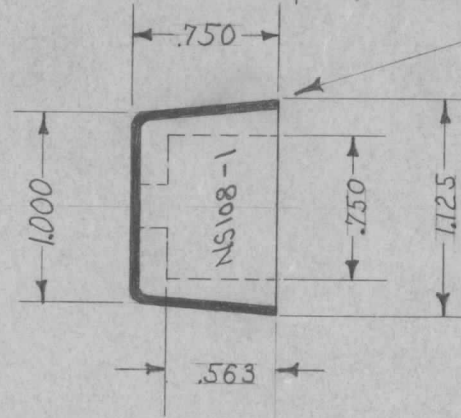
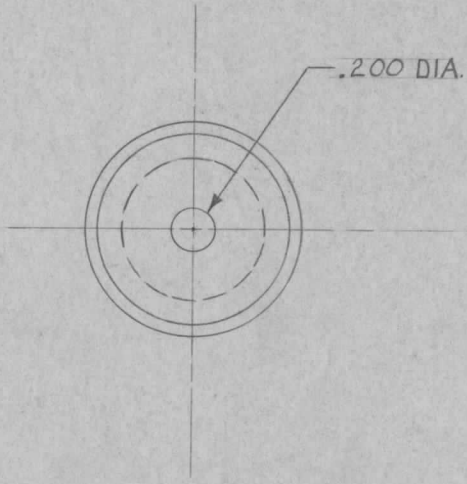

NS-108-1
STAMP AS SHOWN

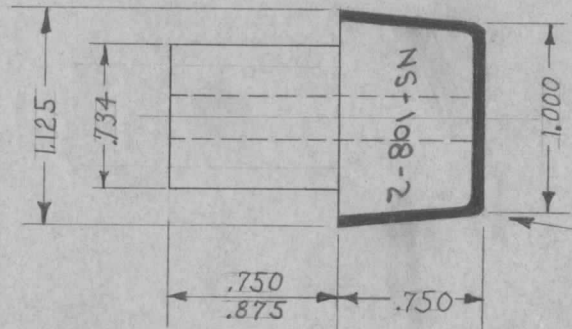

NS-108-2
STAMP AS SHOWN

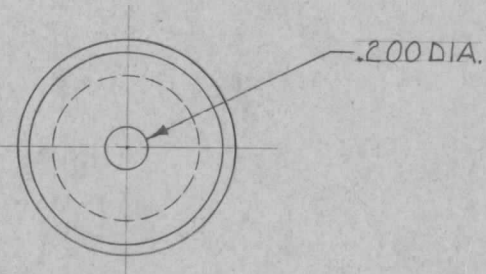

GLAZE IS INDICATED BY HEAVY LINE.

REQ.	ITEM	PART NO.	DESCRIPTION	SYMBOL
			THE TECHNICAL MATERIEL CORP. MAMARONECK, NEW YORK	
		STOCK SIZE	INSULATOR, STEATITE, GLAZED	
		MATERIAL	ENT LEAD IN.	
		WEIGHT PER PC.		
		TYPE & TEMPER	F.M. 7/30/53	ARB
			DRAWN	ELEC. DES. APP. MECH. DES. APP.
			LAD 7-30-53	ARB
		HEAT TREAT. SPEC.	CHECKED	FINAL APPROVAL
		FINISH & SPEC. NO.	L4 WHITE GLAZE	Supersedes ENG 1-240
				NS-108

ISSUE	ITEM	CHANGED FROM	DATE	CN. NO.	DRAFTS	CHECKER	ENG. APP.

TOLERANCES		SCALE
ALL OTHERS	DEC. DIM. ± FRAC. DIM. ± ANGULAR DIM. ±	DRILL, PUNCH, COMMERCIAL STOCK SIZES AND MANUFACTURERS TOLERANCES ARE NOT INCLUDED.