

REVISIONS							
ZONE	LTR	DESCRIPTION	DATE	E.M.N.NO	DRAFT	CHKD	APPD
	Ø	ORIGINAL RELEASE FOR PRODUCTION	11/24/09		RG		

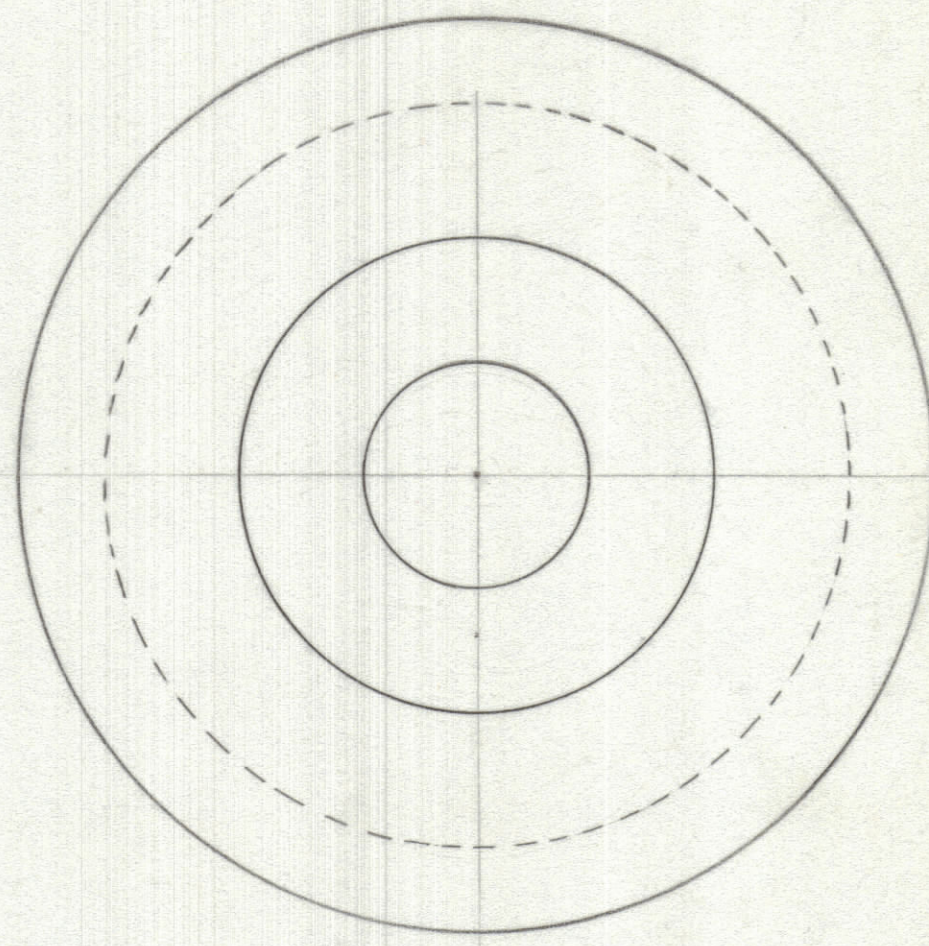
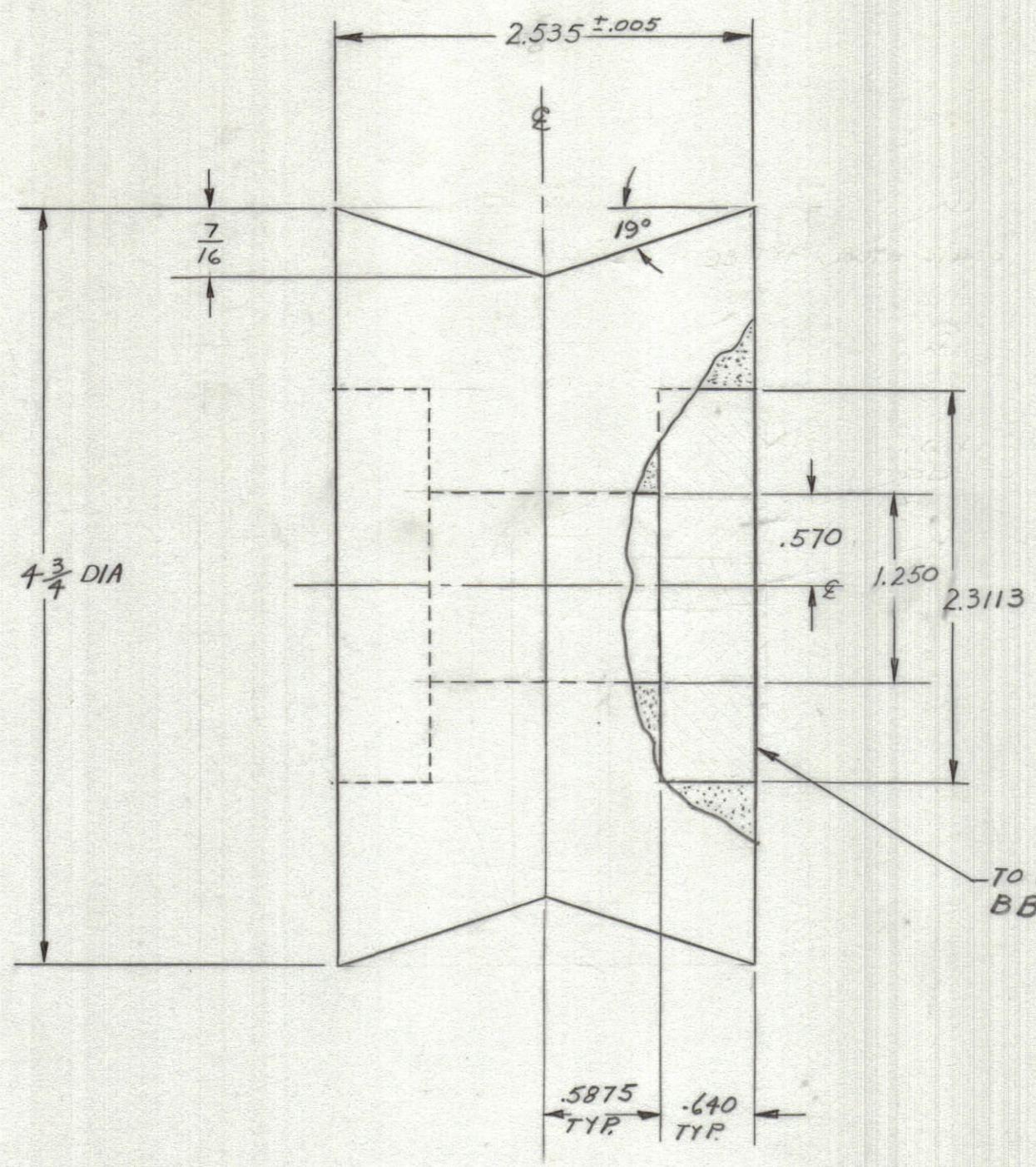

TO FIT BEARING SUPPLIED
BB-130 BQ. CAT 59 #713

FRONT VIEW

SIDE VIEW

MATERIAL
4340 STEEL MIL-S-5000
HEAT TREAT TO 280,000 PSI

2	UNIT 4	
QTY / UNIT	MODEL USED ON	ASS'Y NO.
APPLICATION		
	CODE	
NOTICE TO PERSONS RECEIVING THIS DRAWING		
THE TECHNICAL MATERIEL CORPORATION claims proprietary right in the material disclosed hereon. This drawing is issued in confidence for engineering information only and may not be reproduced or used to manufacture anything shown hereon without permission from THE TECHNICAL MATERIEL CORPORATION to the user. This drawing is loaned for mutual assistance and is subject to recall at any time.		

UNLESS OTHERWISE SPECIFIED DIMENSIONS ARE IN INCHES AND INCLUDE CHEMICALLY APPLIED OR PLATED FINISHES	
TOLERANCES ON	
DECIMALS	FRACTIONS
.X ± .05	± 1/64
.XX ± .01	ANGLES
.XXX ± .005	± 0° -30'
MATERIAL	SEE ABOVE
FINISH	CADMIUM PLATE

QTY. REQ.	ITEM	PART NO.	DESCRIPTION	SYMBOL
LIST OF MATERIAL				
FINAL APPROVAL <i>[Signature]</i> DATE 11/24/09				
MECH. DES. DATE				
ELECT. DES. DATE				
CHECKED DATE				
DRAWN C.Grob DATE 11/4/08				
THE TECHNICAL MATERIEL CORP. MAMARONECK, NEW YORK				
ANTENNA PYLON PULLEY "A"				
SIZE	CODE	IDENT.NO.	DWG NO.	ISSUE
C	82679		MS8433	Ø
SCALE				SHEET 1 OF 1