

IF IT IS FOUND DESIRABLE TO CHANGE ANY TOLERANCE OR OTHER DETAIL SPECIFIED ON THIS DRAWING NOTIFY THE PURCHASER PROMPTLY.  
 MAXIMUM ALLOWABLE TOLERANCES HAVE BEEN DETERMINED AND DEVIATIONS WILL BE CAUSE FOR REJECTION. REMOVE ALL BURRS AND SHARP EDGES

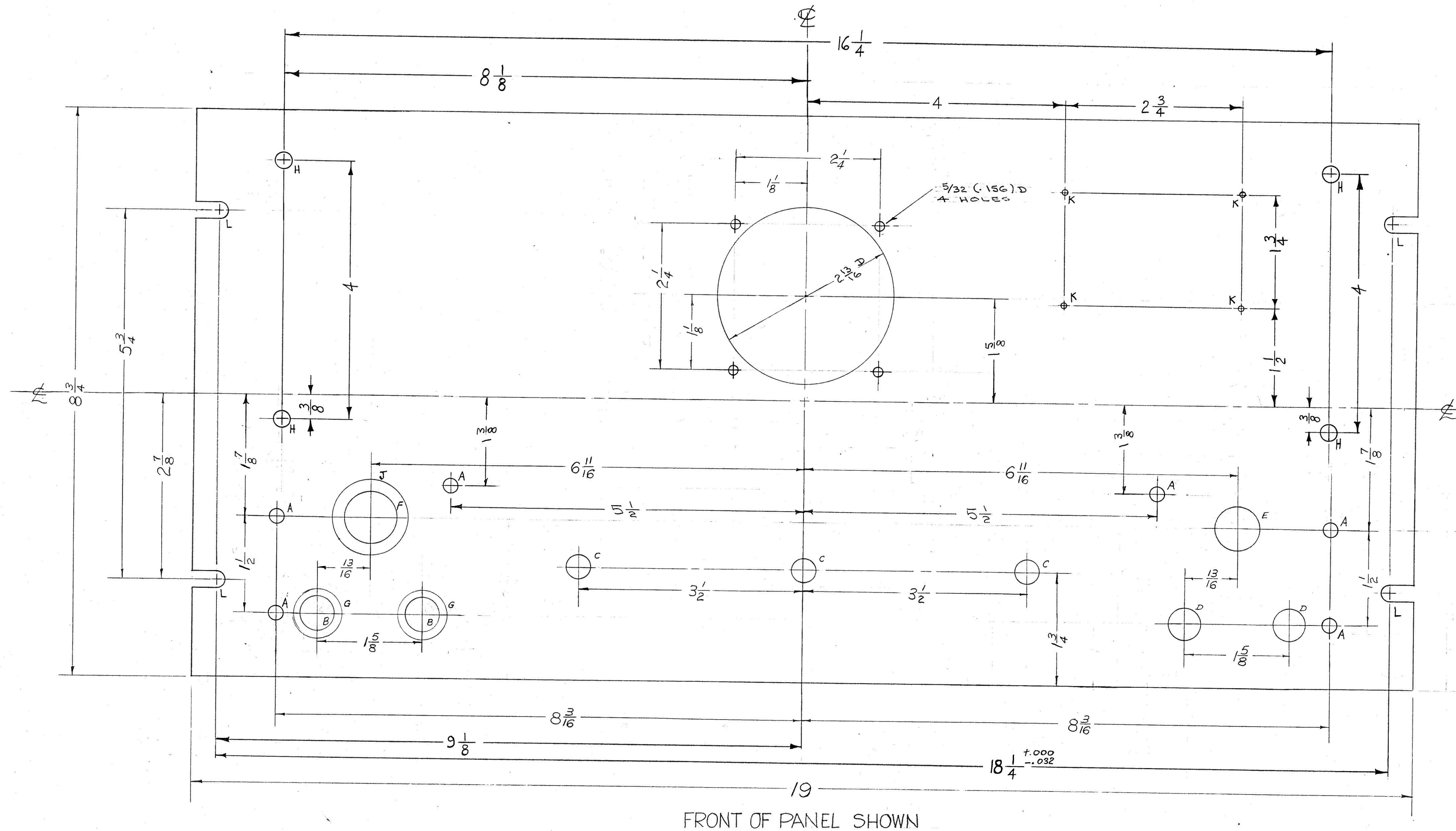

LEGEND

- A - 7/32 (.218) D. 6 HOLES REQ.
- B - 3/64 (.515) D. 2 " "
- C - 25/64 (.390) D. 3 " "
- D - 21/64 (.484) D. 2 " "
- E - 25/64 (.703) D. 1 " "
- F - 27/32 (.843) D. 1 " "
- G - COUNTER BORE 3/4 D. x 1/16 DEEP 2 REQ.
- H - 1/4 DIA. 4 REQ.
- J - COUNTER BORE 1/4 x 1/16 DEEP 1 REQ.
- K - #47 DRILL 4 REQ.

NOTE FINISH: -

- S-404 YEL. IRIDITE
  - S-114 - ZINC CHROMATE PRIMER
  - S-115 - SMOOTH GRAY ENAMEL
- OR - PRIME & PAINT TO CUSTOMERS SPECIFICATION.

FRONT & EDGES ONLY

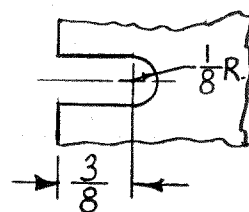

PROPERTY OF THE TECHNICAL MATERIEL CORPORATION  
 MAMARONECK, NEW YORK

ISSUE	ITEM	CHANGED FROM	DATE	CN. NO.	DRAFTS	CHECKER	ENG. APP.
F	1	DWG REVISED	11-9-60	3416	MS	JOB	EMN
E	1	S-404 YEL. IRIDITE WAS 5-101 CAUSTIC DIP	10/15/59	1001	AB		EMN
D	1	3" C BORE 1 1/4 x 1/16	10/15/59	4	ANB		EMN
C	1	1/8" TOL. ADDED	8/15/59	3	EDS		EMN
B	1	6" WAG 3/4 D. x 1/8"	5-6-54	2	MS		EMN
A	3	LEGEND CLARIFIED	11-15-60	1	B		EMN
A	2	6 1/16 WAS 6 3/4					
A	1	1 7/8 & 1 1/2 WERE 1 3/4					

TOLERANCES		SCALE:
ALL DEC. DIM. ±	DRILL, PUNCH, COMMERCIAL STOCK	
OTHERS FRACTIONAL DIM. ± 1/64	SIZES AND MANUFACTURERS	
ANGULAR DIM. ±	TOLERANCES ARE NOT INCLUDED.	

REF: LD-239

REQ. ITEM	PART NO.	DESCRIPTION	SYMBOL
3/16 THK.		THE TECHNICAL MATERIEL CORP. MAMARONECK, NEW YORK	
ALUMINUM		FRONT PANEL MACHINING	
MATERIAL	WEIGHT PER PC.	RTC	
24S-73			
TYPE & TEMPER	DATE	DRAWN	ELEC. DES. APP.
	12/6/55	EMN	EMN
HEAT TREAT. SPEC.	CHECKED		FINAL APPROVAL
SEE NOTE			
FINISH & SPEC. NO.			

REQ. PER UNIT	MODEL	PROJECT NO.	ASSY. NO.	DATE
1	RTC			12/6/55

MS-731 F

