

APPLICATION

QTY 1
 MODEL USED ON GPR110
 ASS'Y NO. BMAS5

LTR

DESCRIPTION

DATE

E.M.N.NO

DRAFT

CHKD

APPD

Ø ORIGINAL RELEASE HPT ~

*

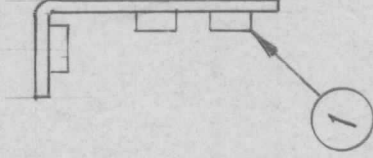
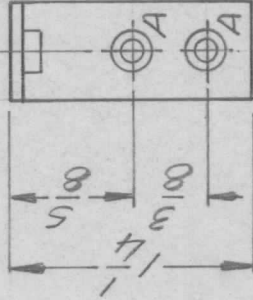
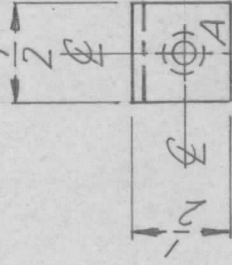

MOUNT AS SHOWN

HOLE DESCRIPTION REQ.

A — .191 — 194 DIA. — 3

REQ'D	ITEM	PART NUMBER	DESCRIPTION	SYM.
3	1	NT1290632	NUT, ROUND	A
F. BUDETTI LIST OF MATERIAL				
FINAL APPROVAL		DATE	THE TECHNICAL MATERIEL CORP.	
MECH. DES.		DATE	MAMARONECK, NEW YORK	
ELECT. DES.		DATE	BRACKET, SUPPORT	
CHECKED		DATE		
DRAWN		DATE		

UNLESS OTHERWISE SPECIFIED DIMENSIONS ARE IN INCHES AND INCLUDE CHEMICALLY APPLIED OR PLATED FINISHES

DECIMALS FRACTIONS
 .X ± .05 1/64
 .XX ± .01 TOLS. ANGLES
 .XXX ± .005 0° - 30'

MATERIAL. 06L4 ALUM
 5052 H32

FINISH 5404
 YEL. IRIDITE

NOTICE TO PERSONS RECEIVING THIS DRAWING
 THE TECHNICAL MATERIEL CORPORATION claims proprietary right in the material disclosed hereon. This drawing is issued in confidence for engineering information only and may not be reproduced or used to manufacture anything shown hereon without permission from THE TECHNICAL MATERIEL CORPORATION to the user. This drawing is loaned for mutual assistance and is subject to recall at any time.

SIZE A
 CODE IDENT. NO. 82679
 DWG NO. MS 6502
 SCALE 1:1
 SHEET OF