

REVISIONS						
ZONE	LTR	DESCRIPTION	DATE	DRAFT	CHK'D	APPD
S		SEE SHEET 1 OF 5	11/4/73	ESP	EF	

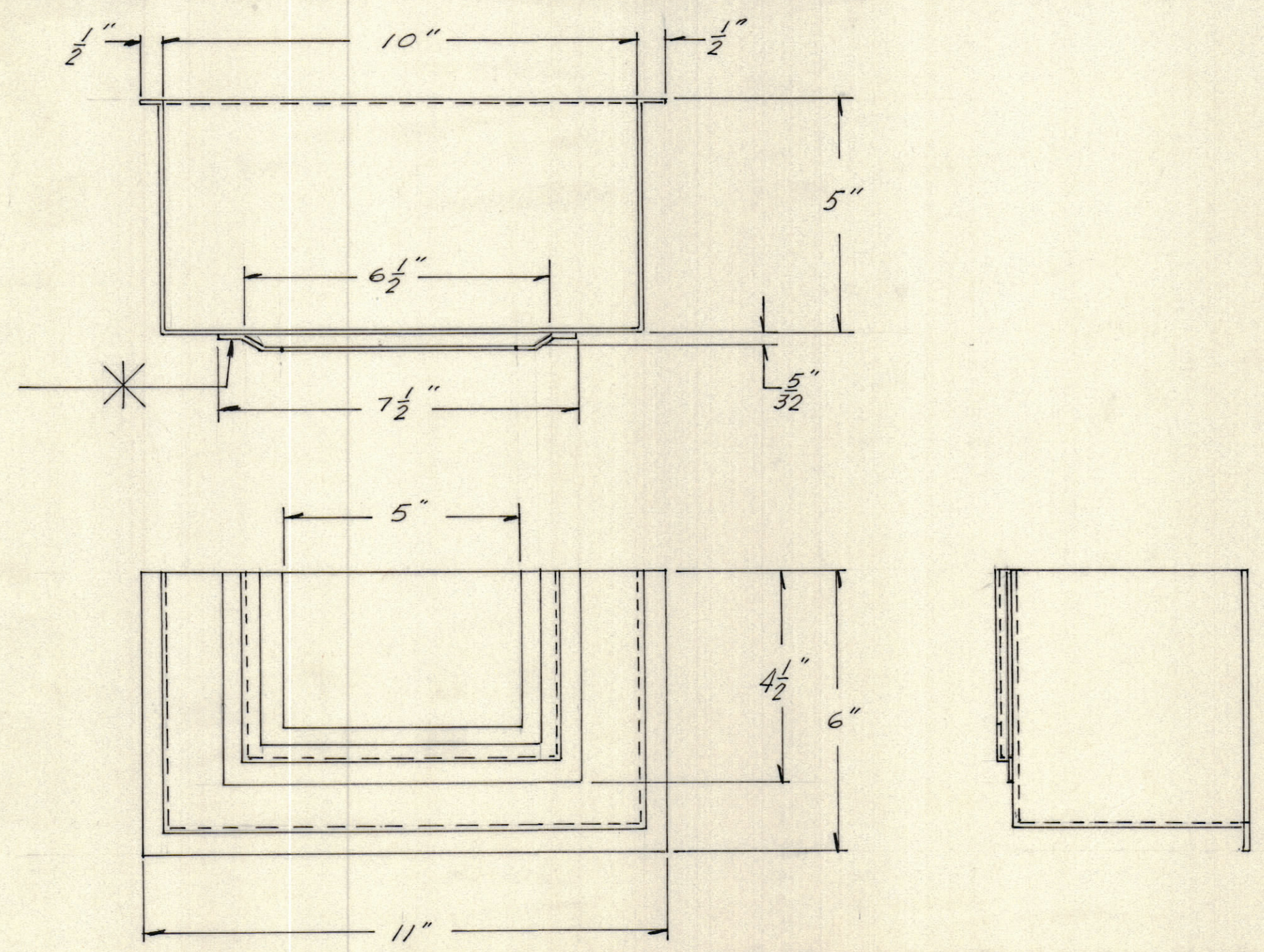
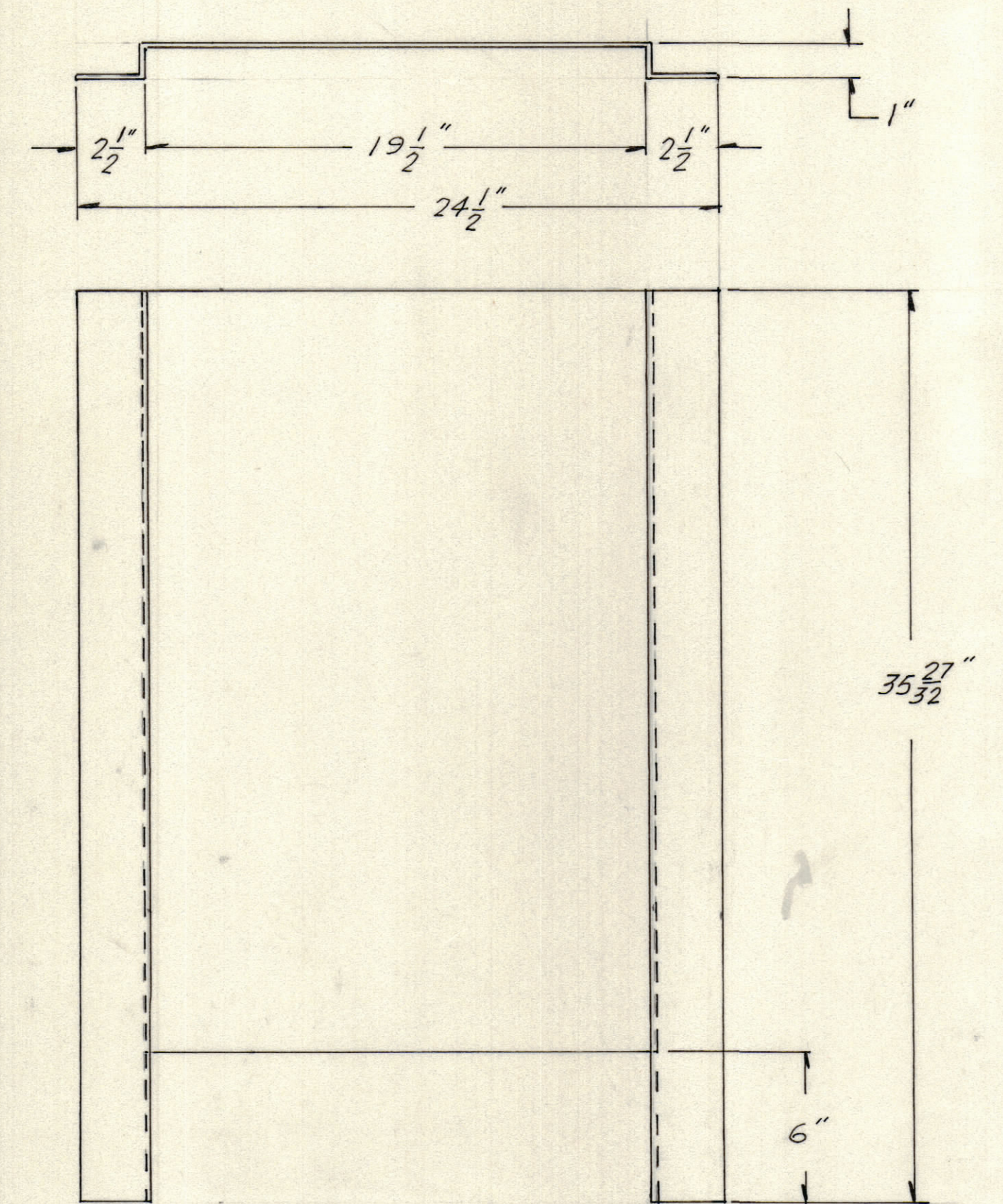
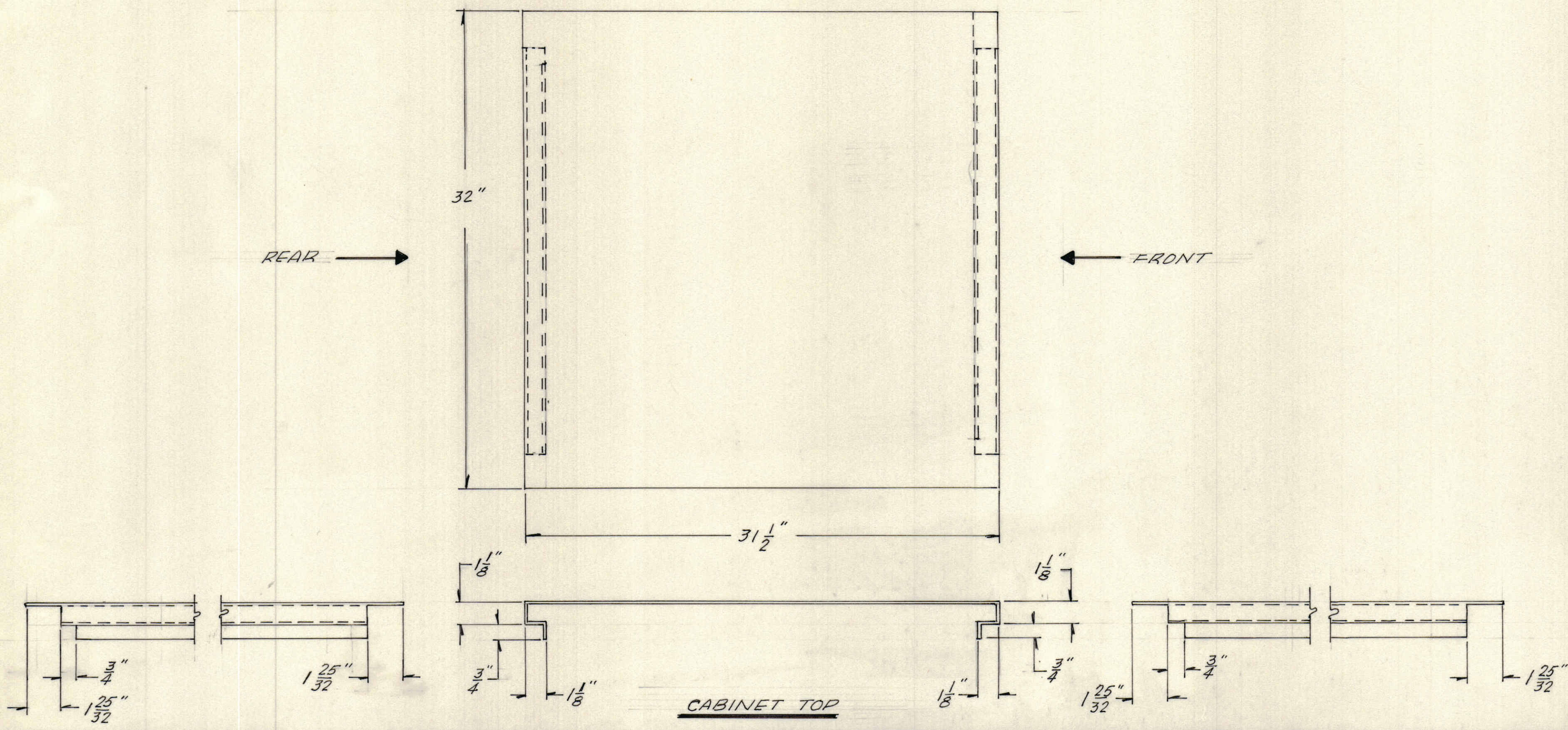

NOTES:  
1. REFER TO DWG. FOR CONTROL CABINET FABRICATION ASSEMBLY

QTY REQ	QTY REQ	QTY REQ	ITEM	PART NO.	MANUFACTURER	DESCRIPTION	SYM
				PARTS LIST			
				THE TMC SYSTEMS AND POWER CORPORATION SPRINGFIELD, VIRGINIA			
				CONTROL CABINET FABRICATED PARTS DETAILS			
				SIZE	CODE IDENT NO	DWG. NO.	REV
				D	24146	MS6133	S
				SCALE	NONE		SHEET 3 OF 5

**INTERPRET DRAWING PER LISTED DOCUMENTS**

DIMENSIONING  
MIL - STD - 8  
SURFACE ROUGHNESS  
MIL - STD - 10  
ABBREVIATIONS  
MIL - STD - 12  
ELECTRONIC SYMBOLS  
MIL - STD - 15  
WELDING SYMBOLS  
JAN - STD - 19

**APPLICATION**

**NOTICE TO PERSONS RECEIVING THIS DRAWING**  
THE TMC SYSTEMS AND POWER CORPORATION claims proprietary right in the material disclosed hereon. This drawing is issued in confidence for engineering information only and may not be reproduced or used to manufacture anything shown hereon without permission from THE TMC SYSTEMS AND POWER CORPORATION to the user. This drawing is loaned for mutual assistance and is subject to recall at any time.

UNLESS OTHERWISE SPECIFIED DIMENSIONS ARE IN INCHES AND INCLUDE CHEMICALLY APPLIED OR PLATED FINISHES REMOVE ALL BURRS AND SHARP EDGES

**TOLERANCES ON**

FRACTIONS ANGLES DECIMALS  
SEE SH. 1

**MATERIAL**  
.075 (14GA.)  
COLD ROLLED STEEL

**FINISH**  
PER TMC SPEC. P. 4

DRAWN FRAMPTON DATE 11-5-73  
CHECKED [initials] DATE 11-5-73  
D. ENG. [initials] DATE 12-7-73  
P. ENG. ESP DATE 12-11-73  
P. MGR. DATE  
CHIEF, ENG. DEPT. [initials] DATE 12-11-73