

REVISIONS							
E.M.N. NO.	DRAFT	CHKD	ZONE	LTR	DESCRIPTION	DATE	APPROVED
20575	GE	AP		C	REDRAWN FOR CLARITY	4-13-72	ES
20949	EE			D	ASTERISKS ADD. TO NON CRITICAL DIMS.	11/13/72	ES
11831	QTB			E	SEE SHEET 3	11-10-80	

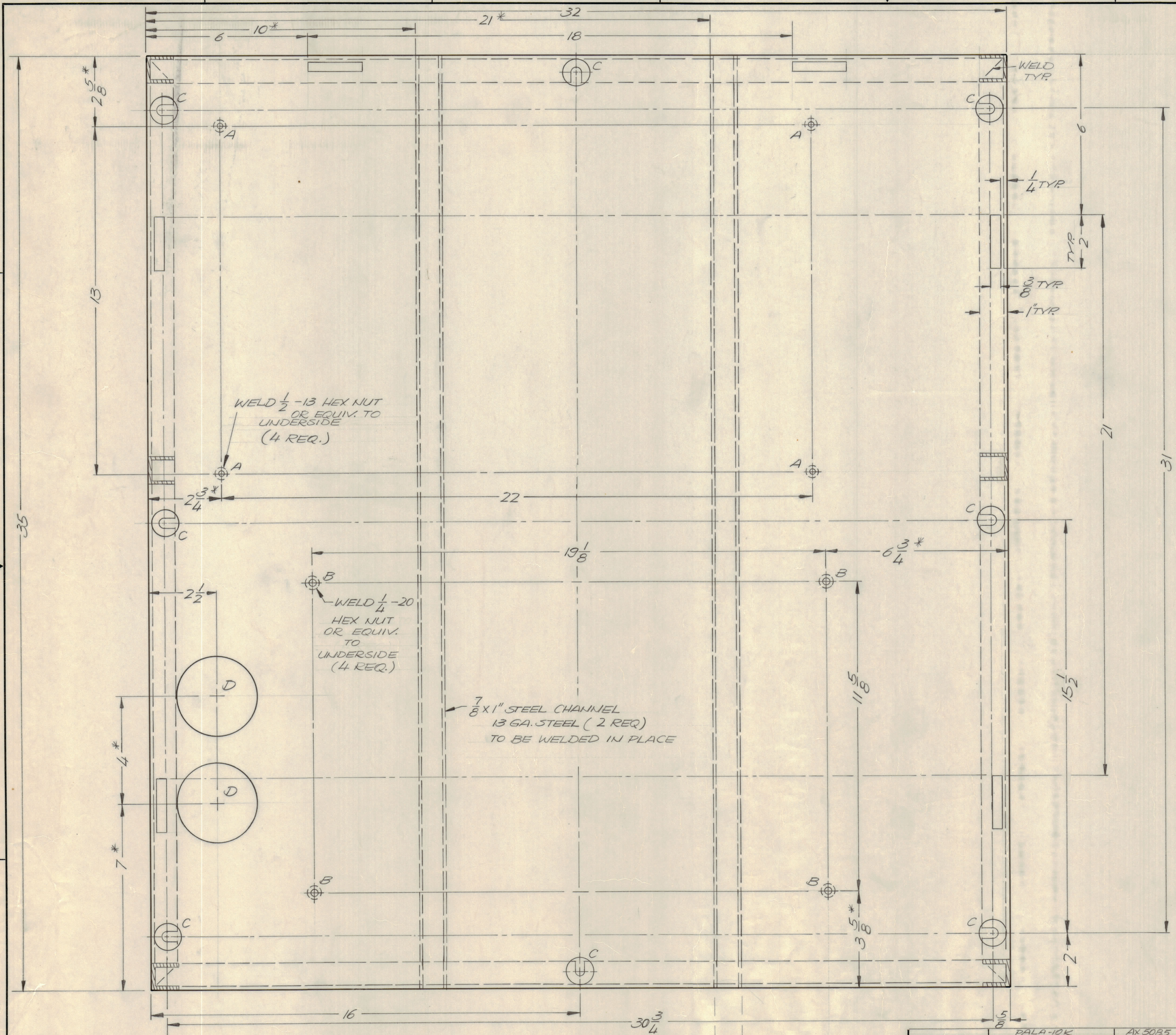

NOTE: DIMENSIONS WITH ASTERISKS (*) ARE NON CRITICAL TOLERANCE ± 1/16

HOLE DESCRIPTION QTY

A	9/16 DIA.	4
B	5/16 DIA.	4
C	SEE DETAIL C	8
D	3" DIA.	2

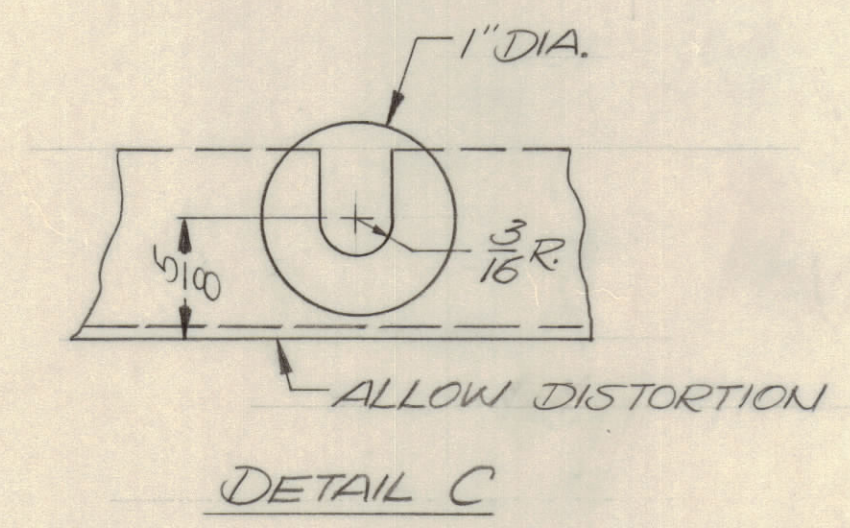

SECTION E-E FRONT

QTY. REQ.	ITEM	PART NO.	DESCRIPTION	SYMBOL		
F.B. LIST OF MATERIAL						
UNLESS OTHERWISE SPECIFIED DIMENSIONS ARE IN INCHES AND INCLUDE CHEMICALLY APPLIED OR PLATED FINISHES		FINAL APPROVAL	DATE	THE TECHNICAL MATERIEL CORP. MAMARONECK, NEW YORK FRAME 10K P.S. DECK		
TOLERANCES ON		MECH. DES.	DATE			
DECIMALS .X ± .05		ELECT. DES.	DATE			
FRACTIONS 1/64 ± .01		CHECKED	DATE			
ANGLES .XXX ± .005		DRAWN	DATE			
MATERIAL 13 GA CRS EXCEPT AS NOTED		GE	4.12.72			
FINISH COPPER FLASH & CLEAR IRIDITE						
QTY / UNIT		SIZE	CODE	IDENT NO.	DWG NO.	ISSUE
		D	82679	MS 5530		E
		SCALE 1/2		SHEET 2 OF 7		

QTY / UNIT	MODEL USED ON	ASS'Y NO.
	DALA-10K	AX 5095
APPLICATION		
CODE		
<small>NOTICE TO PERSONS RECEIVING THIS DRAWING</small> <small>THE TECHNICAL MATERIEL CORPORATION claims proprietary right in the material disclosed herein. This drawing is issued in confidence for engineering information only and may not be reproduced or used to manufacture anything shown herein without permission from THE TECHNICAL MATERIEL CORPORATION to the user. This drawing is loaned for mutual assistance and is subject to recall at any time.</small>		

QTY/UNIT	HFL()-10KREVA	AX 5163
	M/L/O	ASSY NO.