

REVISIONS							
ZONE	LTR	DESCRIPTION	DATE	E.M.N. NO.	DRAFT	CHKD	APPD
X		EXP. RELEASE	6/10/69			K. H. [Signature]	
Ø		ORIGINAL RELEASE	5/18/69			[Signature]	

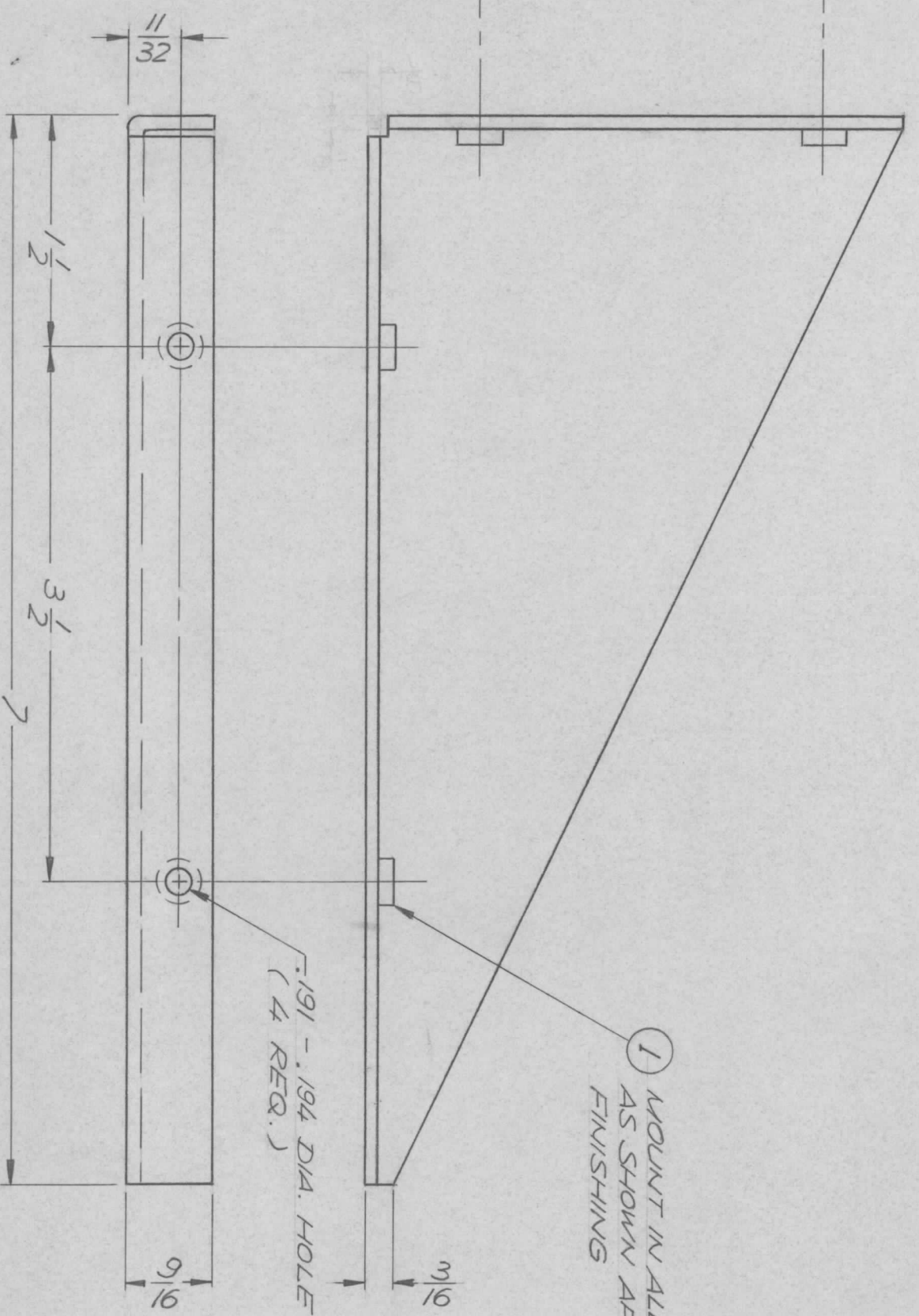
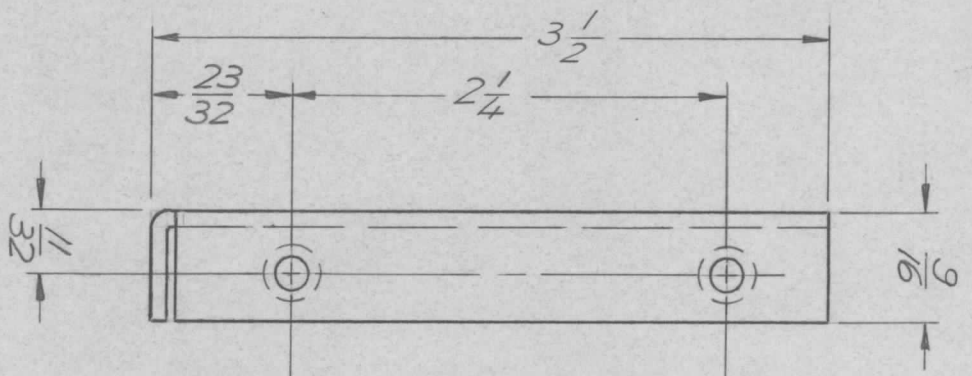

- UNLESS OTHERWISE SPECIFIED:
1. USE MATERIAL THICKNESS FOR MAXIMUM RADIUS ON ALL BENDS.
 2. ALL ANGULAR BENDS 90 DEGREES.
 3. REMOVE ALL BURRS AND SHARP EDGES.
 4. MOUNT INSERTS AFTER FINISHING.

QTY / UNIT	2	MODEL USED ON	RTTD - 4	ASS'Y NO.	SUB. ASSY
APPLICATION					
CODE					

NOTICE TO PERSONS RECEIVING THIS DRAWING
 THE TECHNICAL MATERIEL CORPORATION claims proprietary right in the material disclosed hereon. This drawing is issued in confidence for engineering information only and may not be reproduced or used to manufacture anything shown hereon without permission from THE TECHNICAL MATERIEL CORPORATION to the user. This drawing is loaned for mutual assistance and is subject to recall at any time.

DECIMALS	X ± .05	TOLS.	FRACTIONS	1/64
	.XX ± .01		ANGLES	90° - 30°
	.XXX ± .005			
MATERIAL				
.081 ALUM.				
5052 - H32				
FINISH				
S404				
YELL. IRIDITE				

REQ'D ITEM	4	PART NUMBER	NUT, ROUND, SWAGE TYPE	SYM.
DATE	8-18-69	DATE		
MECH. DES.	[Signature]	DATE		
ELECT. DES.	[Signature]	DATE		
CHECKED	[Signature]	DATE		
DRAWN	[Signature]	DATE		

LIST OF MATERIAL			
THE TECHNICAL MATERIEL CORP.			
MAMARONECK, NEW YORK			
CHASSIS SUPPORT - BRKT			
SIZE	CODE IDENT. NO.	DWG. NO.	ISSUE
B	82679	MS 5491	Ø

SCALE	1:1	SHEET	OF
-------	-----	-------	----