

IF IT IS FOUND DESIRABLE TO CHANGE ANY TOLERANCE OR OTHER DETAIL SPECIFIED ON THIS DRAWING NOTIFY THE PURCHASER PROMPTLY.
 MAXIMUM ALLOWABLE TOLERANCES HAVE BEEN DETERMINED AND DEVIATIONS WILL BE CAUSE FOR REJECTION. REMOVE ALL BURRS AND SHARP EDGES.

NOTICE TO PERSONS RECEIVING THIS DRAWING

THE TECHNICAL MATERIEL CORPORATION claims proprietary right in the material disclosed herein. This drawing is issued in confidence for engineering information only and may not be reproduced for use in manufacture anything shown hereon without permission from THE TECHNICAL MATERIEL CORPORATION to the user. This drawing is loaned for mutual assistance and is subject to recall at any time.

Property of:
 THE TECHNICAL MATERIEL CORPORATION
 MAMARONECK, NEW YORK

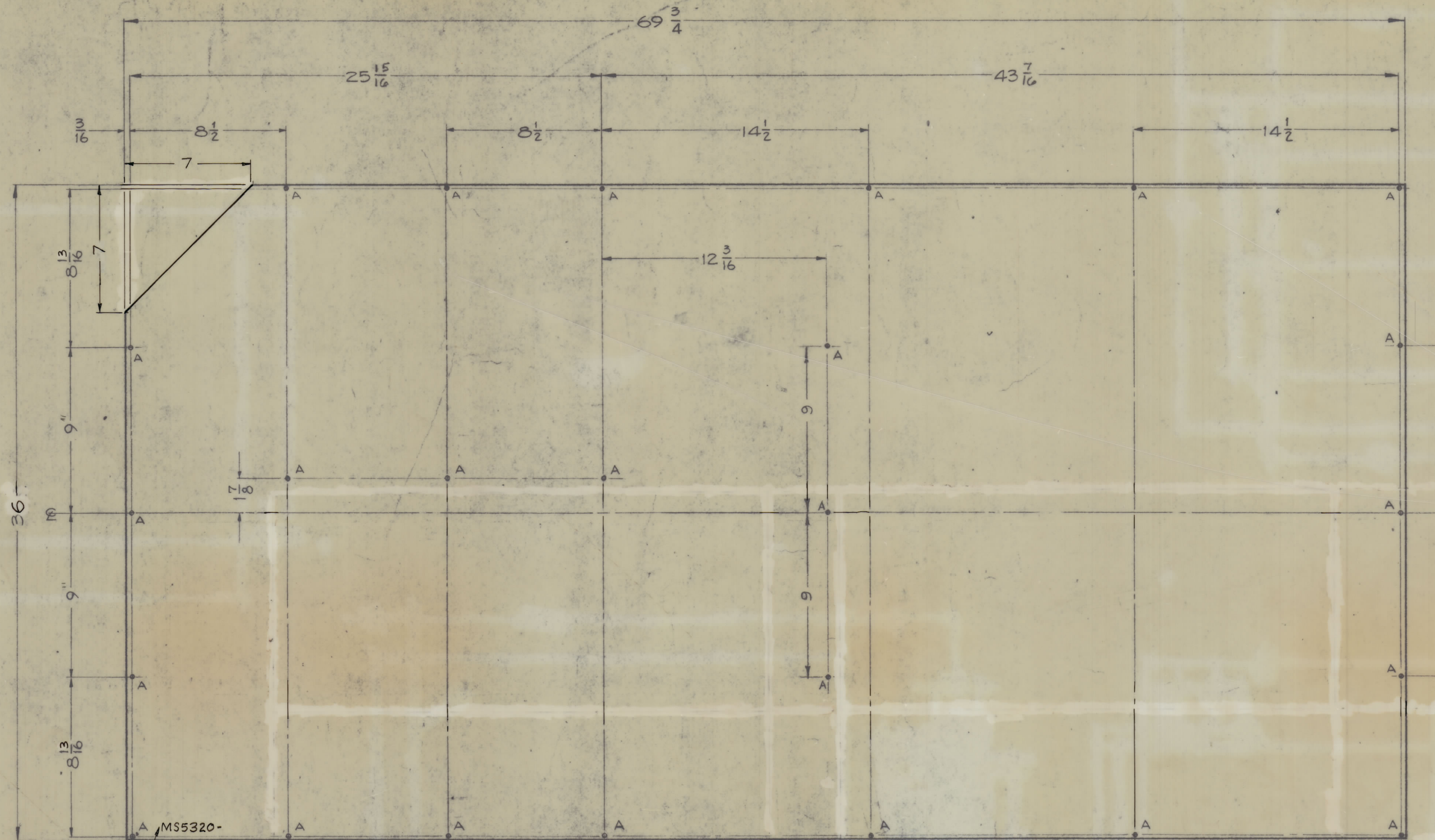

MARK TMC P/N 8 HIGH GOTHIC
 W/LATEST REV. LETTER

HOLES ~
 A ~ 13/64 (.203) DIA. 25 REQ.

MS5320

CHK RELEASE	2-12-68	RG
EXP RELEASE	1-17-68	NA
ISSUE ITEM	CHANGED FROM	DATE
TOLERANCES		SCALE: 1/4 (DO NOT SCALE)
ALL OTHERS	DEC. DIM ± 1/64	DRILL PUNCH COMMERCIAL STOCK
	ANGULAR DIM ±	SIZES AND MANUFACTURERS TOLERANCES ARE NOT INCLUDED.

REQ PER UNIT	MODEL	PROJECT NO.	ASBY. NO.	DATE
	GPT-40KEL			1-17-68
	USED ON			

REF - LD-824			
REQ. ITEM	PART NO.	DESCRIPTION	SYMBOL
	.064	THE TECHNICAL MATERIEL CORP. MAMARONECK, NEW YORK	
STOCK SIZE			
ALUMINUM		SHIELD, EXTERIOR	
MATERIAL	WEIGHT PER PC	RIGHT SIDE, P.S. FRAME	
5052 - H-32			
TYPE & TEMPER			
DRAWN		ELEC. DES. APP.	MECH. DES. APP.
56 1/17/68		OR	SM
CHECKED		FINAL APPROVE	
HEAT TREAT. SPEC			
5404-IRIDITE			
FINISH & SPEC. NO.			
			MS5320