

IF IT IS FOUND DESIRABLE TO CHANGE ANY TOLERANCE OR OTHER DETAIL SPECIFIED ON THIS DRAWING NOTIFY THE PURCHASER PROMPTLY.

MS-502

MAXIMUM ALLOWABLE TOLERANCES HAVE BEEN DETERMINED AND DEVIATIONS WILL BE CAUSE FOR REJECTION. REMOVE ALL BURRS AND SHARP EDGES

REQ. PER UNIT

USED ON

2

MODEL

PROJECT NO.

ASS'Y. NO.

DATE

TAC-1

132

A-718

1-12-54

NICK CORNERS  $\frac{1}{16}$

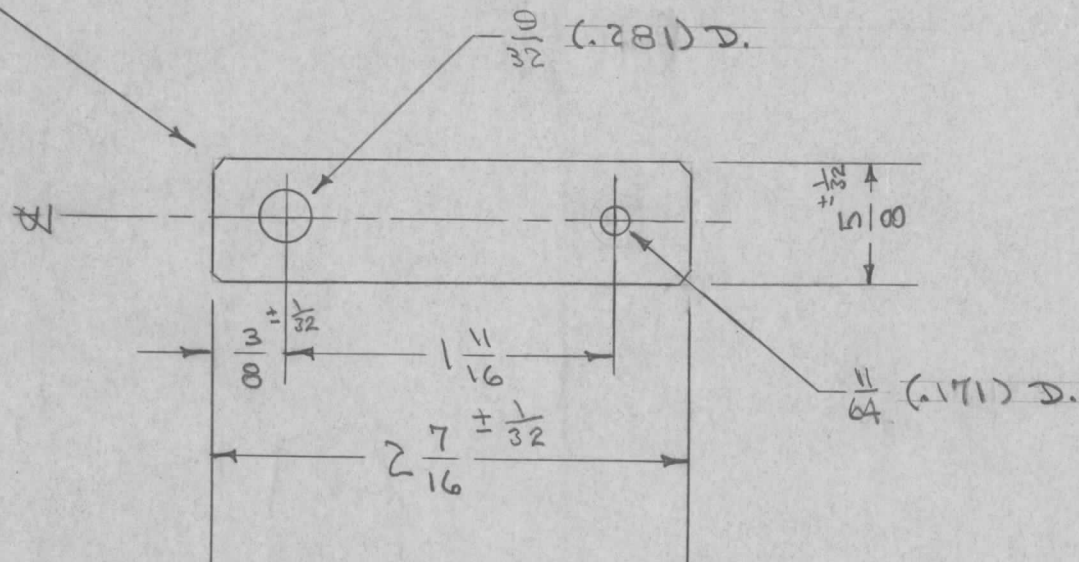

REQ.	ITEM	PART NO.	DESCRIPTION	SYMBOL
			THE TECHNICAL MATERIEL CORP. MAMARONECK, NEW YORK	
		(.032) THK.		
		STOCK SIZE		
		BRASS	STRAP, SPARK GAP	
		MATERIAL		
		WEIGHT PER PC.		
		HALF HARD	TAC-1	
		TYPE & TEMPER	C.D.D.	
			ARB	WSE
			DRAWN	ELEC. DES. APP.
			MECH. DES. APP.	
			HEAT TREAT. SPEC.	
			FINISH & SPEC. NO.	
		S-135 NICKEL PLATE	FINAL APPROVAL	
			MS-502	

ISSUE	ITEM	CHANGED FROM	DATE	CN. NO.	DRAFTS	CHECKER	ENG. APP.

TOLERANCES

SCALE  $\frac{1}{16}$

DRILL, PUNCH, COMMERCIAL STOCK SIZES AND MANUFACTURERS TOLERANCES ARE NOT INCLUDED.

ALL OTHERS  
DEC. DIM.  $\pm$   
FRAC. DIM.  $\pm \frac{1}{64}$   
ANGULAR DIM.  $\pm$