

REQ. PER UNIT	USED ON			MS5018	A
	MODEL	ASS'Y. NO.	DATE		
2	RAK-110-2	BMA156	6-17-66		

① MOUNT IN ALL "B" HOLES, AFTER FINISHING

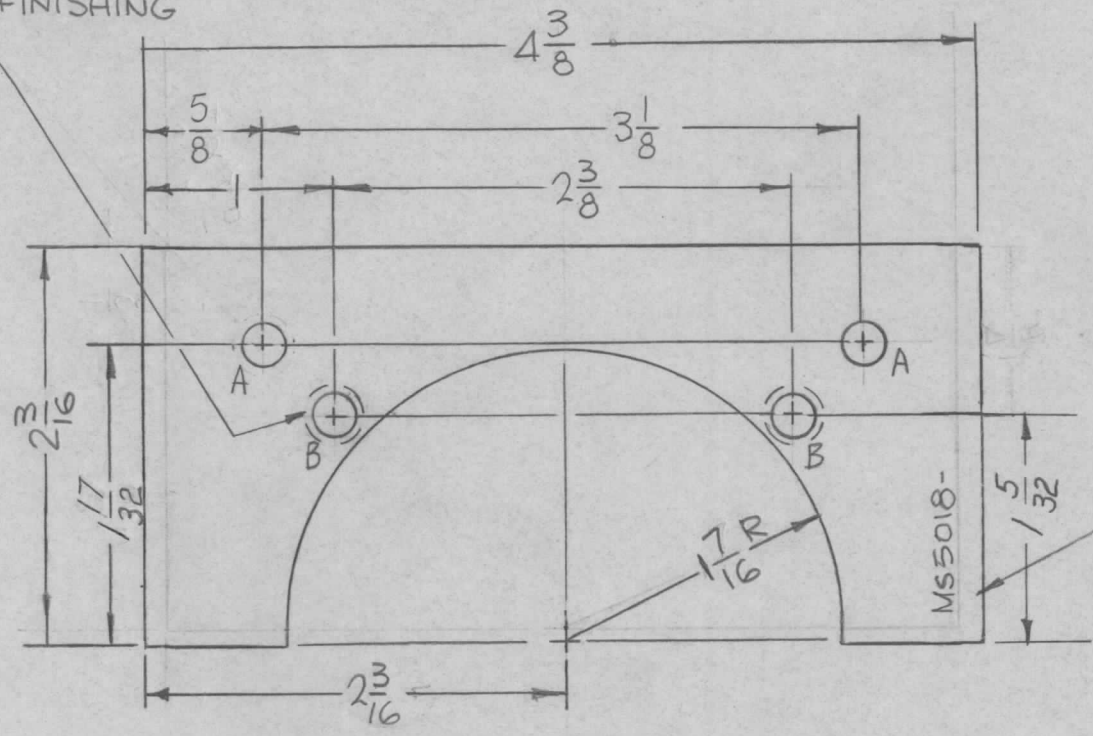

HOLES:
 A - 13/64 DIA. (2 REQ.)
 B - .221-.224 DIA. (2 REQ.)

MARK TMC P/N
 1/8" HIGH GOTHIC
 W/LATEST REV.
 LETTER.

A	1-17/32 WAS 1-9/16. DELETED 1-11/16. ADDED 1-51/32	3-7-67	17926	L.A.K.	<i>[Signature]</i>	2	1	NT129-832-4	NUT, PLAIN, SPLINE	B	
	ORIGINAL RELEASE FOR PRODUCTION					REQ. ITEM	PART NO.	F. BUDETTI DESCRIPTION		SYMBOL	
Q	COMPLETELY RE-DESIGNED	12-1-66		W.H.		.063 THICK		THE TECHNICAL MATERIEL CORP. MAMARONECK, NEW YORK			
X	EXP. RELEASE	6-17-66	X	<i>[Signature]</i>	<i>[Signature]</i>	ALUMINUM		BRACKET, MTG. COAXIAL RELAY			
SYM	DESCRIPTION	DATE	CH. NO.	DRAFTS	CHECKER	ENG. APP.	MATERIAL				
UNLESS OTHERWISE SPECIFIED DIMENSIONS ARE IN INCHES AND INCLUDE CHEMICALLY APPLIED OR PLATED FINISHES		SCALE		1:1		5052-H32		<i>[Signature]</i>	<i>[Signature]</i>	<i>[Signature]</i>	
TOLERANCES		FRACTIONS		CODE		TYPE & TEMPER		HEAT TREAT. SPEC.		DRAWN	
.X ± .05 .XX ± .01 .XXX ± .005		± 1/64 ANGLES ± 0° 30'		A		S520 TEX. VINYL PAINT				ELEC. DES. APP.	
						FINISH & SPEC. NO.		MECH. DES. APP.		MS5018 A	