

REQ. PER UNIT	USED ON			MS4906	Ø
	MODEL	ASS'Y. NO.	DATE		
2	AD129	A5360	4-11-66		

HOLE	DESCRIPTION	REQ'D
A	13/64 DIA	4

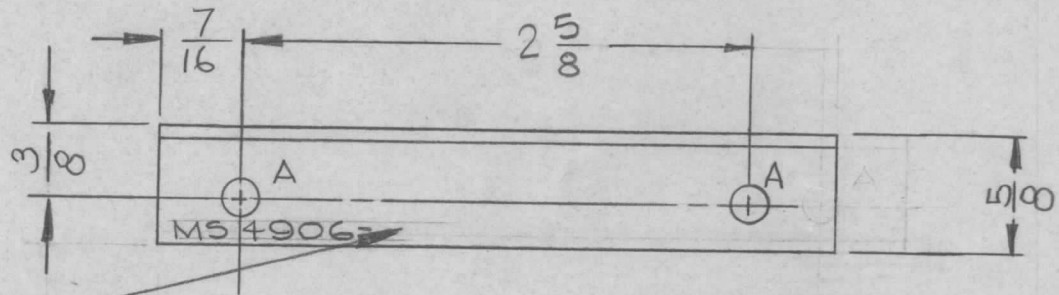

MARK TMC P/N  $\frac{1}{8}$   
HIGH GOTHIC W/LATEST  
REVISION LETTER

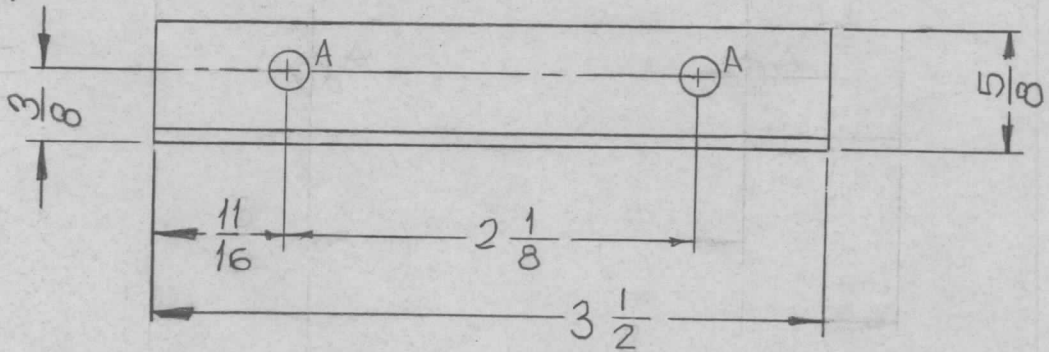

UNLESS OTHERWISE SPECIFIED:

1. USE MATERIAL THICKNESS FOR MAXIMUM RADIUS ON ALL BENDS
2. ALL ANGULAR BENDS 90 DEGREES
3. REMOVE ALL BURRS AND SHARP EDGES

SYM	DESCRIPTION	DATE	CH. NO.	DRAFTS	CHECKER	ENG. APP.	REQ. ITEM	PART NO.	BUDETTI DESCRIPTION	SYMBOL	
Ø	ORIGINAL RELEASE FOR PRODUCTION	12.13.66	#	WFO							
X <sub>1</sub>	3 1/2 WAS 3 7/8, HOLES RELOCATED	5-24-66	X <sub>1</sub>	MKT		WFO		.064	THE TECHNICAL MATERIEL CORP. MAMARONECK, NEW YORK		
X	EXPER. RELEASE	4/13/66	#	WFO	JCS			ALUMINUM	BRACKET, RECT. MTG		
	UNLESS OTHERWISE SPECIFIED DIMENSIONS ARE IN INCHES AND INCLUDE CHEMICALLY APPLIED OR PLATED FINISHES			SCALE							
	DECIMALS .X ± .05 .XX ± .01 .XXX ± .005										
	FRACTIONS ± 1/64 ANGLES ± 0° 30'										
	TOLERANCES			1:1							
							5052-H32		WFO	JCS	WFO
							TYPE & TEMPER	HEAT TREAT. SPEC.	DRAWN	CHECKED	FINAL APPROVAL
							S404-YELLOW IBIDITE		WFO	JCS	WFO
							FINISH & SPEC. NO.		ELEC. DES. APP.	MECH. DES. APP.	MS4906 Ø