

HOLE	DESCRIPTION	REQ'D
A	9/64 DIA.	12
B	SEE DETAIL "B"	4

REVISIONS							
ZONE	SYM	DESCRIPTION	DATE	E.M.N. NO.	DRAFT	CHKD	APPD
Ø		ORIGINAL RELEASE FOR PRODUCTION	1/26/66	H	HAA		

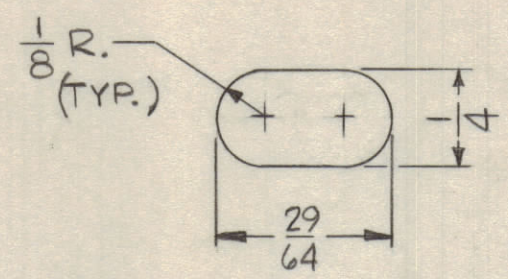

DETAIL "B"  
4 REQ'D.

METAL STAMP TMC PART NO. 1/8  
HIGH GOTHIC ON REAR OF PANEL  
(W/LATEST REV. LETTER)

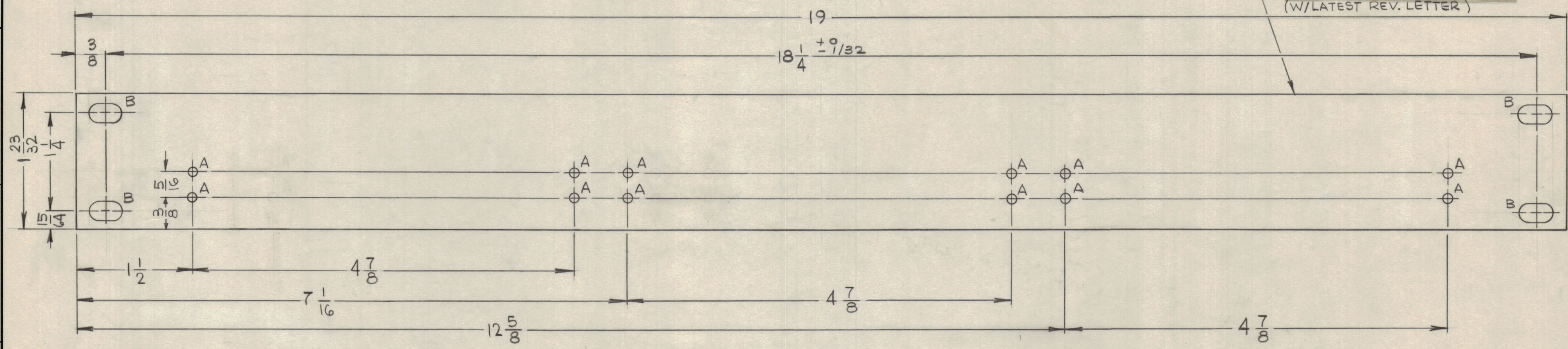

FRONT OF PANEL SHOWN

**MACHINING:**

1. MILL ALL EDGES.
2. HOLES MUST BE DRILLED, UNLESS OTHERWISE SPECIFIED.
3. LATERAL BOW OF PANEL MUST BE KEPT TO .031 TOLERANCE.
4. PANEL MUST BE FREE OF ALL MACHINING MARKS, GOUGES AND SCRATCHES. IF NECESSARY, SAND FRONT OF PANEL WITH NO. 120 GRIT SANDPAPER.

**FINISH NOTES:**

1. S404 - IRIDITE 14-2 AL-COAT.
2. S114 - ZINC CHROMATE PRIMER } FRONT AND
3. S115 - SMOOTH GRAY ENAMEL } EDGES ONLY

**NOTES**

1	CAB-20A	
Q'TY./UNIT	MODEL USED ON	ASS'Y. NO.
SCALE	CODE	

THE CONTENTS OF THIS DRAWING ARE THE EXCLUSIVE PROPERTY OF THE TECHNICAL MATERIEL CORP. ITS UNAUTHORIZED USE OR REPRODUCTION IN WHOLE OR IN PART IS STRICTLY FORBIDDEN.

REF: LD 2053

REQ'D.	ITEM	PART NUMBER	DESCRIPTION	SYMBOL
LIST OF MATERIAL				
MATERIAL			THE TECHNICAL MATERIEL CORP.	
3/16 THK. ALUMINUM-2024-T3			MAMARONECK, NEW YORK	
FINISH			TITLE	
SEE NOTE			PANEL, FRONT	
UNLESS OTHERWISE SPECIFIED DIMENSIONS ARE IN INCHES AND INCLUDE CHEMICALLY APPLIED OR PLATED FINISHES		DRAWN H. AUSTIN		
DECIMALS		DATE 1-21-66		
.X ± .05		CHECKED HAA		
.XX ± .01		DATE 1-26-66		
.XXX ± .005		ELECT. DES.		
TOLERANCES		DATE 1-26-66		
FRACTIONS ± 1/64		MECH. DES.		
ANGLES ± 0° 30'		DATE 1-26-66		
		SHEET		
		REV. LTR.		

MS4868