

REVISIONS							
ZONE	SYM	DESCRIPTION	DATE	E.M.N. NO.	DRAFT	CHKD	APPD
	A	ORIGINAL RELEASE FOR PRODUCTION	8/16				
	A	CLERICAL CHANGE	9/2/65				

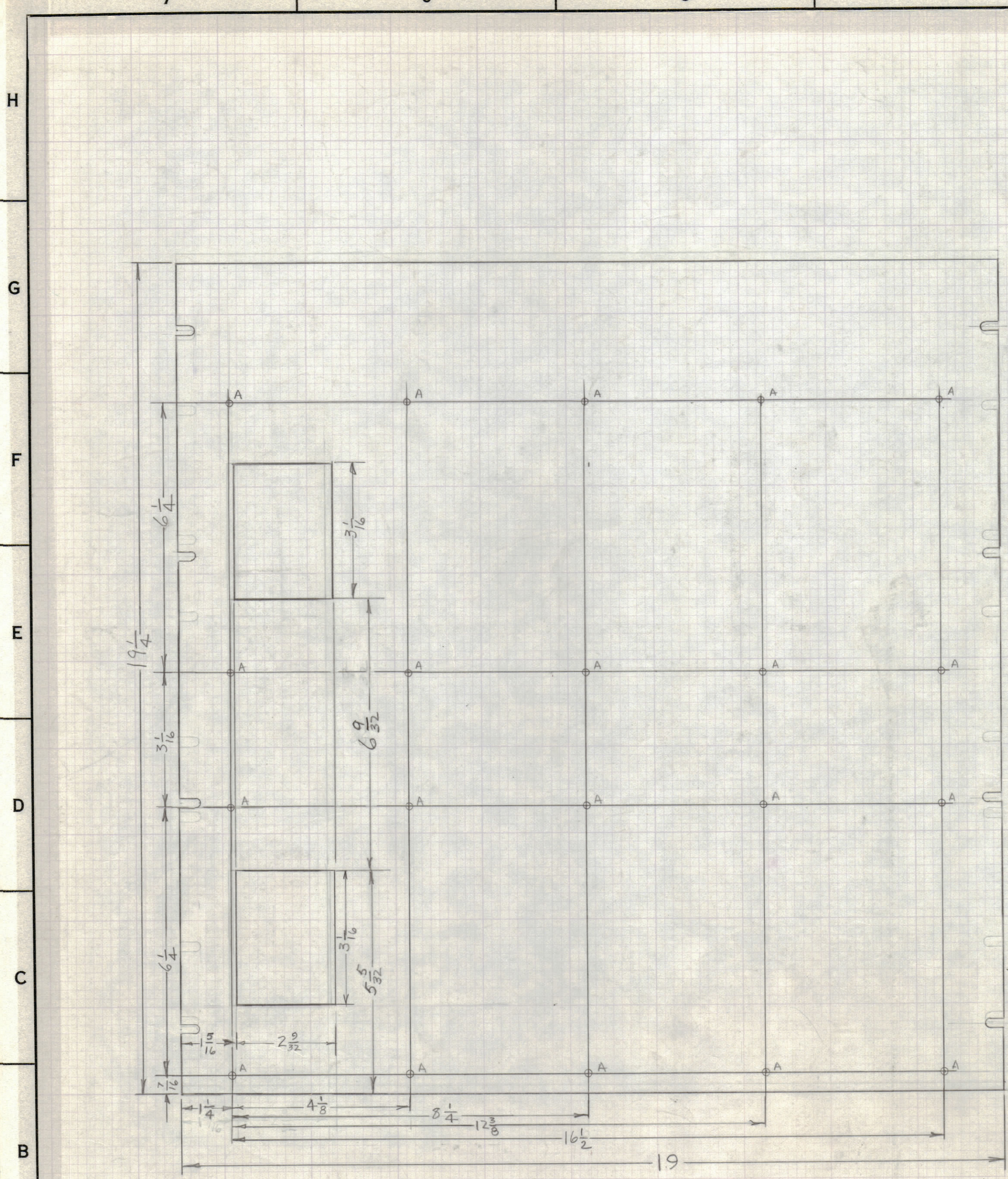

HOLES
A - 11/64 DIA. REQ
20

MS4629 A

MACHINING:

1. MILL ALL EDGES.
2. HOLES MUST BE DRILLED, UNLESS OTHERWISE SPECIFIED.
3. LATERAL BOW OF PANEL MUST BE KEPT TO .031 TOLERANCE.
4. PANEL MUST BE FREE OF ALL MACHINING MARKS, GOUGES AND SCRATCHES. IF NECESSARY, SAND FRONT OF PANEL WITH NO. 120 GRIT SANDPAPER.

FINISH NOTES:

1. S404 - IRIDITE 14-2 AL-COAT.
2. S114 - ZINC CHROMATE PRIMER FRONT AND
3. S115 - SMOOTH GRAY ENAMEL EDGES ONLY
4. OR PRIME AND PAINT TO CUST. SPEC.

QTY./UNIT	1	MODEL USED ON	DDRR-506	ASS'Y. NO.	A5108
SCALE	1" = 1"	CODE	A		
THE CONTENTS OF THIS DRAWING ARE THE EXCLUSIVE PROPERTY OF THE TECHNICAL MATERIEL CORP. ITS UNAUTHORIZED USE OR REPRODUCTION IN WHOLE OR IN PART IS STRICTLY FORBIDDEN.					

NOTES

REQ'D.	ITEM	PART NUMBER	DESCRIPTION	SYMBOL
STURMER LIST OF MATERIAL				
MATERIAL		3/16 THICK ALUMINUM, 2024-T3		
FINISH		SEE NOTES		
TITLE		PANEL, FRONT		
DRAWN		M. STURMER	DATE	8/16/65
CHECKED		JTB	DATE	8-9-65
ELECT. DES.			DATE	
MECH. DES.		m.p.	DATE	8-9-65
UNLESS OTHERWISE SPECIFIED DIMENSIONS ARE IN INCHES AND INCLUDE CHEMICALLY APPLIED OR PLATED FINISHES		REV. LTR.		
DECIMALS .X ± .05 .XX ± .01 .XXX ± .005		FRACTIONS ± 1/64 ANGLES ± 0° 30'		MS4629 A
SHEET		REV. LTR.		