

MS4611 Ø

REVISIONS

SYM	DESCRIPTION	DATE	E.M.N. NO.	DRAFT	CHKD	APPD
Ø	ORIGINAL RELEASE FOR PRODUCTION	3-14-66	Ø	HGA		JG

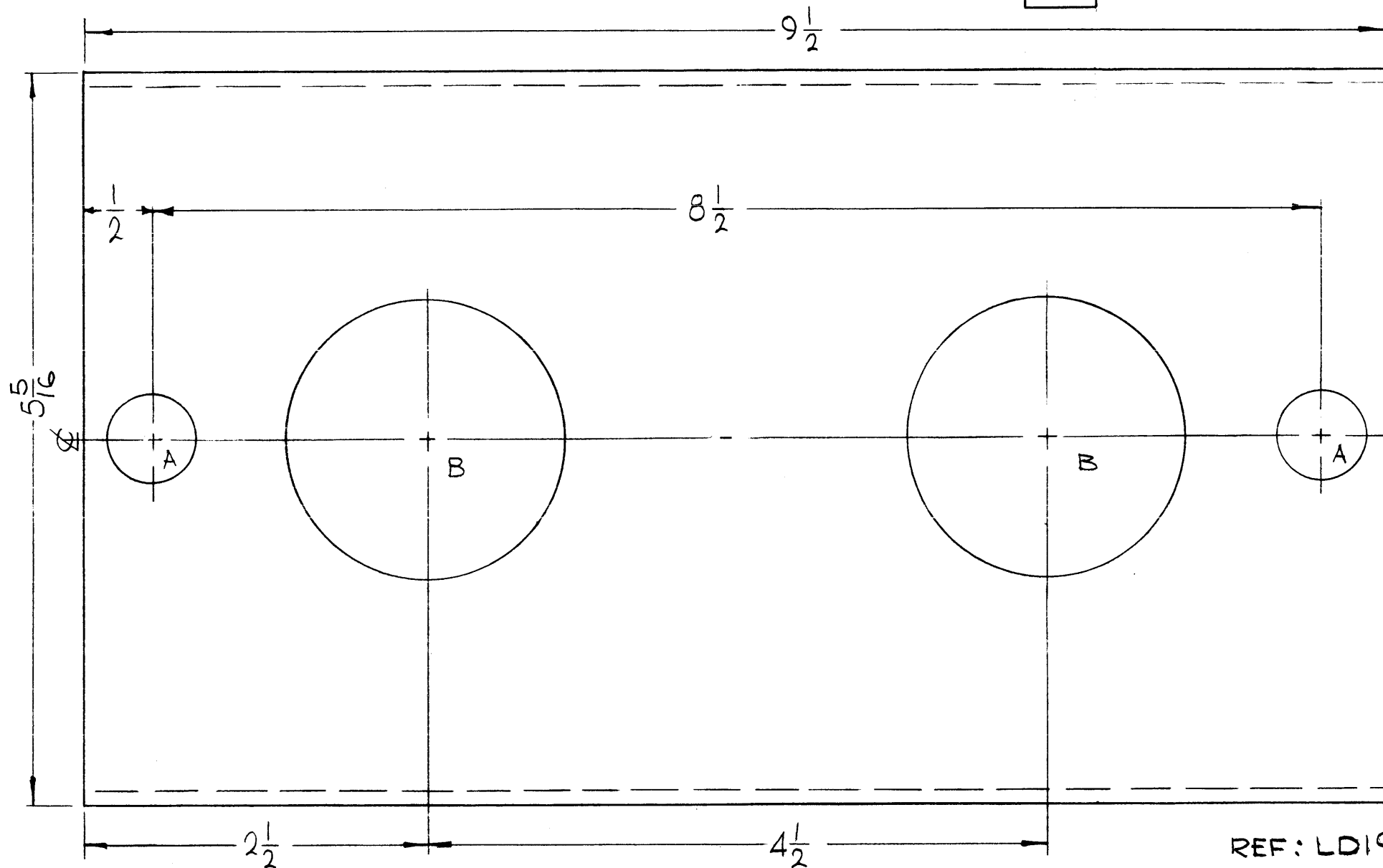

HOLES:
 A - 5/8 DIA. (2 REQ)
 B - 2 DIA. (2 REQ)

MARK TMC
 PART NO. (MS4611-)
 1/8 HIGH GOTHIC
 W/LATEST REV. LETTER.

REF: LD1930

UNLESS OTHERWISE SPECIFIED:

1. USE MATERIAL THICKNESS FOR MAXIMUM RADIUS ON ALL BENDS
2. ALL ANGULAR BENDS 90 DEGREES
3. REMOVE ALL BURRS AND SHARP EDGES

NOTES

1	TST () 10K	
Q'TY./UNIT	MODEL USED ON	ASS'Y. NO.
SCALE III	CODE A	
THE CONTENTS OF THIS DRAWING ARE THE EXCLUSIVE PROPERTY OF THE TECHNICAL MATERIEL CORP. ITS UNAUTHORIZED USE OR REPRODUCTION IN WHOLE OR IN PART IS STRICTLY FORBIDDEN.		

REQ'D.	ITEM	PART NUMBER	DESCRIPTION	SYMBOL
F. BUDETTI LIST OF MATERIAL				
MATERIAL 1/8 THICK ALUMINUM 5052 - H 32			THE TECHNICAL MATERIEL CORP. MAMARONECK, NEW YORK	
FINISH S404 YEL. IRIDITE			TITLE PLATE, MTG. XFMR	
UNLESS OTHERWISE SPECIFIED DIMENSIONS ARE IN INCHES AND INCLUDE CHEMICALLY APPLIED OR PLATED FINISHES			DRAWN <i>[Signature]</i>	DATE 6-3-65
			CHECKED <i>[Signature]</i>	DATE 3-9-66
			ELECT. DES. <i>[Signature]</i>	DATE 3-14-66
			MECH. DES. <i>[Signature]</i>	DATE 3-14-66
			FINAL APPROVAL <i>[Signature]</i> MS4611	
			DATE 3-14-66	
			SHEET	
			REV. LTR.	