

REVISIONS						
ZONE	SYM	DESCRIPTION	DATE	E.M.N. NO.	DRAFT	CHKD
Ø		ORIGINAL RELEASE FOR PRODUCTION	6/11/65	-11	JC	JJM

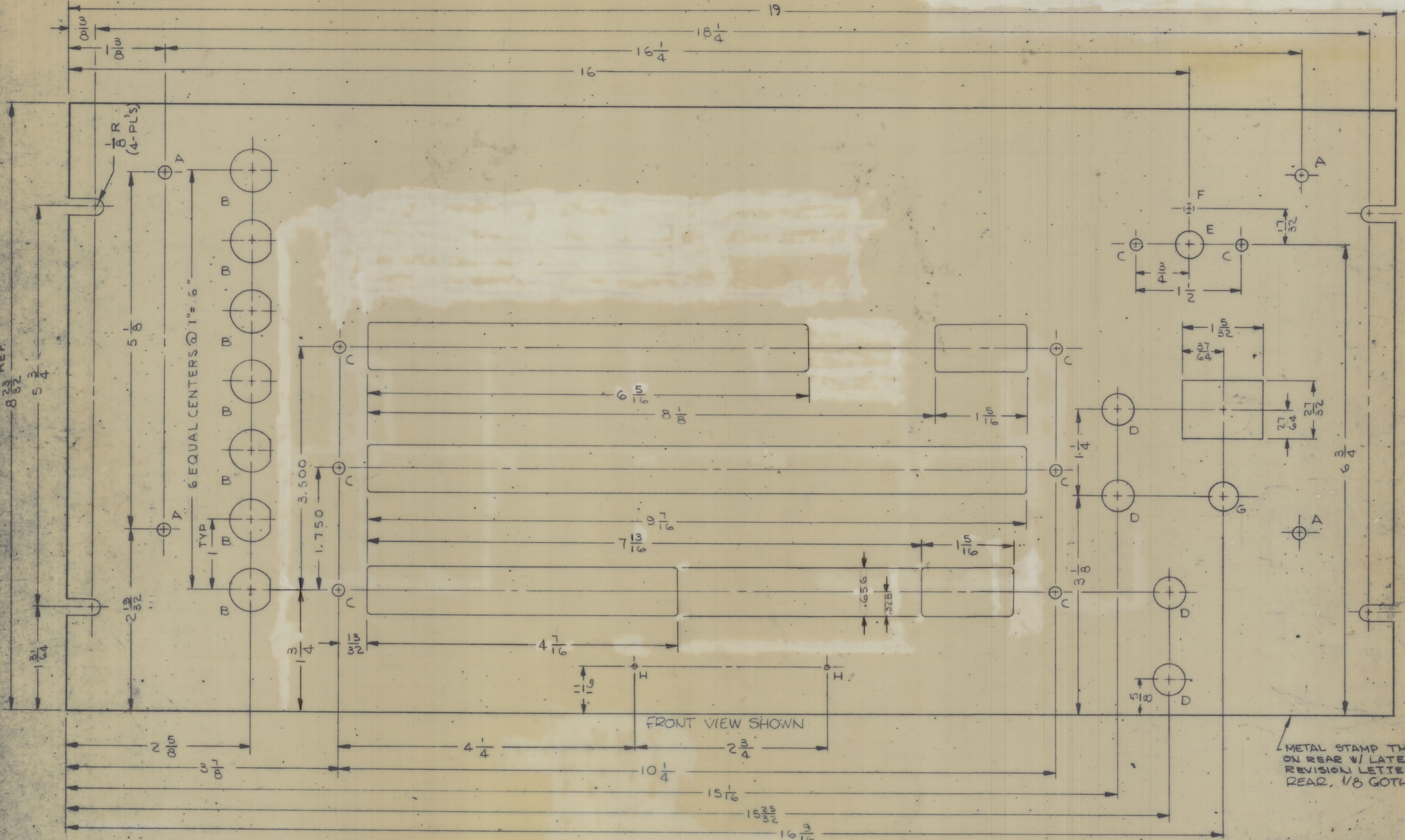

MS4607 Ø

METAL STAMP TMC P/N ON REAR W/ LATEST REVISION LETTER ON REAR, 1/8 GOTHIC.

HOLE LEGEND		
HOLE	DESCRIPTION	REQ'D
A	13/64 DIA	4
B	SEE DETAIL	7
C	3/16 DIA	8
D	15/32 DIA	4
E	13/32 DIA	1
F	5/32 DIA X 1/8 DEEP	1
G	13/32 DIA	1
H	NO. 48 (.0760) DR	2

**MACHINING:**

- MILL ALL EDGES.
- HOLES MUST BE DRILLED, UNLESS OTHERWISE SPECIFIED.
- LATERAL BOW OF PANEL MUST BE KEPT TO .031 TOLERANCE.
- PANEL MUST BE FREE OF ALL MACHINING MARKS, GOUGES AND SCRATCHES. IF NECESSARY, SAND FRONT OF PANEL WITH NO. 120 GRIT SANDPAPER.

**FINISH NOTES:**

- S404 - IRIDITE 14-2 AL-COAT.
- S114 - ZINC CHROMATE PRIMER) FRONT AND
- S115 - SMOOTH GRAY ENAMEL ) EDGES ONLY

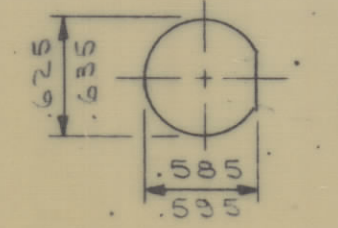

RTPF-1		
Q'TY/UNIT	MODEL USED ON	ASS'Y. NO.
SCALE	CODE	
1:1	A	
THE CONTENTS OF THIS DRAWING ARE THE EXCLUSIVE PROPERTY OF THE TECHNICAL MATERIEL CORP. ITS UNAUTHORIZED USE OR REPRODUCTION IN WHOLE OR IN PART IS STRICTLY FORBIDDEN.		

REF. LD 1916

REQ'D.	ITEM	PART NUMBER	DESCRIPTION	SYMBOL
F. E. EATON LIST OF MATERIAL				
MATERIAL		THE TECHNICAL MATERIEL CORP. MAMARONECK, NEW YORK		
3/16 THK ALUMINUM 2024-T3		PANEL, FRONT		
FINISH		TITLE		
SEE NOTES		PANEL, FRONT		
UNLESS OTHERWISE SPECIFIED DIMENSIONS ARE IN INCHES AND INCLUDE CHEMICALLY APPLIED OR PLATED FINISHES		DRAWN J. LESHINSKI DATE 6/11/65		
DECIMALS .X ± .05 .XX ± .01 .XXX ± .005		CHECKED JCS DATE 6/11/65		
FRACTIONS ± 1/64 ANGLES ± 0° 30'		ELECT. DES. DATE 6/11/65		
TOLERANCES		MECH. DES. W. JORDAN DATE 6/11/65		
		FIRM APPROVAL [Signature] DATE 6/11/65		
		MS4607 Ø		
		SHEET		
		REV. LTR.		

NOTES