

REQ. PER UNIT	USED ON			MS4375 \emptyset
	MODEL	ASS'Y. NO.	DATE	
1	TSTE-10K	AX580	2-4-65	

HOLES	DESCRIPTION	REQ
A	3/16 X 3/8 SLOTS	2
B	.625 \pm .002	1

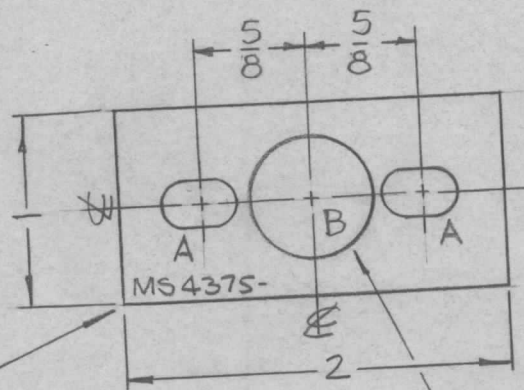

NEED MARK TMC PART NO.
1/8 HIGH GOTHIC W/LATEST
REV. LETTER.

\emptyset	ORIGINAL RELEASE FOR PRODUCTION	5/20/66	\emptyset	CV					1	1	BB126-5	BEARING, RACE		
X1	A SLOTS WERE 1/4 X 3/8 B HOLE DIM. ADDED	5-11-65	X1	SRG	DA						5/32 THICK	F. BUDETTI	DESCRIPTION	SYMBOL
X	EXP. RELEASE	2-4-65	X	SRG							ALUMINUM	THE TECHNICAL MATERIEL CORP. MAMARONECK. NEW YORK		
SYM	DESCRIPTION	DATE	CH. NO.	DRAFTS	CHECKER	ENG. APP.	MATERIAL				2024-T3	SRG		
UNLESS OTHERWISE SPECIFIED DIMENSIONS ARE IN INCHES AND INCLUDE CHEMICALLY APPLIED OR PLATED FINISHES		SCALE		1:1		TYPE & TEMPER		HEAT TREAT. SPEC.	DRAWN	CHECKED	FINAL APPROVAL			
TOLERANCES		CODE		A		S404 YEL. IRIDITE			5/19/66		MS4375 \emptyset			
DECIMALS .X \pm .05 .XX \pm .01 .XXX \pm .005		FRACTIONS \pm 1/64 ANGLES \pm 0° 30'				FINISH & SPEC. NO.		ELEC. DES. APP.	MECH. DES. APP.	REPROVAL NO. 440H 21540				