

REQ. PER UNIT	USED ON			MS4240 Ø
	MODEL	ASS'Y. NO.	DATE	
5	TER-25K		12-21-64	

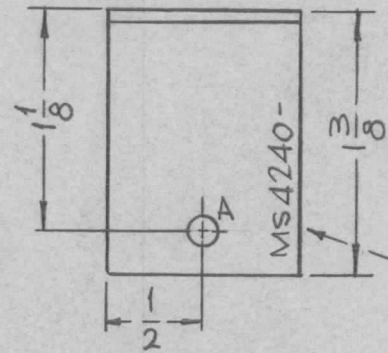

METAL STAMP
TMC PART NO.
1/8 HIGH GOTHIC
W/LATEST REV.
LETTER.

HOLES	DESCRIPTION	REQ.
A	9/64 DIA.	1
B	11/16 DIA.	1

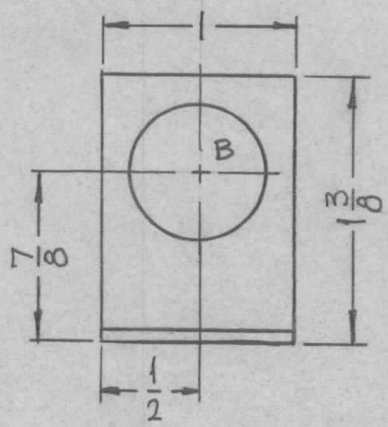

UNLESS OTHERWISE SPECIFIED:

1. USE MATERIAL THICKNESS FOR MAXIMUM RADIUS ON ALL BENDS
2. ALL ANGULAR BENDS 90 DEGREES
3. REMOVE ALL BURRS AND SHARP EDGES

REQ.	ITEM	PART NO.	F. BUDETTI	DESCRIPTION	SYMBOL	
		.064 THICK		THE TECHNICAL MATERIEL CORP. MAMARONECK, NEW YORK		
		STOCK SIZE				
Ø	ORIGINAL RELEASE FOR PRODUCTION	12-21-64	X	SRG	BRACKET, COMPONENT MTG. LAMP	
SYM	DESCRIPTION	DATE	CH. NO.	DRAFTS	CHECKER	ENG. APP.
UNLESS OTHERWISE SPECIFIED DIMENSIONS ARE IN INCHES AND INCLUDE CHEMICALLY APPLIED OR PLATED FINISHES		SCALE	1:1			
DECIMALS .X ± .05 .XX ± .01 .XXX ± .005	TOLERANCES	FRACTIONS ± 1/64 ANGLES ± 0° 30'	CODE	A		
		5052-H32		SRG	<i>[Signature]</i>	<i>[Signature]</i>
		TYPE & TEMPER	HEAT TREAT. SPEC.	DRAWN	CHECKED	FINAL APPROVAL
		5404 YELLOW IRIDITE			<i>[Signature]</i>	
		FINISH & SPEC. NO.	ELEC. DES. APP.	MECH. DES. APP.	MS4240 Ø	