

① MOUNT IN ALL B HOLES.

REVISIONS						
SYM	DESCRIPTION	DATE	E.M.N. NO.	DRAFT	CHKD	APPD
Ø	ORIGINAL RELEASE FOR PRODUCTION	12/21/65	Ø			JTD

MS4211

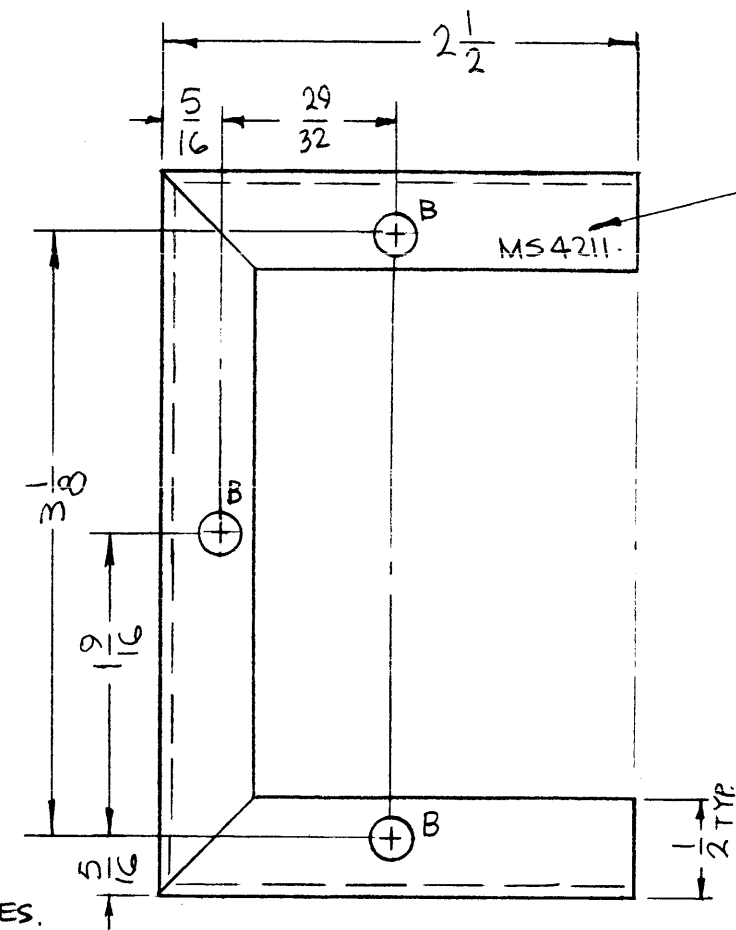

METAL STAMP TMC P/N 1/8 HIGH GOTHIC W/LATEST REV. LETTER.

HOLES	DESCRIPTION	REQ.
A	13/64 DIA.	7
B	.221-.224 DIA.	3
C	17/32 DIA.	2

- UNLESS OTHERWISE SPECIFIED:
1. USE MATERIAL THICKNESS FOR MAXIMUM RADIUS ON ALL BENDS
 2. ALL ANGULAR BENDS 90 DEGREES
 3. REMOVE ALL BURRS AND SHARP EDGES
 4. MOUNT INSERTS AFTER FINISHING

NOTES

1	GPT-10KLF	
Q'TY./UNIT	MODEL USED ON	ASS'Y. NO.
SCALE 1:1	CODE A	

THE CONTENTS OF THIS DRAWING ARE THE EXCLUSIVE PROPERTY OF THE TECHNICAL MATERIEL CORP. ITS UNAUTHORIZED USE OR REPRODUCTION IN WHOLE OR IN PART IS STRICTLY FORBIDDEN.

3	1	NT129-832-4	NUT, PLAIN, SPLINE	B
REQ'D.	ITEM	PART NUMBER	DESCRIPTION	SYMBOL

MATERIAL		THE TECHNICAL MATERIEL CORP.	
.064 THICK ALUMINUM 5052-H32		MAMARONECK, NEW YORK	
FINISH		TITLE	
S404 YEL. IRIDITE		BRACKET, MTG. ALDC	
UNLESS OTHERWISE SPECIFIED DIMENSIONS ARE IN INCHES AND INCLUDE CHEMICALLY APPLIED OR PLATED FINISHES		DRAWN	DATE
		11-4-65	11-4-65
		CHECKED	DATE
		12/20/65	12/20/65
		ELECT. DES.	DATE
		MECH. DR.	DATE
		ML	12/27/65

DECIMALS	FRACTIONS
.X ± .05	± 1/64
.XX ± .01	ANGLES ± 0° 30'
.XXX ± .005	

MS4211